

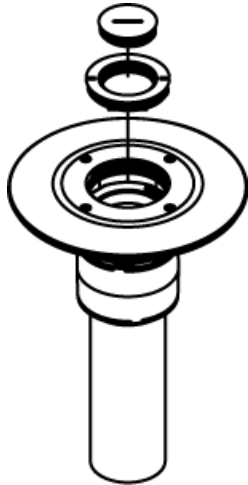

Wiremold  
RC9AM2TC Furniture-Feed Poke-Thru Assembly, Black  
Part No. RC9AM2TCBK



Complete with combination 1 1/4inch and 2inch trade size threaded conduit openings and closure plugs. Must be used with a conduit connector (not included) at the adapter assembly plate to maintain fire classification. Finish flange/cover assembly available in gray (GY), black (BK), and brushed aluminum (AL). NOTE: Assembled with scrub water gasket. For use on tile or carpet floors. RC9AM2TC Series Poke-Thru Devices require a 3inch (76mm) diameter hole. Not designed to work with bare concrete or terrazzo. Floor covering thickness 1/8inch minimum.

## Features & Benefits

Complete with combination 1 1/4inch and 2inch trade size threaded conduit openings and closure plugs. Must be used with a conduit connector (not included) at the adapter assembly plate to maintain fire classification. Finish flange/cover assembly available in gray (GY), black (BK), and brushed aluminum (AL). NOTE: Assembled with scrub water gasket. For use on tile or carpet floors. RC9AM2TC Series Poke-Thru Devices require a 3inch (76mm) diameter hole. Not designed to work with bare concrete or terrazzo. Floor covering thickness 1/8inch minimum.

## Specifications

### General Info

Product Line	Wiremold	Color	Black
UPC Number	786564004899	Country Of Origin	Mexico
Application Sector	Commercial	Standard	cULus Listed Metallic Outlet Boxes: File E2961 Guide QCIT, cULus Listed Nonmetallic Outlet Boxes & Fittings Classified for Fire Resistance: File R8209 Guide CEYY Meets Article 300.21 300.22[C] &314 of NEC
Type	Poke-Thru		

### Dimensions

Product Width US	7.0 in	Product Weight US	3.31 lb
Product Volume US	502.25 cu in	Product Depth US	10.25 in
Product Height US	7.0 in	Core Hole Size	3 in

---

### Listing Agencies / 3rd Party Agencies

---

cULus ListingNumber	E2961	cULus Listed	Yes
---------------------	-------	--------------	-----

---

### Buy American Act Compliance

---

NAFTA	Yes
-------	-----

---

### Additional Information

---

RoHS Conformant	Yes
-----------------	-----

---

### Technical Information

---

Cable Entry	Conduit Stub	Number of Outlets	0
-------------	--------------	-------------------	---

---