

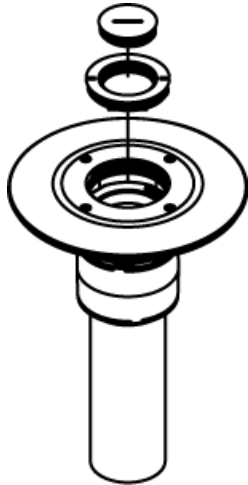

Wiremold
RC9AM2TC Assembled Furniture-Feed Poke-Thru Device
Part No. RC9AM2TCAL



Complete with combination 1 1/4" and 2" trade size threaded conduit openings and closure plugs. Must be used with a conduit connector (not included) at the adapter assembly plate to maintain fire classification. Finish flange/cover assembly available in gray (GY), black (BK), and brushed aluminum (AL). NOTE: Assembled with scrub water gasket. For use on tile or carpet floors. RC9AM2TC Series Poke-Thru Devices require a 3" (76mm) diameter hole. Not designed to work with bare concrete or terrazzo. Floor covering thickness 1/8" minimum.

Features & Benefits

Complete with combination 1 1/4" and 2" trade size threaded conduit openings and closure plugs. Must be used with a conduit connector (not included) at the adapter assembly plate to maintain fire classification. Finish flange/cover assembly available in gray (GY), black (BK), and brushed aluminum (AL). NOTE: Assembled with scrub water gasket. For use on tile or carpet floors. RC9AM2TC Series Poke-Thru Devices require a 3" (76mm) diameter hole. Not designed to work with bare concrete or terrazzo. Floor covering thickness 1/8" minimum.

Specifications

General Info

Product Line	Wiremold	UPC Number	786564004875
Country Of Origin	Mexico	Construction	Assembled
Number of Knockouts	1	Application Sector	Commercial
Standard	cULus Listed Metallic Outlet Boxes: File E2961 Guide QCIT, cULus Listed Nonmetallic Outlet Boxes & Fittings Classified for Fire Resistance: File R8209 Guide CEYY Meets Article 300.21 300.22[C] & 314 of NEC	Type	Poke-Thru

Dimensions

Product Width US	7.0 in	Product Height US	10.0 in
------------------	--------	-------------------	---------

Listing Agencies / 3rd Party Agencies

cULus ListingNumber	E2961	cULus Listed	Yes
---------------------	-------	--------------	-----

Buy American Act Compliance

NAFTA Yes

Additional Information

RoHS Conformant Yes

Technical Information

Cable Entry CONDUIT
