

## Wiremold

### REVIT CONTENT GUIDE

<b>Manufacturer:</b>	Legrand   Wiremold
<b>File:</b>	Afterset-Walkercell-Wiremold.rfa
<b>Type Catalog:</b>	Not Applicable
<b>Rendering file:</b>	Not Applicable
<b>Schedule file:</b>	Schedule - Walkercell.rvt

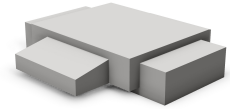

### Instance Properties

<b>Dimension</b>	
Availability	Available
Desired Height	1.500
Height	1.500
<b>Graphics</b>	
Has Snap Locations	<input checked="" type="checkbox"/>
<b>Identity Data</b>	
Equipment Number	
Part Description	Walkercell Afterset, 1.5 In. Height
Part Number	PK150

### Type Properties

The family contains the following 1 types:  
Standard (Values for this type are shown below)

<b>Dimension</b>	
Depth	9.625
Width	9.313
<b>Identity Data</b>	
Copyright	Copyright © Legrand   Wiremold
Date Last Modified	March 15, 2013
Description	See Part Description
Equipment Abbreviation	WC
Family Version	1.0.0
Manufacturer	Legrand   Wiremold
Model	See Part Number
Model Disclaimer	For More Information, Contact Legrand   Wiremold
Original Creation Date	March 15, 2013
Product Documentation Link	<a href="http://www.legrand.us/~ /media/028DDC19E7AD40868F14DEB257230B6E.ashx">http://www.legrand.us/~ /media/028DDC19E7AD40868F14DEB257230B6E.ashx</a>
Product Page URL	<a href="http://www.legrand.us/wiremold/infloor-ducts/ducts/walkercell-cellular-raceway.aspx#UZwCx8qO424">http://www.legrand.us/wiremold/infloor-ducts/ducts/walkercell-cellular-raceway.aspx#UZwCx8qO424</a>
Provide Feedback	<a href="https://www.surveymonkey.com/s/BDXT5XT">https://www.surveymonkey.com/s/BDXT5XT</a>
URL	<a href="http://www.legrand.us/wiremold.aspx">http://www.legrand.us/wiremold.aspx</a>
<b>Materials</b>	
Product Material	Steel - Wiremold

Half-tone text in the property tables indicates that the value is locked from editing.

## Loading and Placing into the Project:

One “Electrical Fixtures” family is supplied and can be loaded into a Revit project through all traditional methods. The Afterset requires a face to be placed within the project (i.e. duct). Also, ensure that the visibility settings within the project are modified to have the Electrical Fixtures category visible.

## Project Behavior:

Within the type and instance properties dialogues, the user will find useful information for scheduling purposes such as Height, Width, Depth and other unique properties of the model. In “Identity Data” the user will find information specific to Legrand | Wiremold and the model, i.e.: family revision information, Legrand | Wiremold copyright information, part description, product URL and other specific data. \*See scheduling description below.

The model is placed on top of a duct by snapping to its center. The Height (or the depth of concrete over the duct) will affect how far into the ground the afterset will sit. The afterset comes in a set of standard heights, but can also be extended with the use of extensions, which is already built into the family. Which extensions are being used and how many will be quantified in the duct schedule.

## Instance Parameters:

In the “Instance Parameters”, the user has the following options to modify:

- Equipment Number – For tagging each placed instance.
- Has Snap Locations – Toggles the visibility of the snap location crosshairs.
- Desired Height – For inputting the desired height for the afterset.

## Type Parameters:

Each type represents a manufactured product. Therefore, the type parameters should not be modified by the user for standard configuration. Please note:

- Product Documentation Link – Directs a webpage to the products online listing.
- Equipment Abbreviation – For filtering schedules. \*See scheduling description below.

## Visibility:

For best performance, all model geometry is turned off in Plan View and represented through masking regions and symbolic/model lines that update automatically when a user changes types. For most families the viewing range will have to be lowered since no geometry is visible above the reference level.

## Rendering:

When the family file is loaded into the project, standard Legrand | Wiremold materials are imported. These may be modified, though ensure that the modification selection matches an actual manufacturer supplied option.

## Schedule Creation:

LeGrand | Wiremold products may be scheduled utilizing the schedule view in the given project file. Select and copy (Ctrl-C) the schedule from the sheet view and paste it (Ctrl-V) into a sheet in your project. The schedule filters are set to look for only those units designated with Manufacturer as “LeGrand | Wiremold” and Equipment Abbreviation as “WC”. The schedules contain special functionality for displaying the configured order numbers of the different selected types.