

ROOFTOP SUPPORT SYSTEMS

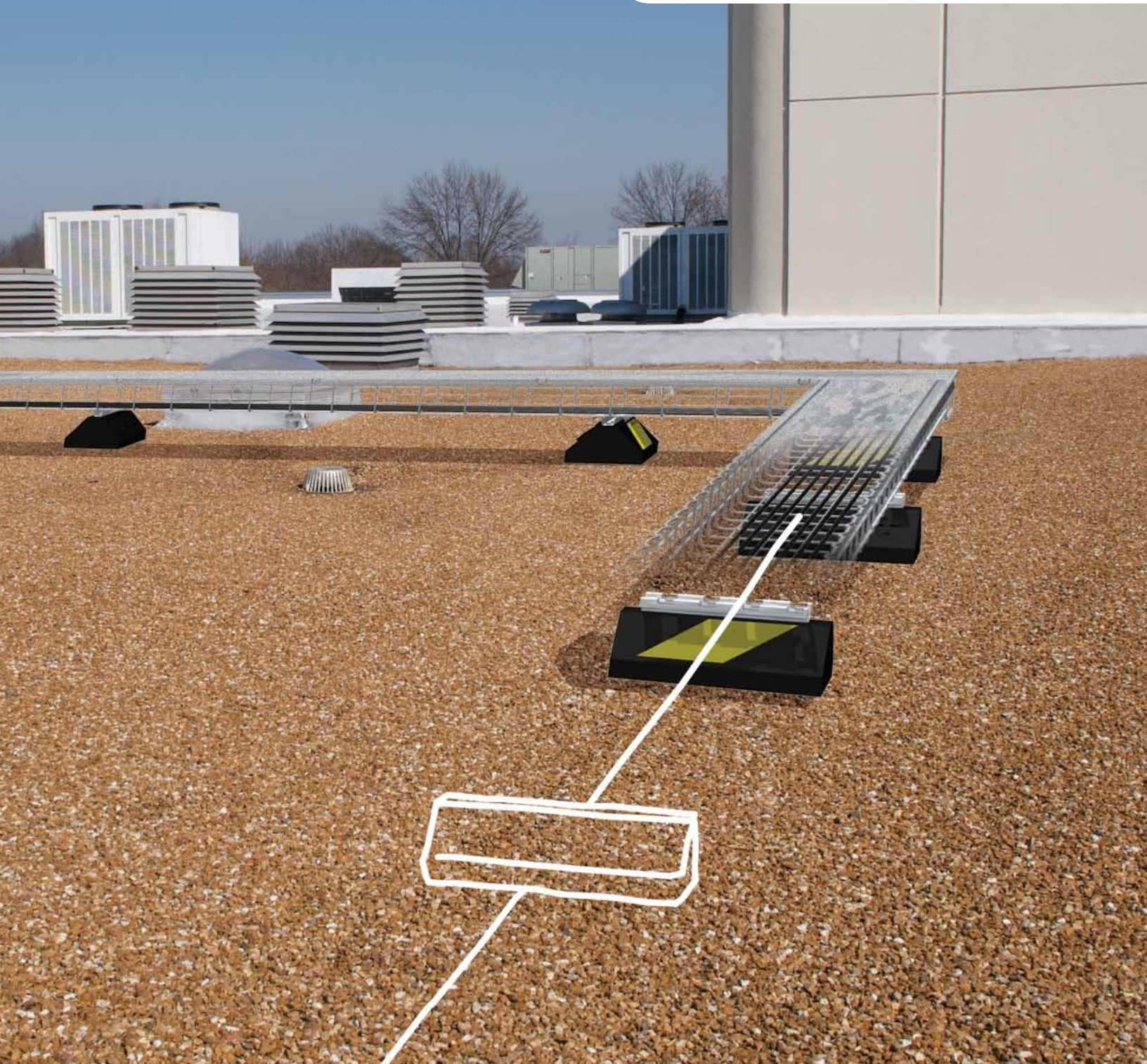

 **legrand**[®]

Cablofil

designed to be better.

Cablo-Port

is the innovative solution
for rooftop equipment support.

Poorly supported HVAC equipment, pipes and cable pathways can cause major problems to your roof. Penetrations, vibration and wind can slowly create leaks that can lead to unseen structural problems and costly repairs.

Cablo-Port is a UV and Weather resistant rubber base that creates a cushion between rooftop mounted equipment and sensitive roofing materials. Available in two styles, the Standard style is perfect for smaller loads and tight spaces and the Widebody design provides a broad base to minimize roof pressure and a larger area for glue application. **Cablo-Port** is also available with a wide variety of pre-mounted support options, including FAS P and Channel.

Specify Cablo-Port for your next roof top project!

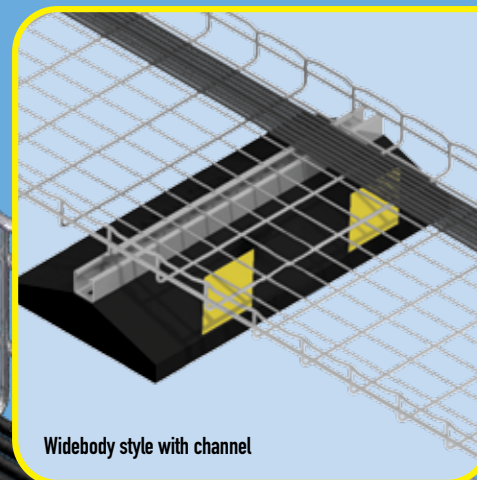

Standard Curb style with FAS P

■ **Non Penetrating Weather Resistant Bases**

- 100% recycled rubber bases will not deteriorate over time
- UV resistant rubber supports up to 1000lb/ft
- Composite material accepts screws or other mechanical fasteners
- Choice of two base styles – Standard or Widebody

■ **Pre-installed Supports**

- Multiple support options designed to speed installation
- Slotted Channel supports ladder tray, wire mesh tray and tubing
- Metal supports are available in three finishes:
 - Pre-galvanized (PG) – Standard
 - Hot-Dipped Galvanized (GC) – Optional
 - 304L Stainless Steel (S4) – Optional

■ **Wide Variety of Support Options**

- Height Adjustable – Bridges rooftop gaps, structures or other utility pathways
- Angled – Adapts to any roof pitch
- Multiple Level – For stacking cable pathways

■ **Extends Life of Roof**

- Rubber bases cushions heavy metal supports
- Standard or Widebody styles reduce pressure points on sensitive roofing materials
- Dampens Vibrations

■ **Improves Safety**

- **Reflective Safety Strip** keeps cable pathways visible on dark roofs and in low light conditions

■ **Green Buildings**

- 100% recycled rubber construction assists with building qualification for LEED credits

■ **Fast Shipment**

- Most assemblies ship in 1-3 days ARO



A clean and orderly rooftop installation can enhance building value.



Cablo-Port is made from 100% recycled rubber and assists with building qualification for LEED credits.

Base Only

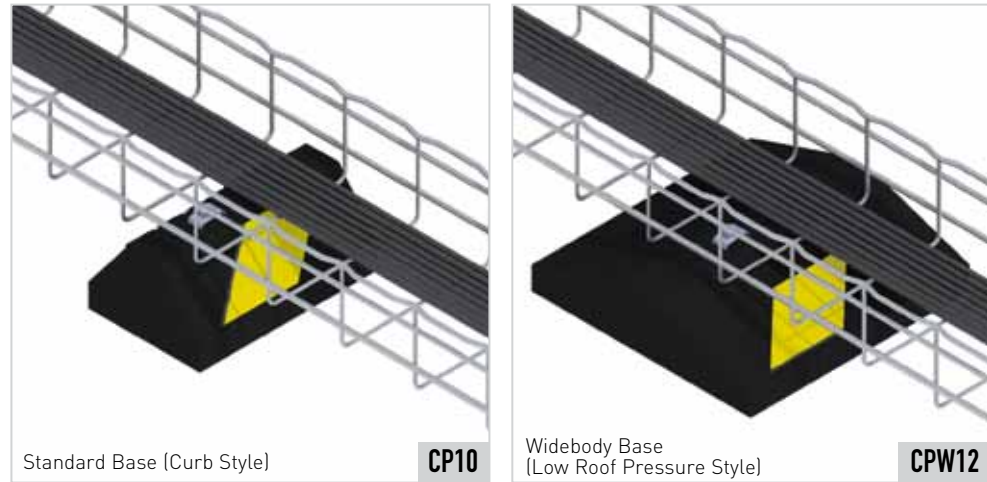

- Cable pathway or other products mounted to base with clamps and screws.
- Install on any roofing material or other flat surface.
- Curb style maximum load 500 lbs. (CP5 - maximum load 150 lbs.).
- Widebody design has 1,000 lbs/ft maximum load and provides 5 times the surface to minimize roof material pressure, increase load capacity and provide over 120 square in/ft for glue application.
- Composite material allows through bolts or lag type screws (through bolts recommended)

PRODUCT NO.	SUPPORT	HEIGHT	WIDTH	BASE LENGTH	WEIGHT	RBR
CP5	NONE	4"	6"	5"	2.6	943523
CP10		4"	6"	9.6"	4.6	943524
CP20		4"	6"	22"	10.5	943525
CP30		4"	6"	28.8"	16.0	943526
CPW12		3"	12"	12"	9.5	943714
CPW24		3"	12"	24"	14.2	943715
CPW36	3"	12"	36"	18.9	943716	

Base with FAS P or Strut Support

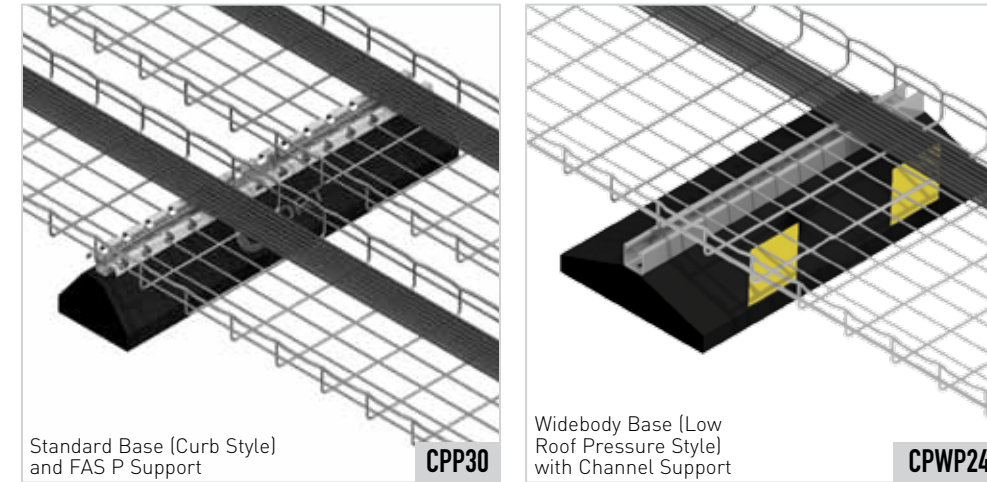

- For support of tray, piping or other items on flat roofs.
- Two support styles: FAS Profile for wire mesh trays or 13/16" galvanized channel (14 ga.) for ladder tray, piping or other material support.
- Install on any roofing material or other flat surface.
- Supports are available in one standard finish and two optional finishes.
- Curb style maximum load 750 lbs. (CPP5 and CPS5 - maximum load 200 lbs.).
- Two rubber base designs: Standard Curb and Widebody style
- Widebody design has 1,000 lbs/ft maximum load and provides 5 times the surface area to minimize roof material pressure, increase load capacity and provide over 120 square in/ft for glue application.

PRODUCT NUMBER	SUPPORT	HEIGHT	SUPPORT LENGTH	BASE LENGTH	WEIGHT	FINISHES		
						STANDARD FINISH	OPTIONAL FINISHES	
						PG	S4	GC
CPP5	FAS P	5"	6"	5"	3.0	943529	943541	943553
CPP10		5"	12"	9.6"	5.0	943530	943542	943554
CPP20		5"	24"	22"	11.0	943531	943543	943555
CPP30		5"	30"	28.8"	16.1	943532	943544	943556
CPS5	STRUT	4 7/8"	6"	5"	-	-	-	-
CPS10		4 7/8"	10"	9.6"	5.3	943535	943547	943559
CPS20		4 7/8"	22"	22"	11.2	943537	943549	943561
CPS30		4 7/8"	28"	28.8"	16.3	943538	943550	943562
CPWP12	FAS P	4"	12"	12"	9.8	943720	943726	943732
CPWP24		4"	23-5/8"	24"	14.6	943721	943727	943733
CPWP36		4"	36"	36"	19.3	-	-	-
CPWS12	STRUT	3 3/4"	12"	12"	10.0	943738	943744	943750
CPWS24		3 3/4"	24"	24"	14.7	943739	943745	943751
CPWS36		3 3/4"	36"	36"	19.5	943740	943746	943752

*Call for Weight Information.

Extension Series with FAS P or Channel Support



Shown with CFEP (Cablofil Extension Plate) increases load capacity to 500 lbs.

CPPE-88



CPWEPE12

- Height adjustable.
- For support of cable pathways with varying heights .
- Base includes two (2) 1/2" Electrozinc threaded rod risers and FAS Profile or channel.
- Install on any roofing material .
- Supports are available in three finishes.
- Standard series maximum load 150 lbs.
- Widebody design has maximum load of 500 lbs.
- Provides 5 times the surface area to minimize roof material pressure, increase load capacity and provide over 120 square in/ft for glue application.

PRODUCT NUMBER	SUPPORT	HEIGHT	SUPPORT LENGTH	BASE LENGTH	WEIGHT	STANDARD FINISH			
						PG	S4	GC	
CPPE10-88	FAS P	8"	8"	9.6"	6.2	943565	943577	943589	
CPPE20-818		8"	18"	22"	13.4	943567	943579	943591	
CPPE20-824		8"	24"	22"	13.6	943568	943580	943592	
CPPE10-128		12"	8"	9.6"	6.5	943569	943581	943593	
CPPE20-1218		12"	18"	22"	13.9	943571	943583	943595	
CPPE20-1224		12"	24"	22"	14.5	943572	943584	943596	
CPSE10-810	STRUT	8"	10"	9.6"	6.2	943601	943613	943625	
CPSE20-822		8"	22"	22"	13.7	943603	943615	943627	
CPSE30-828		8"	28"	22"	19.4	943604	943616	943628	
CPSE10-1210		12"	10"	9.6"	6.5	943605	943617	943629	
CPSE20-1222		12"	22"	22"	14.2	943607	943619	943631	
CPSE30-1228		12"	28"	22"	19.6	943608	943620	943632	
CPWEPE12-128		FAS P	12"	8"	12"	10.4	943756	943768	943589
CPWEPE12-1212			12"	12"	12"	10.6	943757	943769	943590
CPWEPE24-1218	12"		18"	24"	17.5	943758	943770	943591	
CPWEPE24-1224	12"		24"	24"	17.8	943759	943771	943592	
CPWSE12-1210	STRUT	12"	10"	12"	10.5	943768	943772	943776	
CPWSE12-1216		12"	16"	12"	10.7	943769	943773	943777	
CPWSE24-1222		12"	22"	24"	17.8	943770	943774	943778	
CPWSE24-1228		12"	24"	24"	18.2	943771	943775	943779	

Elevated Bridge Series with Channel Support

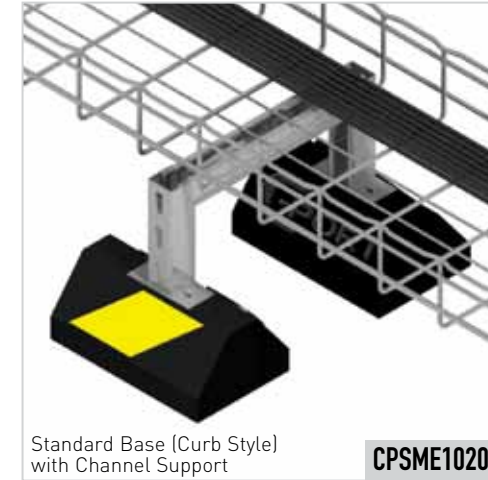

Standard Base (Curb Style) with Channel Support

CPSME1020

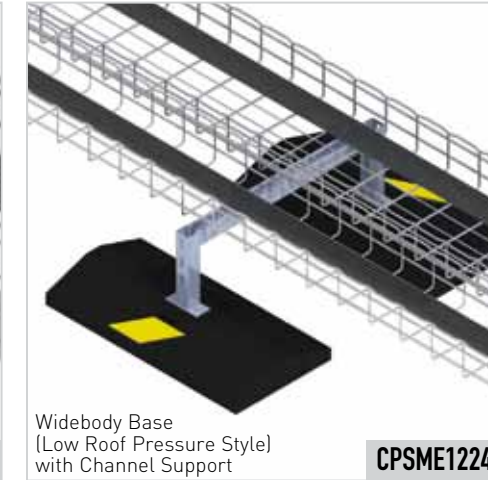

Widebody Base (Low Roof Pressure Style) with Channel Support

CPSME1224

- Ideal for mounting medium load elevated cable pathways.
- Base includes two channel risers and channel crossbar.
- Install on any roofing material or other flat surfaces.
- Support is available in three finishes.
- Channel can be used to support wire mesh cable tray (secure with FS41 (SS) Spring Clips).
- Standard series maximum load 150/500 lbs.
- Widebody design has 1,000 lbs/ft maximum load and provides 5 times the surface area to minimize roof material pressure, increase load capacity and provide over 120 square in/ft for glue application.

PRODUCT NUMBER	SUPPORT	HEIGHT	SUPPORT LENGTH	BASE LENGTH	WEIGHT	STANDARD FINISH		
						PG	S4	GC
CPSME1020	STRUT	10"	20"	10"	14.2	943669	943673	943677
CPSME1030		10"	30"	10"	15.6	943671	943675	943679
CPSME1620		16"	20"	22"	45.0	943670	943674	943678
CPSME1630		16"	30"	22"	45.5	943672	943676	943680
CPWSME1224		12"	24"	12"	23.2	943813	943817	943821
CPWSME1236		12"	36"	12"	58.2	943815	943819	943823
CPWSME2424		24"	24"	24"	25.7	943814	943818	943822
CPWSME2436		24"	36"	24"	60.4	943816	943820	943824

Bridge Series with FAS P or Channel Support



Standard Base (Curb Style) with Channel Support

CPSB10-28

- Designed as sleeper for HVAC units, cable pathways, roof walkways or other applications.
- Two (2) bases bridged with 1 5/8" galvanized channel (12 ga.) or FAS P.
- Install on any roofing material or other flat surfaces.
- Supports are available in three finishes.
- Channel can be used to support wire mesh cable tray (secure with FS41 Spring Clips).
- Standard series maximum load 500 lbs.
- Widebody design has 1,000 lbs/ft maximum load and provides 5 times the surface area to minimize roof material pressure, increase load capacity and provide over 120 square in/ft for glue application.

PRODUCT NUMBER	SUPPORT	HEIGHT	SUPPORT LENGTH	BASE LENGTH	WEIGHT	STANDARD FINISH		
						PG	S4	GC
CPPB10-28	FAS P	5"	28"	9.6"	13.4	943637	943647	943657
CPSB10-28	STRUT	5 5/8"	28"	9.6"	13.6	943642	943652	943662
CPSB10-36		5 5/8"	36"	9.6"	14.9	943643	943653	943663
CPSB10-42		5 5/8"	42"	9.6"	-	-	-	-
CPWPB12-28	FAS P	5"	28"	12"	22.2	-	-	-
CPWSB12-28	STRUT	5 5/8"	28"	12"	22.5	-	-	-
CPWSB12-36		5 5/8"	36"	12"	23.6	-	-	-
CPWSB12-42		5 5/8"	42"	12"	-	-	-	-

Vari -Angle Series with Channel Support



Standard Base (Curb Style) with Channel Support

CPSA20PG

- Designed to adapt to any roof pitch or uneven surface.
- Install on any roofing material.
- Easily adjusted onsite.
- Leg adaptor will accommodate 1 5/8" x 1 5/8" channel framing.
- U-shaped 1 7/8" x 1 7/8" leg adaptor predrilled with 9/16" mounting holes is pre-mounted to base.
- Maximum load 500 lbs.

PRODUCT NO.	SUPPORT	BASE HEIGHT	BASE WIDTH	BASE LENGTH	WEIGHT	PG
CPSA10PG	STRUT	5 5/8"	6"	9.6"	8.0	943667
CPSA20PG		5 5/8"	6"	22"	15.1	943668

Vertical 1 5/8" x 1 5/8" strut and horizontal crossbar not provided.

Widebody Base with Membrane

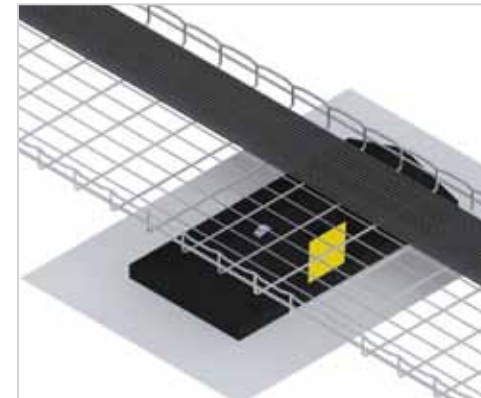

Widebody Base (Low roof pressure Style) with Membrane

CPW6T24

- For rooftop support of cable pathways or other products mounted to base with clamps or screws.
- Cable pathway is mounted to base with clamps and screws.
- Adhere membrane to TPO or PVC roofing material to reduce wind lift.
- Widebody design has no maximum load and provides 5 times the surface area on the roof to minimize roof material pressure, increase load capacity and provide over 120 square in/ft for glue application.

PRODUCT NO.	MEMBRANE MTRL	SUPPORT	HEIGHT	WIDTH	BASE LENGTH	WEIGHT	RBR
CPWGT12	TPO	NONE	3"	12"	12"	9.8	943977
CPWGT24			3"	12"	24"	14.5	943978
CPWGT36			3"	12"	36"	19.4	943979
CPWGP12	PVC	NONE	3"	12"	12"	9.8	943989
CPWGP24			3"	12"	24"	14.5	943990
CPWGP36			3"	12"	36"	19.4	943991

Widebody Base with Membrane and FAS P or Channel Support

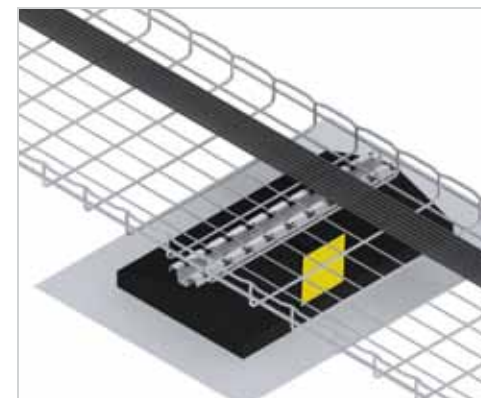

Widebody Base (Low roof pressure Style) with Membrane and FAS P Support

CPWGT24

- For rooftop support of cable pathways.
- Base includes FAS Profile or 13/16" galvanized channel (14 ga.).
- Adhere membrane to TPO or PVC roofing material to reduce wind lift.
- Supports are available in three finishes.
- Widebody design has no maximum load and provides 5 times the surface area on the roof to minimize roof material pressure, increase load capacity and provide over 120 square in/ft for glue application.

PRODUCT NO.	MEMBRANE MTRL	SUPPORT	O/A HEIGHT	SUPPORT LENGTH	BASE LENGTH	WEIGHT	STANDARD FINISH		
							PG	S4	GC
CPWGT12	TPO	FAS P	4"	12"	12"	10.2	944001	944007	944013
CPWGT24			4"	23-5/8"	24"	14.4	944002	944008	944014
CPWGT36			4"	38-1/2"	36"	19.6	944003	944009	944015
CPWGP12	PVC	FAS P	4"	12"	12"	10.2	944037	944043	944049
CPWGP24			4"	23-5/8"	24"	14.9	944038	944044	944050
CPWGP36			4"	38-1/2"	36"	19.6	944039	944045	944051
CPWGT12	TPO	STRUT	3 3/4"	12"	12"	10.3	944073	944079	944085
CPWGT24			3 3/4"	24"	24"	15.0	944074	944080	944086
CPWGT36			3 3/4"	36"	36"	19.6	944075	944081	944087
CPWGPS12	PVC	STRUT	3 3/4"	12"	12"	10.3	944109	944115	944121
CPWGPS24			3 3/4"	24"	24"	15.0	944110	944116	944122
CPWGPS36			3 3/4"	36"	36"	19.6	944111	944117	944123

Seismic Series

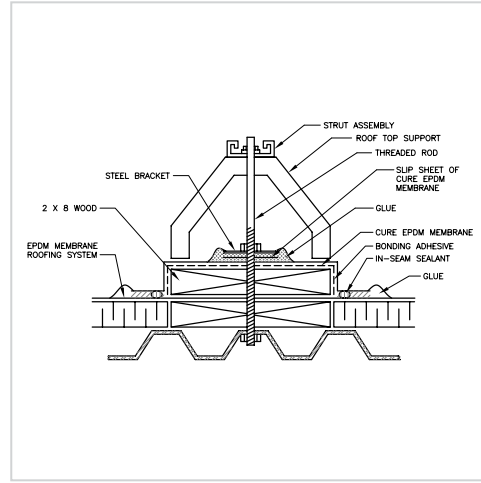

Standard Seismic Base (Curb Style) with FAS P Support

CPPZ10

- Base includes FAS Profile or 13/16" galvanized channel (14 ga.).
- Designed for support of cable pathways and other rooftop equipment subject to seismic codes.
- This base includes a bolt that penetrates the roofing membrane and fastens to the underlining structure.
- Install on any roofing material or other flat surface.
- This product is approved by Carlisle SynTec Inc.
- Maximum load 750 lbs.

PRODUCT NO.	SUPPORT	O/A HEIGHT	BRKT WIDTH	BASE LENGTH	WEIGHT	STANDARD FINISH	OPTIONAL FINISHES	
						PG	S4	GC
CPPZ10	FAS P	5"	12"	9.6"	5.8	943681	943691	943701
CPPZ20		5"	24"	22"	11.7	943682	943692	943702
CPPZ30		5"	30"	28.8"	16.8	943683	943693	943703
CPSZ10	STRUT	4 7/8"	12"	9.6"	5.9	943686	943696	943706
CPSZ20		4 7/8"	24"	22"	11.8	943687	943697	943707
CPSZ30		4 7/8"	30"	28.8"	16.9	943688	943698	943708

designed to be better.



Cablofil

www.legrand.us/cablofil

Phone 800-658-4641

618-566-3230

Fax 618-566-3250

8319 State Route 4

Mascoutah, IL 62258 USA