

## 60VO Vertical Outside 60° Elbow

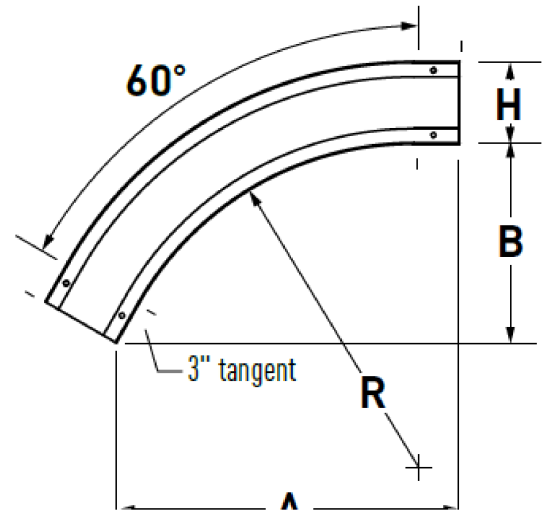
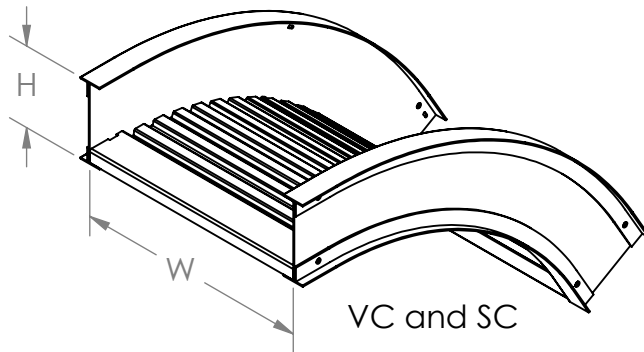
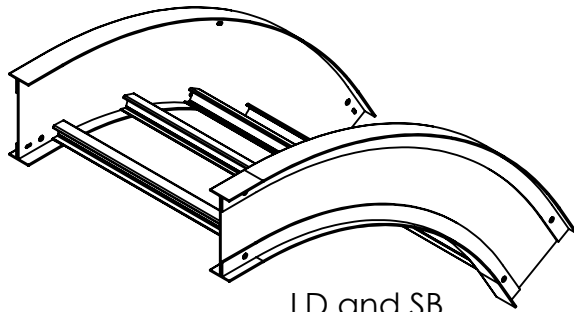

ITRAY VERTICAL INSIDE ELBOW CATALOG NUMBERING EXAMPLE:					
BOTTOM TYPE	LD - 6	A	60VO	12	06
VENTED					
LD - Ladder Rung					
VC - Vented Corrugated					
NON-VENTED					
SC - Solid Corrugated					
SB - Solid Bottom					
	RAIL HEIGHT	MATERIAL	FITTING CODE	RADIUS	WIDTH
	4 - 4"	A		12 - 12"	06 - 6"
	5 - 5"			24 - 24"	09 - 9"
	6 - 6"			36 - 36"	12 - 12"
	7 - 7"				18 - 18"
					24 - 24"
					30 - 30"
					36 - 36"

Radius R	Rail Height H	A	B
12	4-7	15	8 5/8
24		25 1/4	14 5/8
36		35 5/8	20 5/8

- **Material:** Aluminum Alloy 6063 and 5052
- **Finish:** Plain
- **Bottom:** LD: 1" wide rung  
SB: Flat sheet over Rung  
SC: Solid Corrugated  
VC: Vented Corrugated
- **Construction:** Welded
- **Tray Design:** Tray construction and markings are per the latest edition of NEMA Standards Publication VE1, CSA C22.2 No. 126
- **Connectors:** All fittings are supplied with necessary connectors and fasteners
- **Fitting heights (H):** 4", 5", 6", 7"