

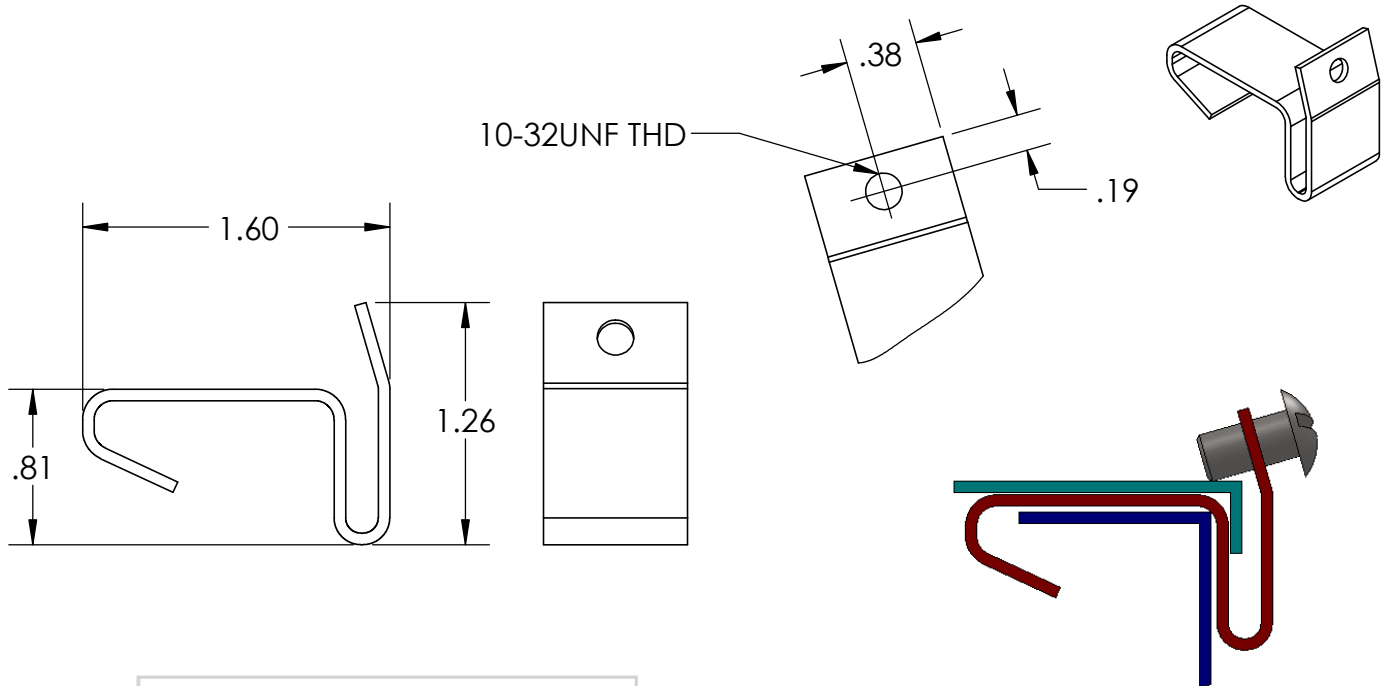

PW Ladder Cable Tray Cover Accessories

1410 Series Flange In Cover Clip



QUANTITY OF COVER CLAMPS REQUIRED	
STRAIGHT SECTION – 5' & 6'	4
STRAIGHT SECTION – 10' & 12'	6
HORIZONTAL ELBOWS	4
TEES	6
CROSSES	8

SIDE VIEW SHOWN
FOR CLARITY

Material: 316 Stainless Steel
Finish: None

Furnished with (1) 10-32UNF X 3/4
Round Head Screw

Fastener Option: Stainless Steel (S6)

"Copyright LNA, Inc. Drawings are proprietary
and may not be copied or otherwise duplicated
or used without express written permission."

CABCS1172

- For use with indoor, horizontal covers
- Clip is compatible with series 1 tray systems that have 1" side rail flanges
- Sold individually

DESCRIPTION	PRODUCT NUMBER	FASTENER INCLUDED
FLANGE-IN	1410	S6
CATALOG NUMBERING EXAMPLE (EA):		
Material	Fasteners	
T - 1410 - S6		

Legrand
8319 State Rt. 4
Mascoutah, IL 62258 USA
800-658-4641
618-566-3250
Fax 618-566-4978
www.legrand.us/cablofil