

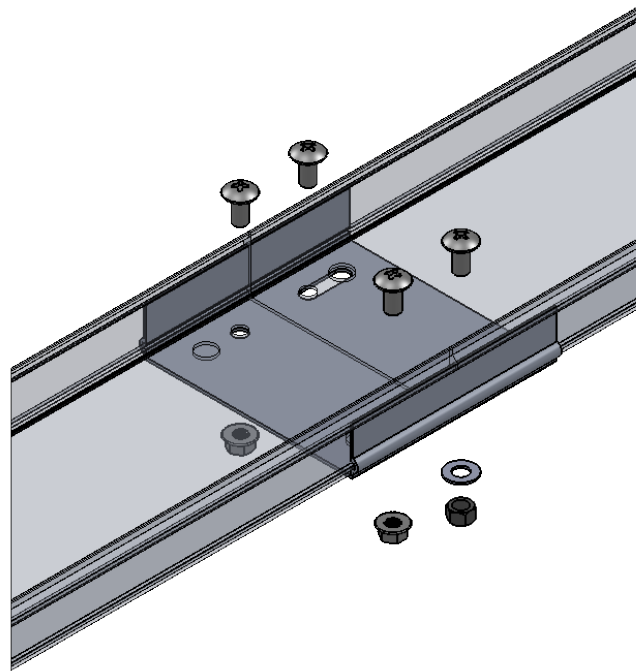

CHANNEL SYSTEM Channel Tray

CCxAEXSP-xx

Aluminum Expansion Splice Plate



CC6AEXSP SHOWN WITH BOLTS/NUTS/WASHERS

PART NAME	'W'
CC4AEXSP-x	4.000
CC6AEXSP-x	6.000

MATERIAL: A- ALUMINUM

x REPRESENTS HARDWARE: GE OR S6

Installation:

- Screw heads should be on the inside and nuts on the outside of the cable channel.
- Flanged hex nuts should be used in round holes. Tighten flanged hex nuts to 17-23 ft-lbs.
- Locking hex nuts and flat washers should be used in slotted holes. Tighten locking hex nuts fully, then back off 1/2 turn.
- Refer to NEMA VE-2 to determine gap setting and expansion joint spacing.
- Install bonding jumpers across expansion connectors on both sides of tray.

"Copyright LNA, Inc. Drawings are proprietary and may not be copied or otherwise duplicated or used without express written permission."

CABCS0561



Legrand
8319 State Rt. 4
Mascoutah, IL 62258 USA
800-658-4641
618-566-3250
Fax 618-566-4978
www.legrand.us/cablofil