



# CHANNEL SYSTEM

## Channel Tray

### CCS

### Solid Cable Channel, Straight

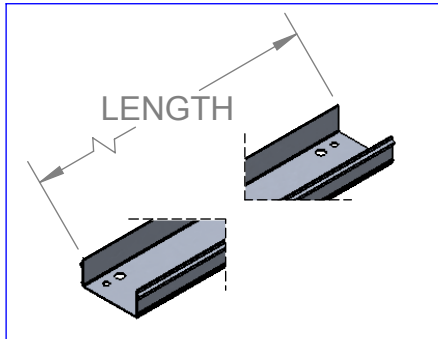

4"

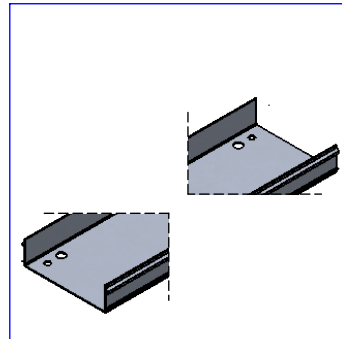

6"

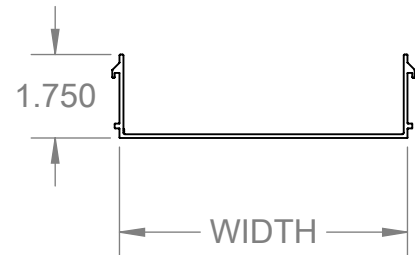

- **Material:** Aluminum Alloy 6063-T6
- **Depth:** 1.75" (Nominal)
- **Finish:** Plain
- **Bottom:** CCS: Solid
- **Construction:** Aluminum Extrusion
- **Cable Channel Design:** Cable Channel construction and markings are per the latest edition of NEMA Standards Publication VE1, CSA C22.2 No. 126.
- **Cable Channel Grounding Capability:** Classified as an equipment grounding conductor per NEC 392.60 with a maximum ampere rating: UL Cross Sectional area:
  - 4" = 0.657 in<sup>2</sup> (UL: .60 = 1000A)
  - 6" = 0.817 in<sup>2</sup> (UL: .60 = 1000A)
- **Mechanical Properties:**
  - 4": I<sub>x-x</sub> = 0.145 in<sup>4</sup>, S<sub>x-x</sub> = 0.114 in<sup>3</sup>
  - 6": I<sub>x-x</sub> = 0.163 in<sup>4</sup>, S<sub>x-x</sub> = 0.119 in<sup>3</sup>

MATERIAL	WIDTH(IN )	CHANNEL WEIGHT (LBS/FT)
A	4	0.619
A	6	0.759

#### CATALOG NUMBERING EXAMPLE:

CCS - A - S144 - 04			
BOTTOM TYPE CCS - SOLID	MATERIAL A	LENGTH	WIDTH
		S120 - 120" S144 - 144" S240 - 240"	04 - 4" 06 - 6"

"Copyright LNA, Inc. Drawings are proprietary and may not be copied or otherwise duplicated or used without express written permission."

CABCS0575



Legrand  
8319 State Rt. 4  
Mascoutah, IL 62258 USA  
800-658-4641  
618-566-3250  
Fax 618-566-4978  
www.legrand.us/cablofil