

ELECTRICAL PARAMETERS:

- SINGLE PHASE, 16A/208V, 3.3kVA
- INPUT TYPE: NEMA L6-20P 10' CORD
- OUTPUT TYPE: (20) C13 & (4) C19

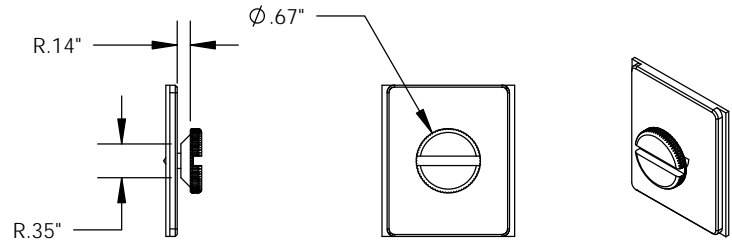

MOUNTING BUTTON
(2) INCLUDED

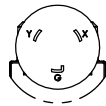
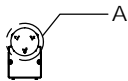

DETAIL A
SCALE 1:4
NEMA L6-20P

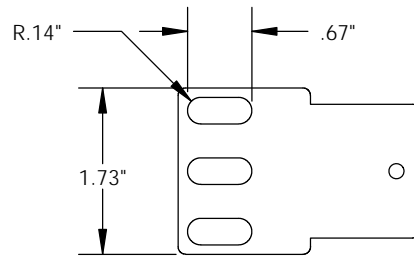

MOUNTING BRACKET
(2) INCLUDED

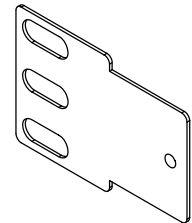

NOTES:

1. INSTALLATION SHALL COMPLY WITH ALL APPLICABLE NATIONAL, STATE, AND LOCAL CODES.
2. PLEASE REFER TO PRODUCT DOCUMENTATION FOR FURTHER INFORMATION.
3. MOUNTING BUTTONS ARE AN ALTERNATIVE MOUNTING METHOD TO THE TOOLLESS MOUNT FOR 3RD PARTY ENCLOSURES. BUTTONS ARE PROVIDED WITH THE UNIT. DETAILED INSTALLATION INSTRUCTIONS CAN BE FOUND IN THE PROVIDED MANUAL.
4. MOUNTING HARDWARE NOT INCLUDED.

*** NOTICE ***
THIS DOCUMENT CONTAINS CONFIDENTIAL AND/OR PROPRIETARY INFORMATION INTENDED FOR USE ONLY BY THE INDIVIDUAL(S) PROVIDED. NEITHER THIS DOCUMENT, NOR ANY INFORMATION CONTAINED HEREIN, MAY BE COPIED, DISTRIBUTED, DISCLOSED TO ANY THIRD PARTY OR USED IN ANY MANNER OTHER THAN FOR WHICH IT HAS BEEN PROVIDED, WITHOUT THE PRIOR WRITTEN CONSENT OF LEGRAND. MANUFACTURING RELEASE, PRODUCT SPECIFICATIONS AND STANDARDS ARE SUBJECT TO CHANGE WITHOUT NOTICE.



WWW.LEGRAND.US

TITLE

RACK PDU, BASIC, ZERO-U, 16A, 208V,
(20) C13 & (4) C19, L6-20P CORD

	NAME	DATE
DWN	CAC	1/7/2019
CHK	MM	1/7/2019
APPR	CV	1/7/2019

SIZE	CAD FILE	DWG NO	REV
A	LP22200C	LP22200	00
SCALE		SHEET	1 OF 1