



Basic Power Distribution Unit Quick Start Guide

Legrand PDU Support page: <https://www.legrand.us/pdu-support>

Legrand PDU Information: <http://www.legrand.us/pdu>

Legrand Basic Power Distribution Unit Quick Start Guide

Safety Precautions

WARNING! Read and understand all sections in this guide before installing or operating this product. Failure to heed any of the following WARNINGS may result in electric shock, fire, personal injury and death. Prior to operating this product, the user should read the online help and specifically the warnings in the online help.

WARNING! Connect this product to an AC power source whose voltage is within the range specified on the product's nameplate.

WARNING! Connect this product to an AC power source that is current limited by a suitably rated fuse or circuit breaker in accordance with national and local electrical codes.

WARNING! Use this product in a dry location.

WARNING! Connect this product to a protective earth ground. Never use a "ground lift adaptor" between the product's plug and the wall receptacle.

WARNING! If this product is a model that requires assembly of its line cord or plug, all such assembly must be performed by a licensed electrician and the line cord or plugs used must be suitably rated based on the product's nameplate ratings and national and local electrical codes.

FCC Compliance Statement (Class A):

This device complies with part 15 of the FCC Rules. Operation is subject to the following two conditions:

- (1) This device may not cause harmful interference, and
- (2) This device must accept any interference received, including interference that may cause undesired operation.

Federal Communications Commission (FCC) Statement :

This equipment has been tested and found to comply with the limits for a Class A digital device, pursuant to part 15 of the FCC Rules. These limits are designed to provide reasonable protection against harmful interference when the equipment is operated in a commercial environment. This equipment generates, uses, and can radiate radio frequency energy and, if not installed and used in accordance with the instruction manual, may cause harmful interference to radio communications. Operation of this equipment in a residential area is likely to cause harmful interference in which case the user will be required to correct the interference at his own expense.

FCC Caution - §15.21:

Changes or modifications not expressly approved by the party responsible for compliance could void the user's authority to operate the equipment.



Legrand Basic Power Distribution Unit Quick Start Guide

0U Basic PDU Overview



*Model LP-22300 shown. PDU models may vary in features and design.

- | | |
|---|---|
| 1. IEC C13 Integrated Locking Receptacles | 5. IEC C19 Integrated Locking Receptacles |
| 2. IEC C19 Integrated Locking Receptacles | 6. Circuit 2 |
| 3. Circuit 1 | 7. Rotatable Power Inlet Cord |
| 4. IEC C13 Integrated Locking Receptacles | |

1U Basic PDU Overview

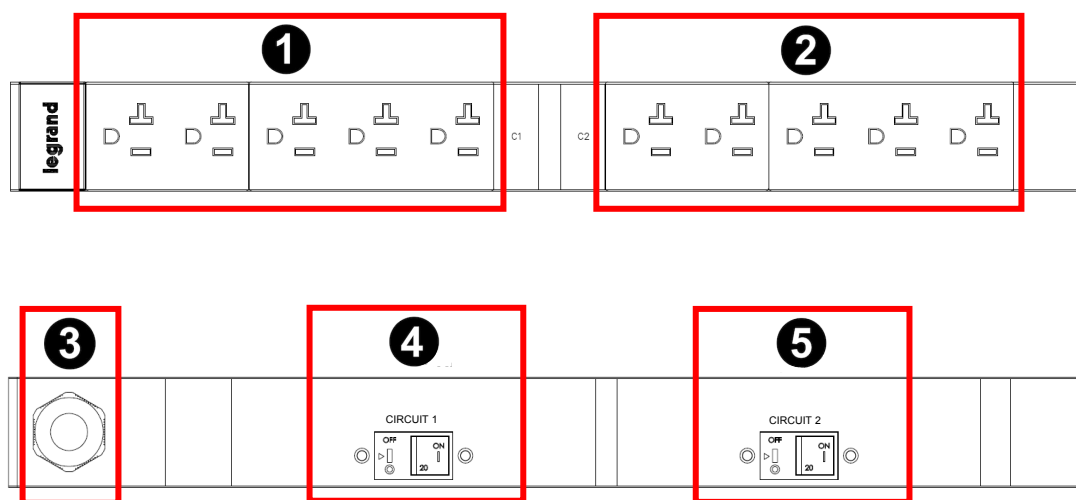

*Model LP-21310 shown. PDU models may vary in features and design.

- | | |
|---------------------------|--------------|
| 1. NEMA 5-20R Receptacles | 4. Circuit 1 |
| 2. NEMA 5-20R Receptacles | 5. Circuit 2 |
| 3. Inlet Power Cord | |

Vertical 0U Mounting

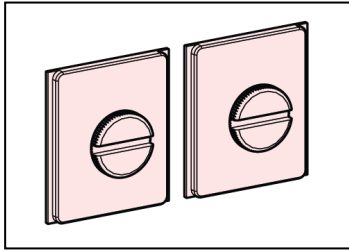

1. Slide flat button mount onto rear of PDU device.
Determine the spacing that is required for the PDU to align with holes on PDU mounting bracket or rack and slide button mount into place.
2. Rotate button on mount to secure.
3. Mount by positioning the PDU at the rack, then pressing the buttons through the key-holes in the PDU mounting bracket.
4. Let the PDU drop down slightly to lock into place.

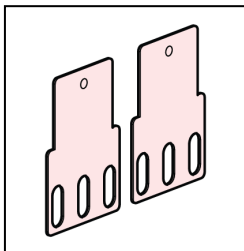
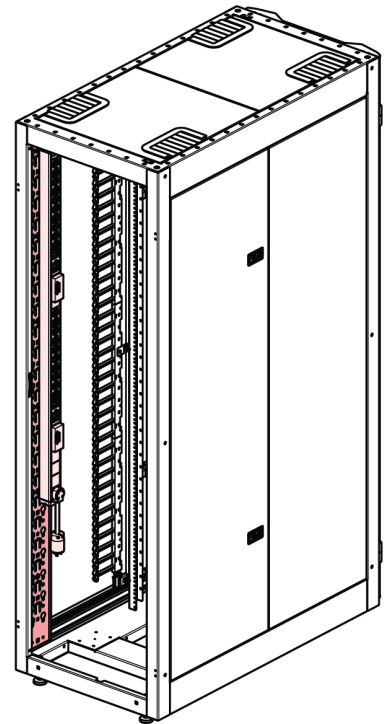
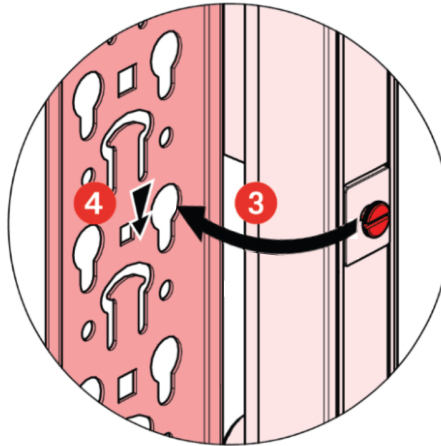
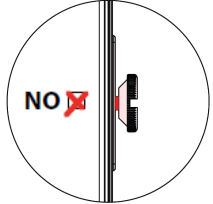
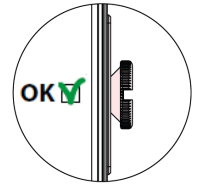
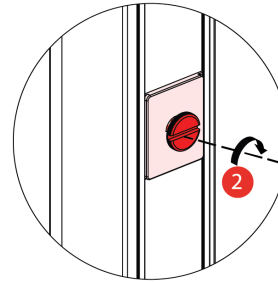
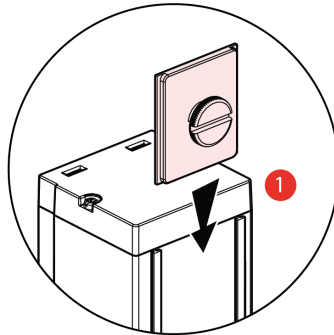

1. Slide brackets into both ends of the channel on the rear of the PDU. Align the raised side of the circular indentation to the rear face of the PDU to ensure a secure fit.
2. Using rack screws (not included), fasten the PDU to the rack by aligning the opening of the attached brackets.

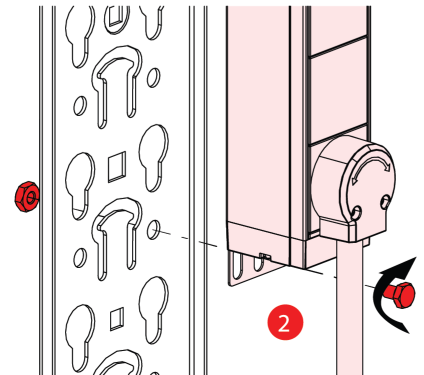
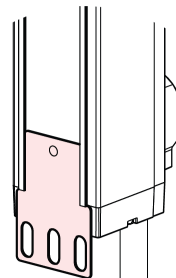
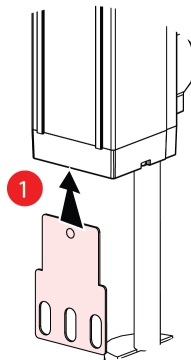

Horizontal 1U Mounting

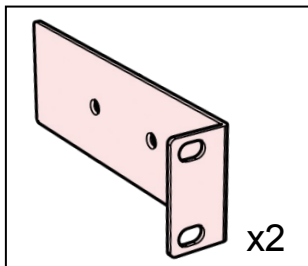

1. Attach mounting brackets to each end of the PDU using provided bracket screws.
2. Choose a location in the rack to mount the PDU. For rack rails with square holes, insert cage nuts (not included) in applicable rack spaces.
3. Using rack screws (not included), fasten the PDU to the rack by aligning the mounting holes of the attached brackets with the installed cage nuts or threaded rack rail holes. Tighten screws to secure.

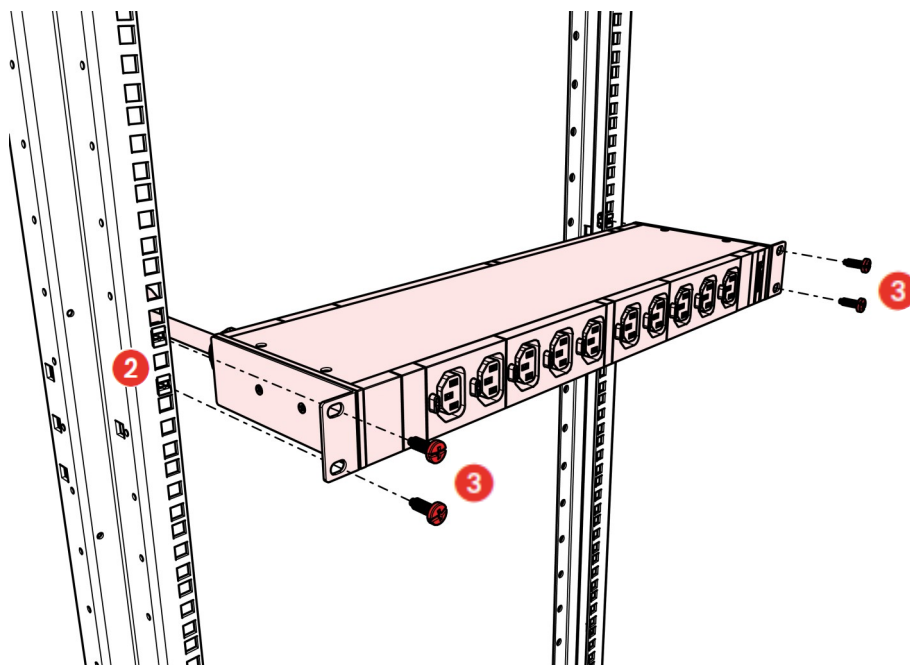
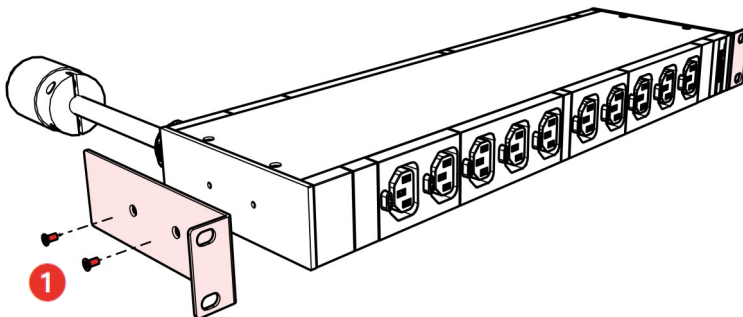

Horizontal 1U Mounting

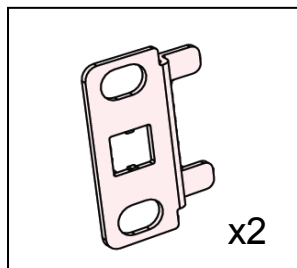

1. Attach mounting brackets to PDU by sliding brackets into slots on each end of the PDU.
2. Choose a location in the rack to mount the PDU. For rack rails with square holes, insert cage nuts (not included) in applicable rack spaces.
3. Using rack screws (not included), fasten the PDU to the rack by aligning the mounting holes of the attached brackets with the installed cage nuts or threaded rack rail holes. Tighten screws to secure.

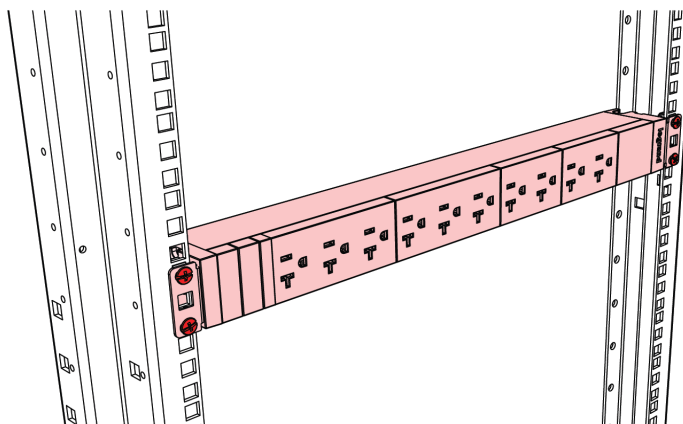
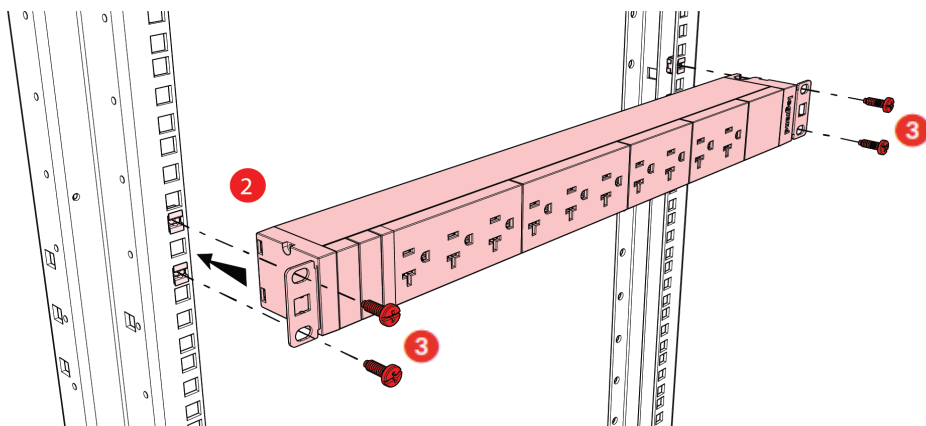
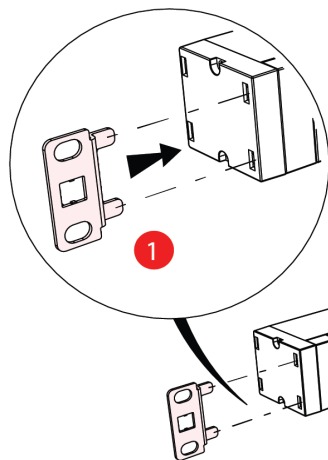

Legrand Basic Power Distribution Unit Quick Start Guide

Power On the PDU

If your Legrand PDU model has circuit breakers, verify that all circuit breakers on the device are set to ON. If not, turn them ON.

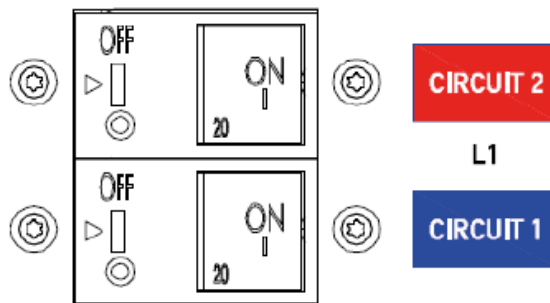

*Note: PDU models may vary in features and design.

Plug each Legrand PDU into an appropriately rated branch circuit with the proper mating connector/receptacle. See the label or nameplate affixed to your Legrand PDU for appropriate input ratings or range of ratings.

Product Label Example



Outer Carton Label Example



