

INSTALLATION INSTRUCTIONS

Contain-IT FLEX Aisle Containment System Single LH or RH Sliding Door

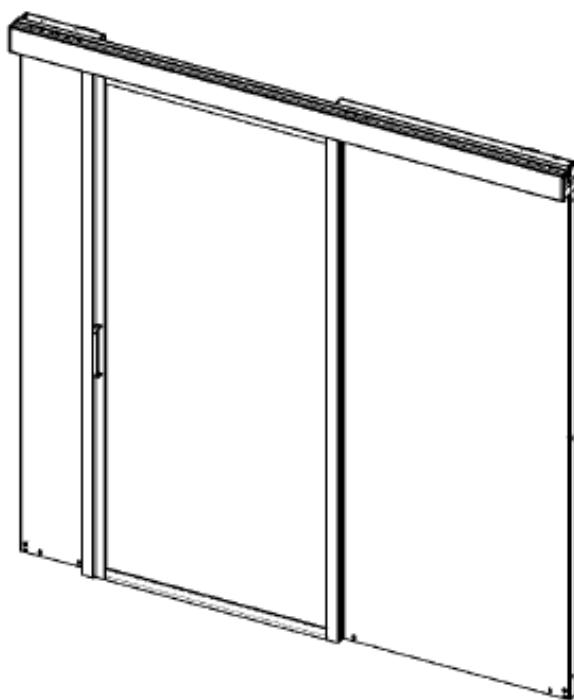

Tools and Hardware needed

Required Tools and Materials



Hardware and Materials

CAB TO CAB MOUNT HARDWARE



WALL TO CAB MOUNT HARDWARE

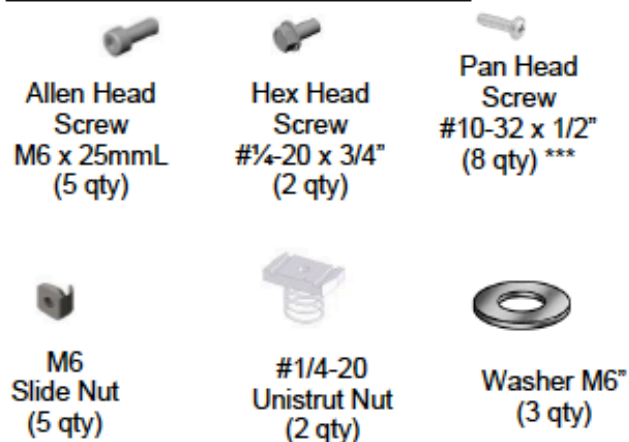

* - Size depends on type of anchor or anchor screw and type of floor.

** - Selection of the anchor will depend on type of floor.

*** - For Header Cover.

LOCTITE
(Not Included)

Concrete Anchor
(Not Included) **

Single Sliding Door Components

- Handling and installing the doors will require a minimum of 2 people to safely and properly install the doors to the cabinets.
- Remove all packaging material and avoid scratching or damaging door parts.
- Wear proper safety equipment (such as safety glasses, appropriate shoes, etc) when handling and installing the doors.

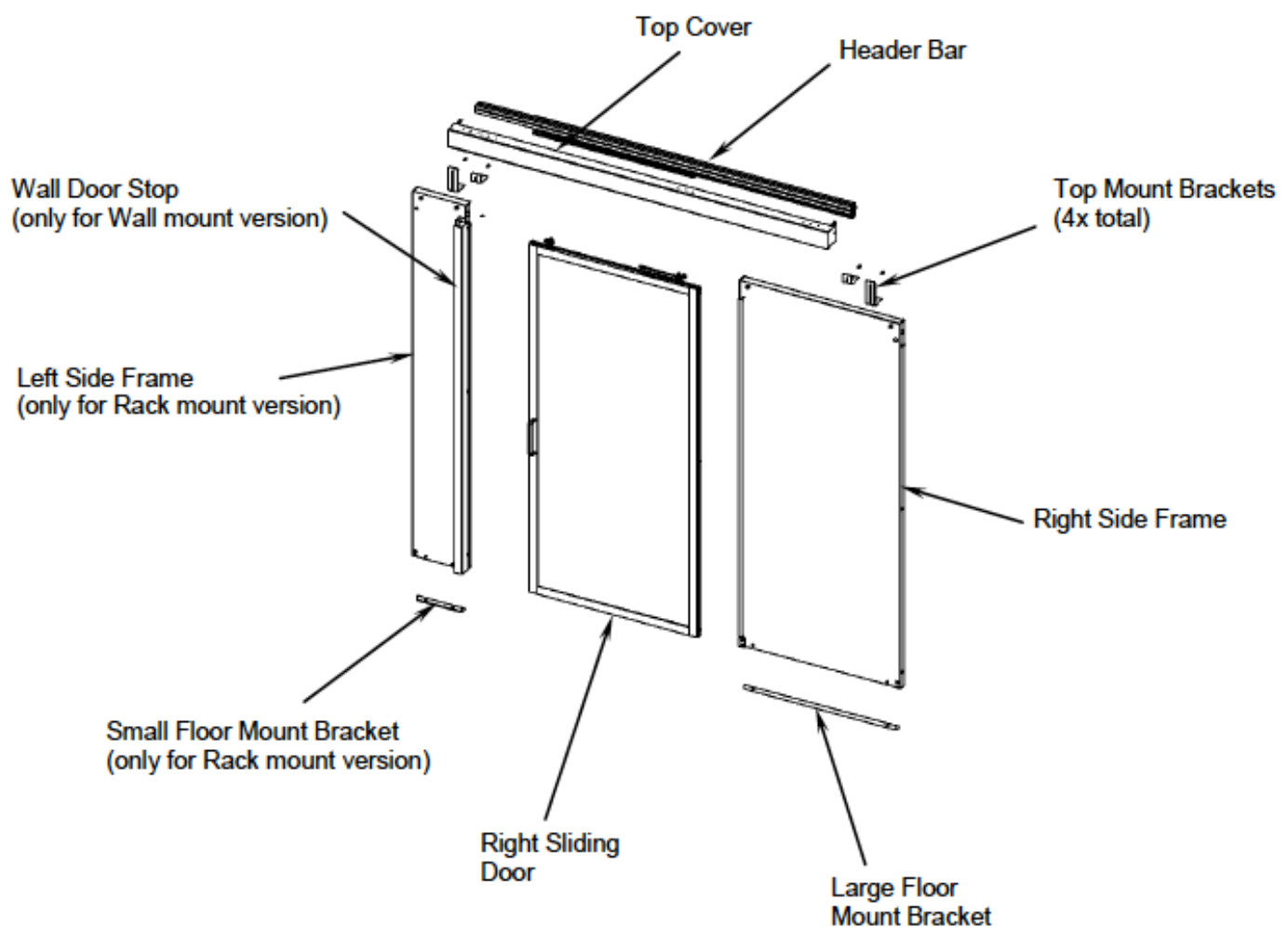

STEP A: Aligning and Leveling the Racks

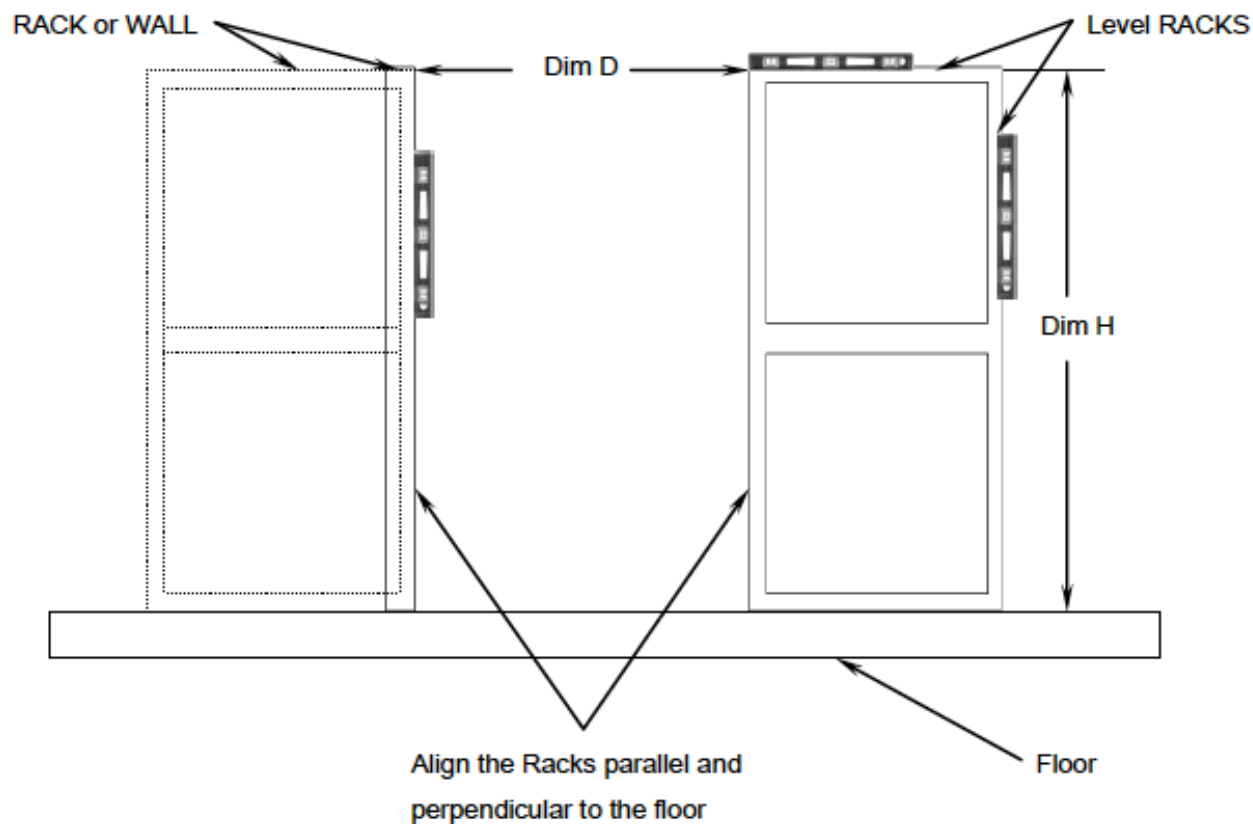

1. Align the racks at the end of the rows as best as possible. The doors will line-up properly if the racks are aligned.
2. Check if the rack(s) are leveled and parallel. Level the racks if necessary.
3. The "H" measurement for both Racks 1 and 2 should be the approx. height for the size of Aisle Containment doors ordered.
4. The frame-to-frame "D" distance between racks or a wall and should be between 36" and 48" wide, which is the recommended distance for the Aisle Containment Doors. Move the rack(s) if possible.

STEP B: Locating holes for the Floor Mount Brkts for two Racks

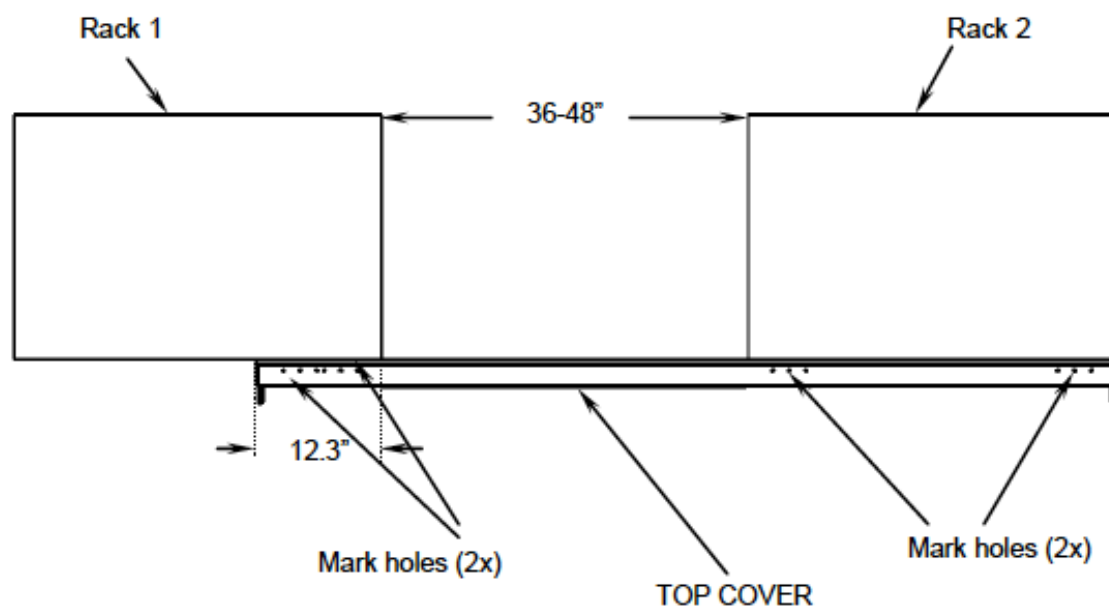

1. Use the Top Header Cover as a Template to align the Left and Right Floor Mounting Brackets to the floor as shown. Use the face of the Rack and space 12.3" from the far edge of the Top Cover as reference alignments. Aisle widths between 36" and 48" wide can be accommodated.
2. Mark at least 4x mounting holes, the hole size is based on the hardware used for the floor.

STEP C: Mounting the Floor Mount Brackets to the Floor

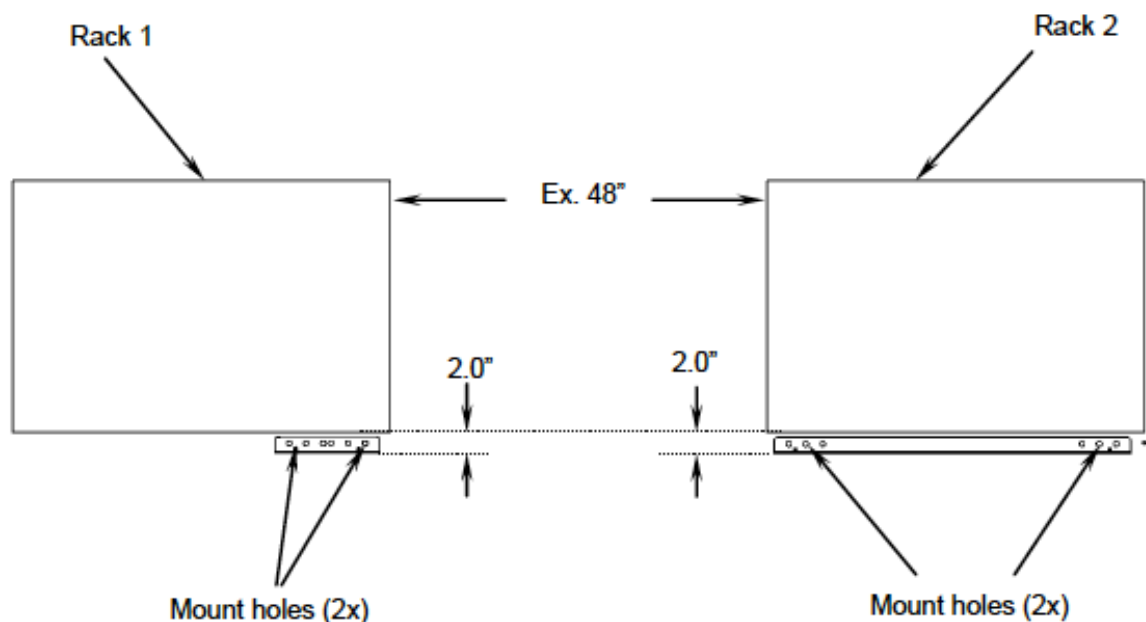

3. Drill the floor mounting holes for suitable size hardware, using the previously marked holes. For this part, Installer must supply own hardware.
4. Secure the Floor Mount Brackets for the Rack to Rack version to the floor as shown.

Note: The manufacturer does not supply floor anchoring hardware. It is recommended that the installer purchase the suitable anchor hardware based on the type of floor in their facility.

STEP D: Locating holes for Floor Mnt Brkts for a Rack and Wall

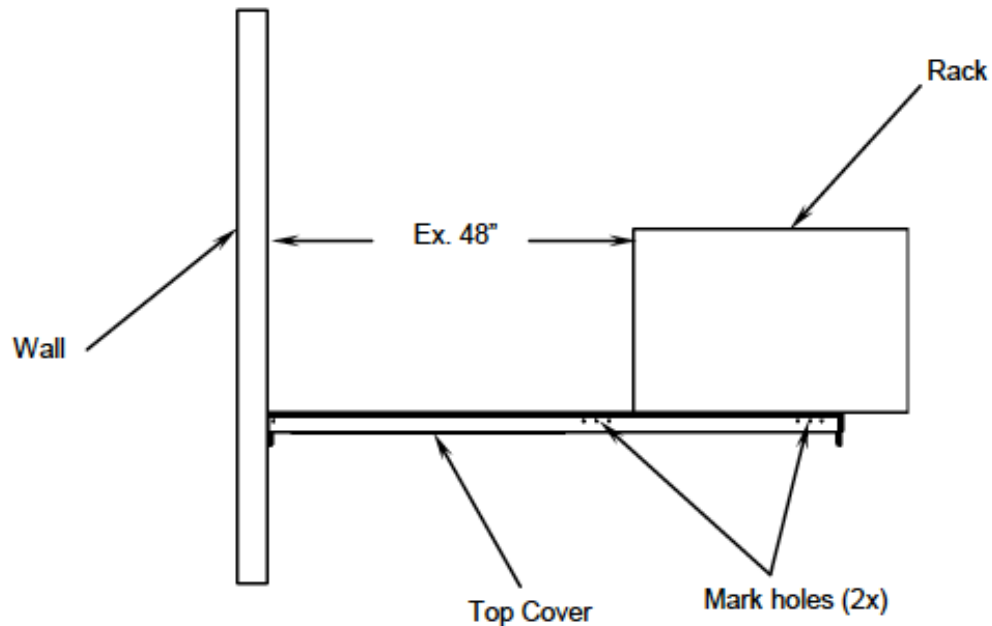

1. Use the Top Header Cover as a Template to align the Left or Right Floor Mounting Bracket to the floor as shown. Use the side of the Rack and the far edge of the Top Cover mated to the Wall as reference alignments. Aisle widths between 36" and 48" wide can be accommodated.
2. Mark at least 2x mounting holes, the hole size is based on the hardware used for the floor type.

STEP E: Anchoring Floor Mount Brackets for a Wall and Rack

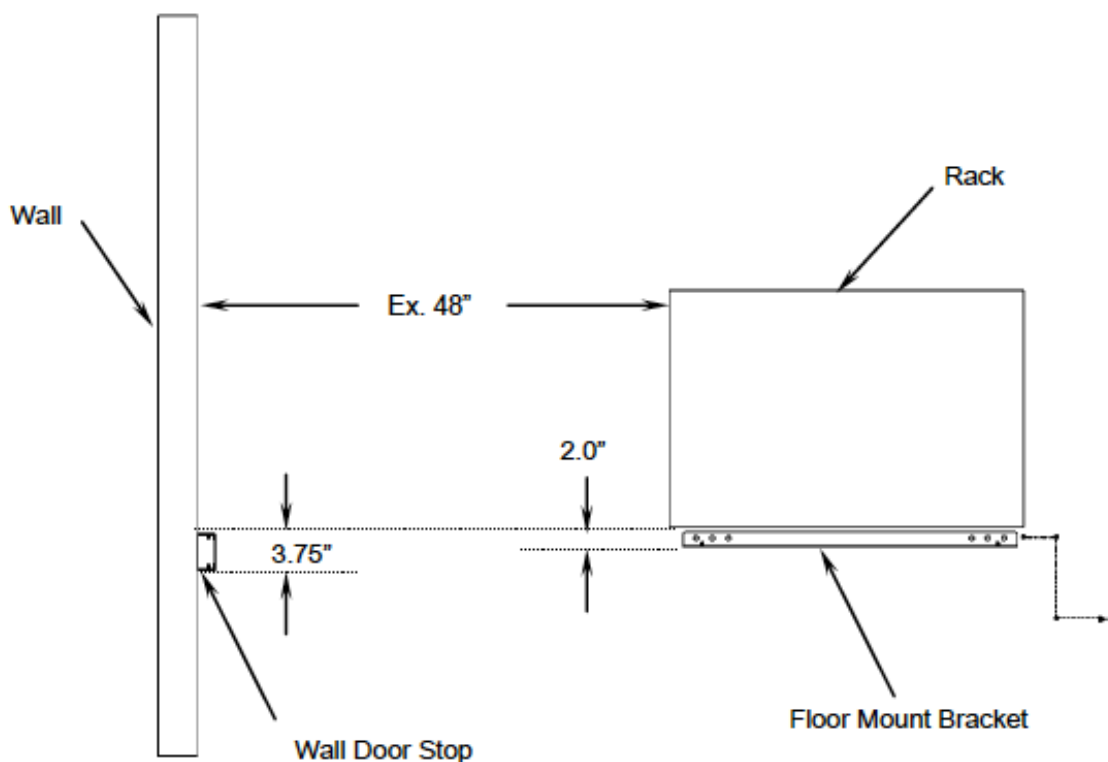

5. Secure the Floor Mount Brackets for the Rack-to-Wall version to the floor with suitable hardware. For this part, installer must supply own hardware.
6. Align Wall Door Stop as shown and mount directly to the Wall with suitable hardware. Use the dimension of 3.75" described in the layout for the correct location.

Note: The manufacturer does not supply floor or wall anchoring hardware. It is recommended that the installer provide the suitable anchor hardware based on the type of floor in their facility.

STEP F: Attaching Left and Right Frame Panels to the Header

- Lay down on a clean and protected surface, both left and right hand Door Panels as shown. Note: Wall mount door versions only have one large left or right Frame Panel.
- Place the Header Bar between both panels and attach each side with the 3x M6 Socket Screws with washers as shown in the detail.
- Also attach the Alum Header to the two panels on each side with 2x M6 Screws and 2x M6 Slide Nuts.

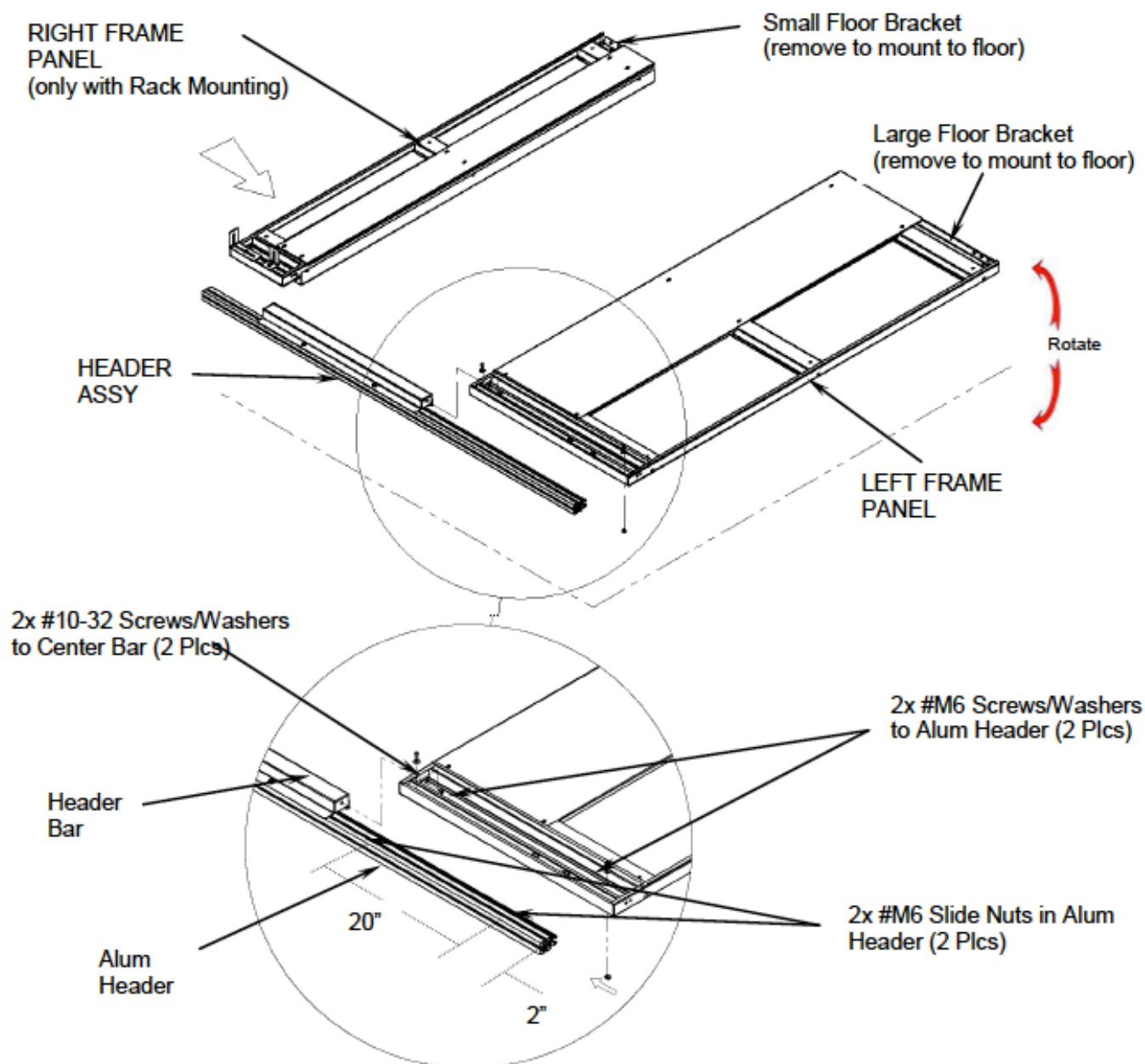

STEP G: Securing Bottom of the Panel/Header Assy for Racks

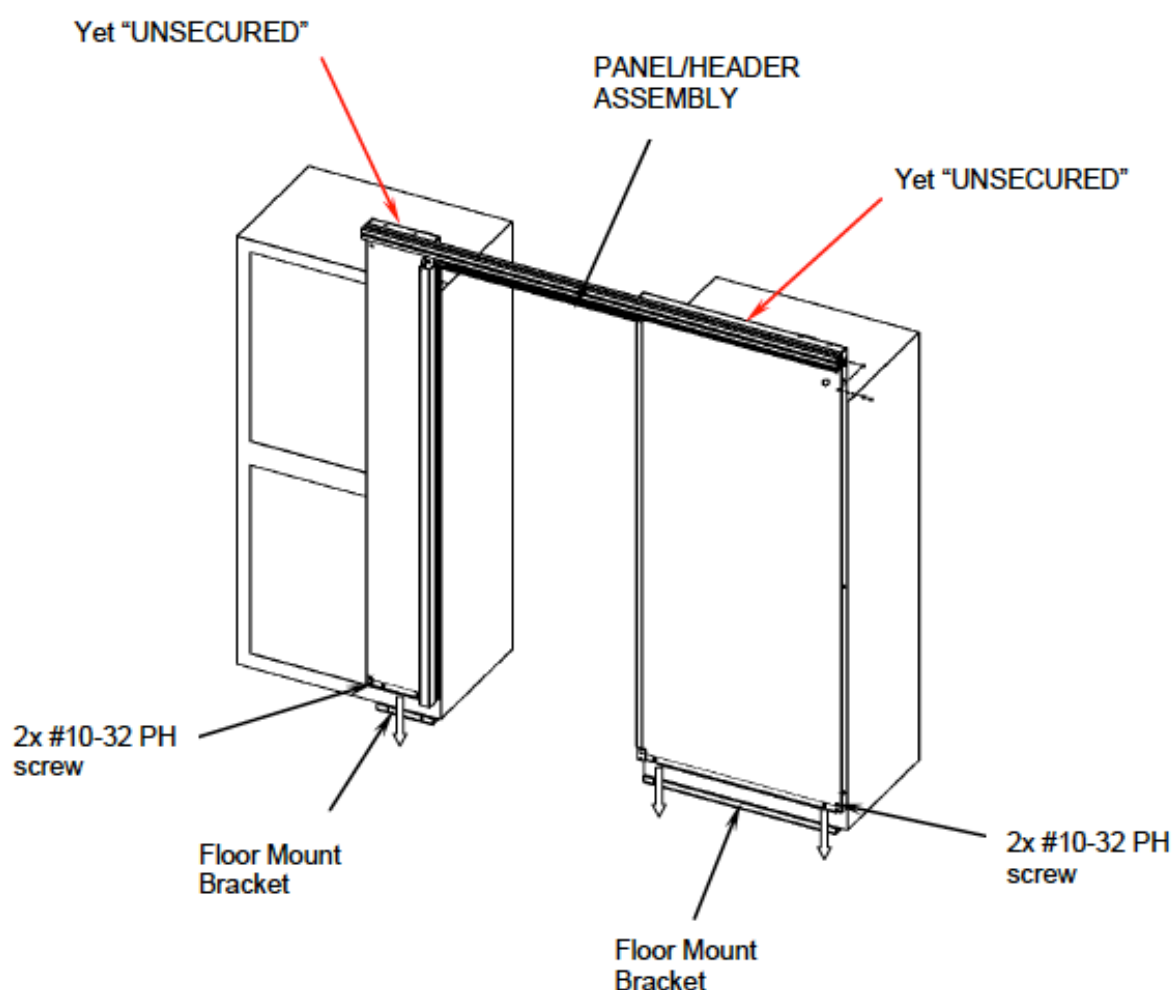

1. Lift up perpendicular, the complete Panel/Header Assembly, with at least two people and align to the end racks as shown. **NOTE:** Installation of the panels could be done in the upright position if access to the top of the cabinet is not obstructed by overhead equipment. Panels can be properly spaced and mounted first to the rack, and the header attached later for mount option #2.
2. Align each Door Panel to their respective Floor Mount Brackets and first loosely secure with 4x #10-32 Pan head screws and LOCTITE.. **Important:** Prevent the Panel/Header Assembly from tilting by having a person support it until they are secured on top.
3. **Note:** The Frame assembly for the Wall mount version is done similarly, except there the small Frame is replaced with a Wall Door Stop which is mounted directly to the Wall.

STEP H: Securing the Top of the Frame/Header Assy to a Rack

4. Use #1/4-20 screws and washers to attach both Frame Panels with the adjustable Top Mount Brackets (2 ea) to the top of each Rack. Use LOCTITE to prevent loosening of hardware.
5. At this point the Frames must be leveled and equally spaced top and bottom. The Header must also be level. Finally tighten the bottom screws to the Floor brackets.

Mount option #2: Header can be attached separately to the upright panels during this setup.

Make sure the header and holes line up with the panels before permanently securing them.

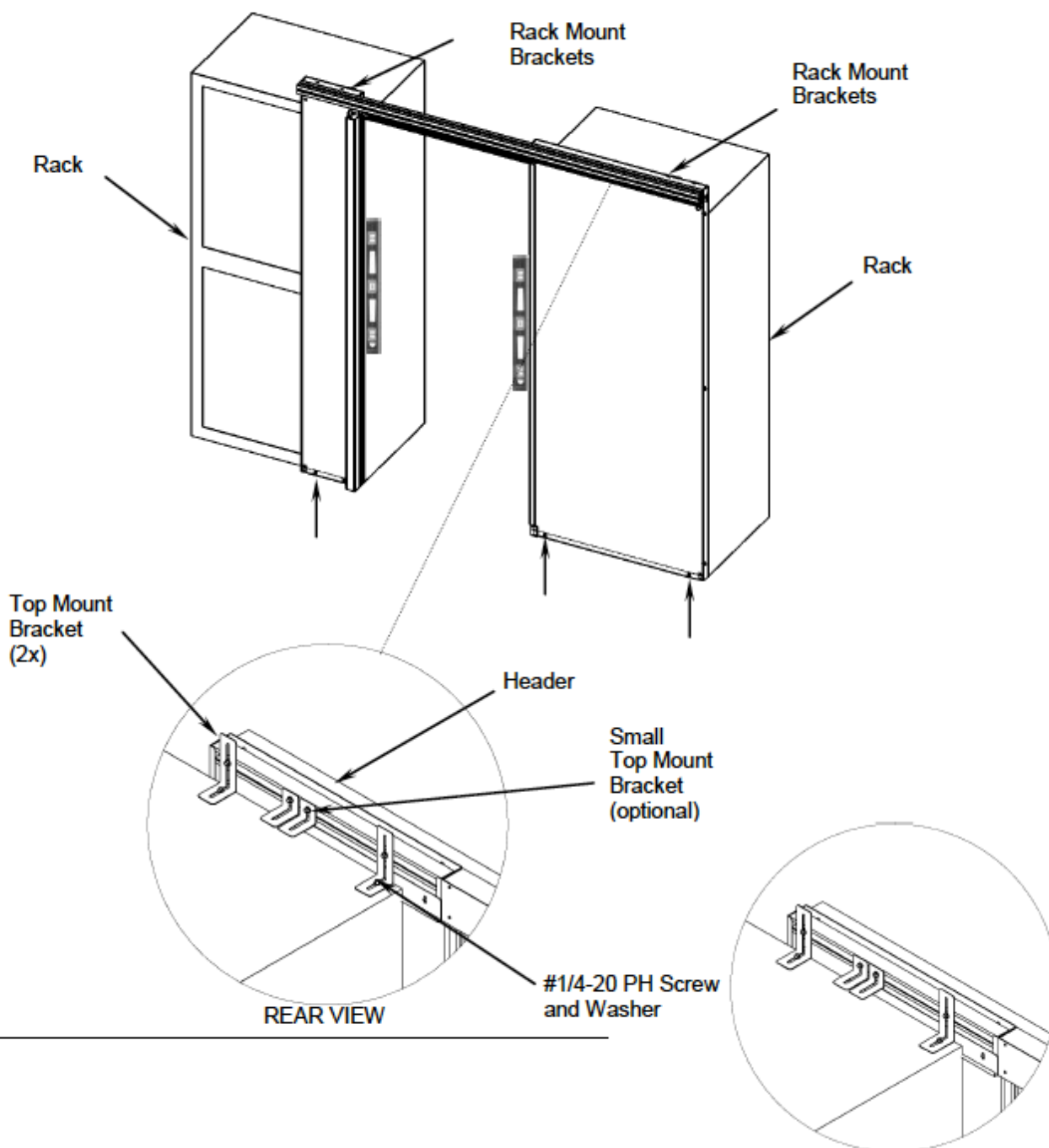

STEP H: Inserting RH Sliding Door into Header Track

6. Slide RH Door into Header Track as shown. (rear Handle Bracket needs to be removed)
 - a. Insert top Roller assembly (2x) into RH Track. Face the Rollers oriented opposite to each other. (see detail) Set Actuator to "open" in soft close mechanism (see detail)
 - b. Make sure that the bottom door rail is also inserted into bottom guide bracket.
7. Once the door is fully inserted, hook the Retract Cable to the shaft of the closest Roller assembly. A long nose plier may facilitate insertion of the hook. Also re-attach the rear Handle Bracket to the Door.

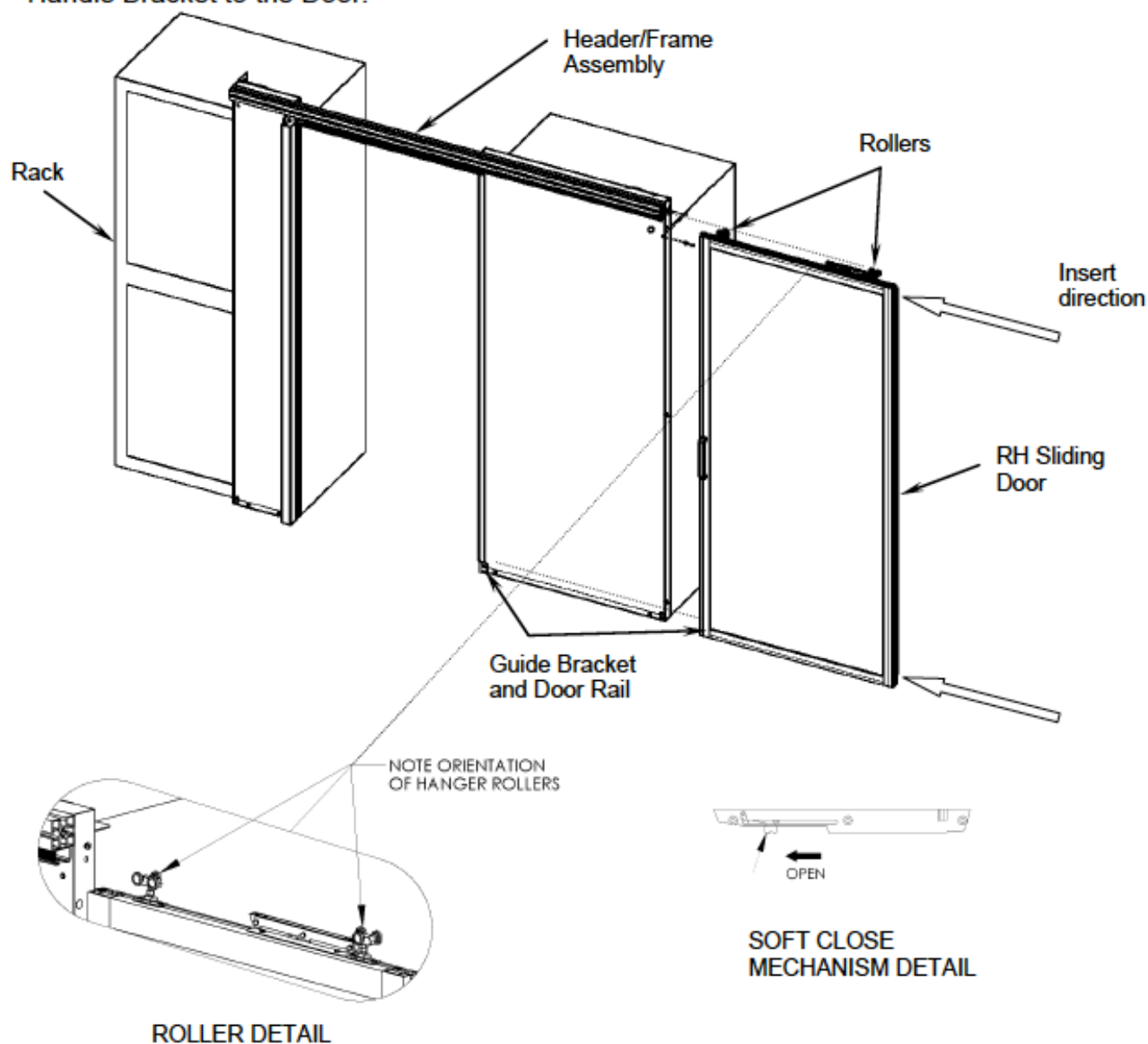

STEP I: Securing the Top of the Frame/Header to Rack and Wall

1. Use # ¼-20 screws and washers to attach both of the adjustable Top Mount Brackets to the top of the cabinet.(see detail)
2. Attach Header to the Wall by using the Wall Mount Bracket and self-tapping screws. (supplied by the Installer)

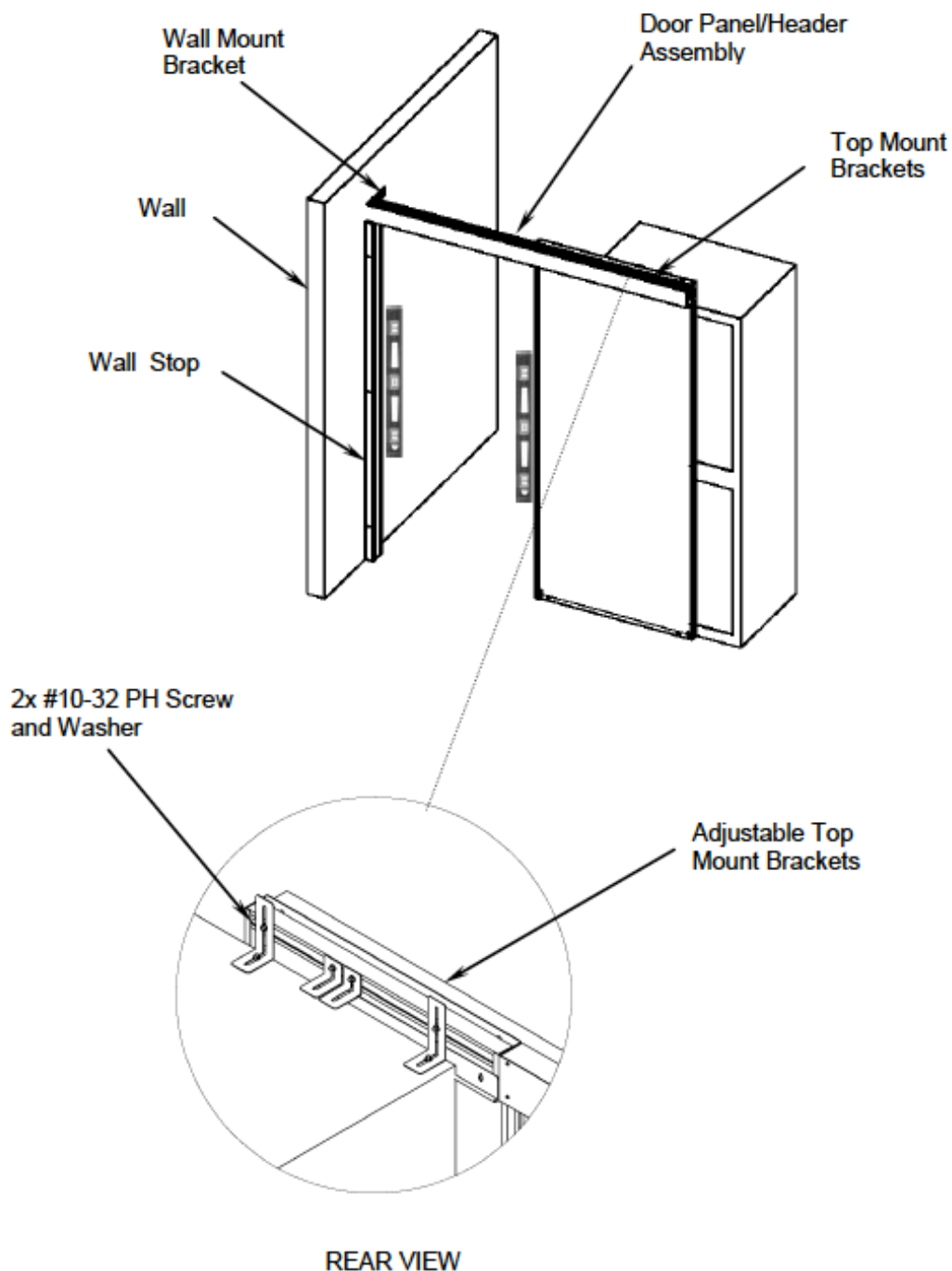

STEP J: Inserting RH Sliding Door into Header Track

2. Slide RH Door into Header Track as shown. (inside Handle Bracket needs to be removed)
 - a. Insert top Roller assembly (2x) into RH Track. Face the Rollers oriented opposite to each other. (see detail) Set Actuator to "open" in soft close mechanism (see detail)
3. Once door is fully inserted, hook of the Retract Cable to the shaft of the closest Roller assembly. A long nose plier may facilitate insertion of the hook.
4. Next re-attach the inside vertical Handle Bracket.

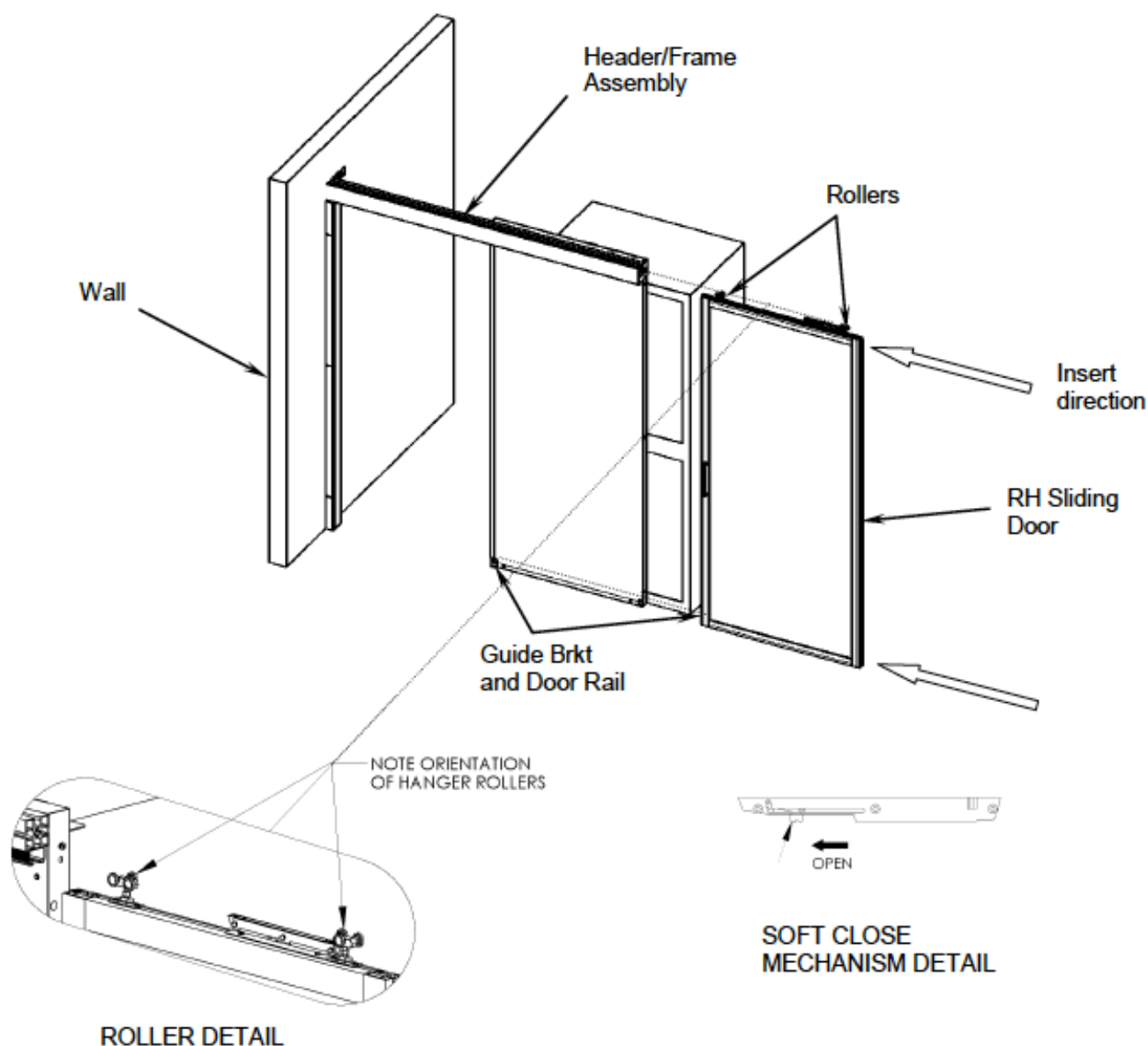

STEP K: Attaching Top Cover to a Header with a Wall and Rack

1. Finally, attach and hang the Top Cover to top of the Header and secure with 2x #10-32 screws, as shown.

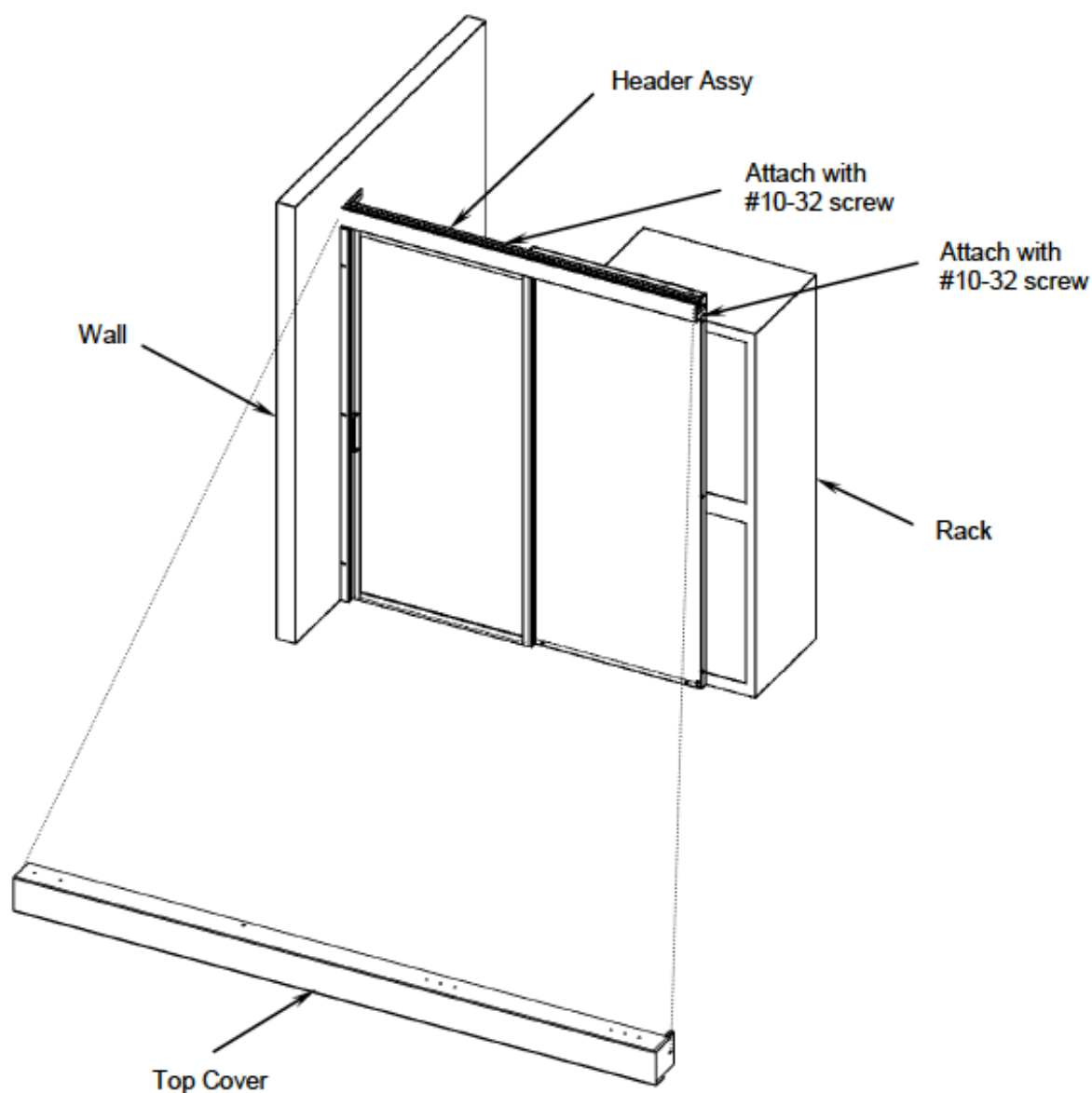

STEP L: Attaching the Top Cover to the Header for two Racks

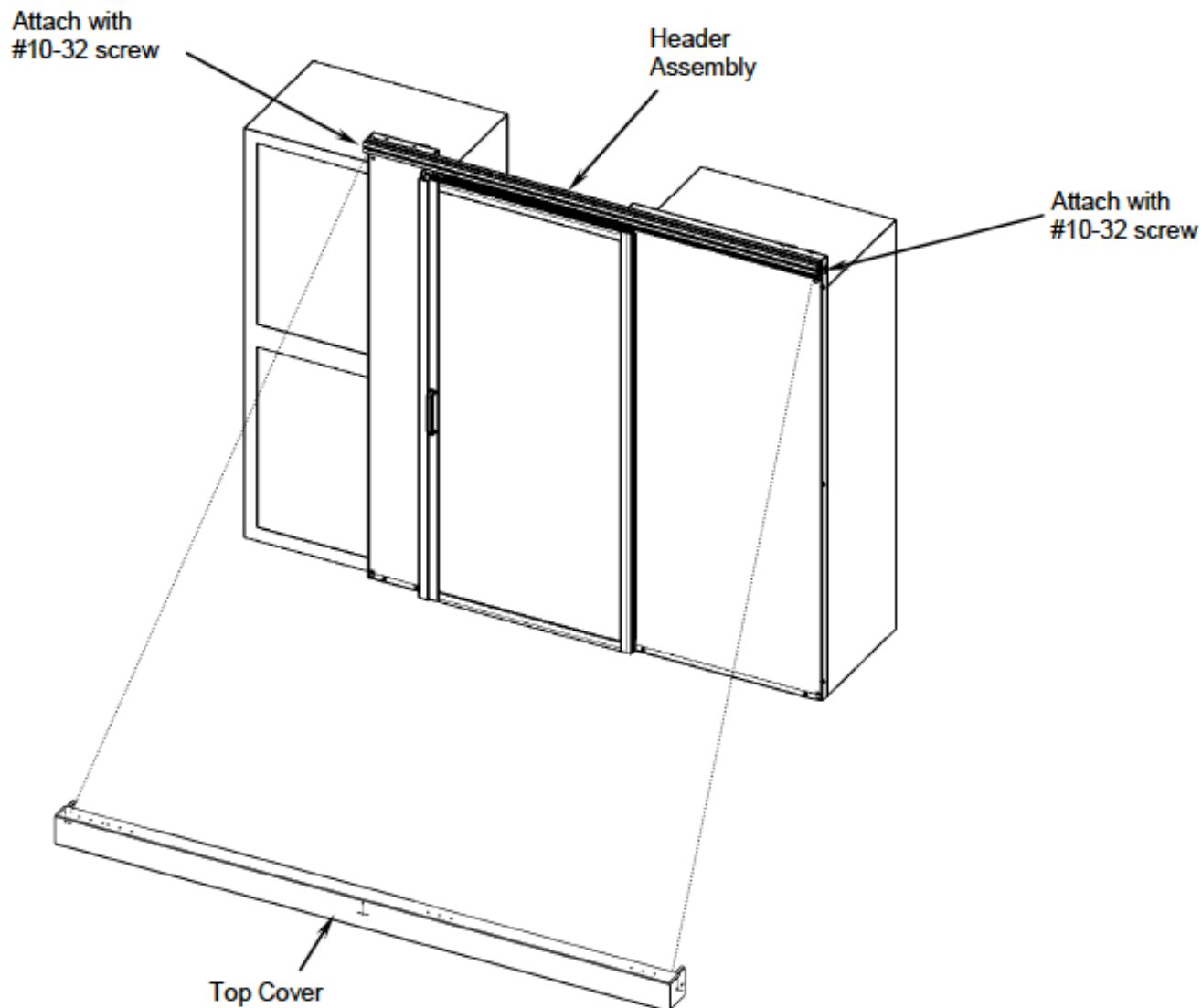

1. Finally, attach and hang the Top Cover to top of the Header and secure with 2x #10-32 screws, one on each side.

FAQ

A. What if there is gap when the doors are at the closed position?

1. Once doors are fully inserted, adjustment to the Roller assemblies may be required to align the vertical and horizontal mating edges of both the left and right doors.
 - a.) This can be done by turning the adjustment nuts, as shown, for each roller assembly. The objective is to make sure the doors are plumb and the bottom of the doors are aligned. Most cases this adjustment solves both.
 - b.) Minimal adjustment is needed, only a quarter to half a turn for each nut for each door is usually required. By adjusting either the inside or outside Roller assemblies of each door the necessary alignment is quickly achieved.

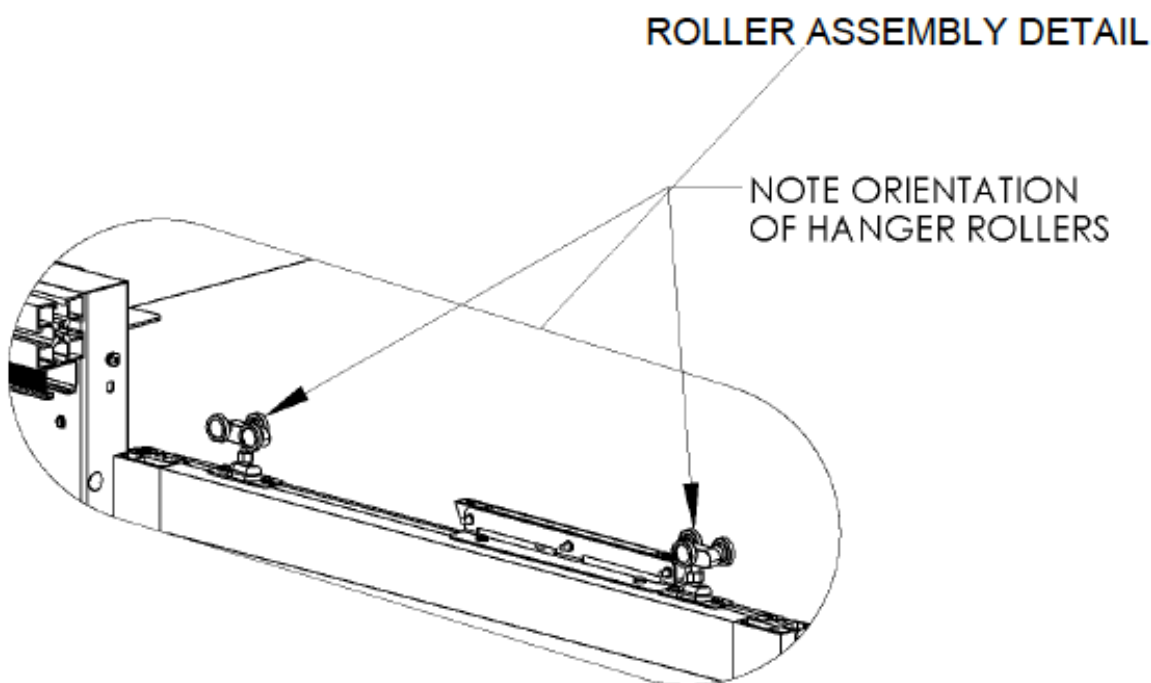

FAQ

B. What if the doors do not line up?

1. Once doors are fully adjusted to eliminate any gap between the doors they may also need alignment for the horizontal bottom edges of the left and right doors.

Usually adjustment for one door side is needed. Raise or lower the door evenly until the bottom edges of both are aligned. Again, both roller assemblies can lowered or raised by turning the adjustment nut.

C. What if the doors do not fully close?

1. Tabs may be hitting the dampers. Adjust tabs to clear the dampers.
2. Doors may be rubbing the side panels. Adjust roller assembly back to move doors forward. Loosen screws to roller base and tighten when door clears side panels.
3. Top of doors may be rubbing the header baffle. Adjust baffle back to clear interferences.

D. What if the doors are not staying open?

1. The doors when fully opened should catch the ball detent found on top of each of the left and right side panels. If the doors do not stay open or need to be increased for pull force, then adjustment of the ball detent can be made by rotating it counterclockwise until sufficient detent lock is achieved.

IMPORTANT INFORMATION

A. Important facts to know:

1. Containment Doors are available in several heights. Choice of door height is depended on the height and size of the cabinets being used.
2. Aisle widths encountered can also affect the door widths needed. Single Sliding Doors can accommodate 32" to 36" wide aisles. A single 36" wide door may be best for smaller aisle widths of 36" or less.
3. Single Sliding Containment Doors come in 5 standard nominal heights, each of which increase in 3.5" increments.
4. Containment doors can be used for all makes of cabinets as long as there are mounting points available on top of the cabinet and the cabinet is deep enough to hold the side panels without protruding out the rear. They are designed best to work with Legrand cabinets.
5. Door opening width for Single Doors is approximately 35" wide.
6. Clear door insert panels come in either .125" thick polycarbonate or 8mm thick double wall "Polygal", UL rated plastics. Cleaning of plastic surfaces is done by using a soft cotton cloth with a mild soapy dish water solution. Prevent scratching of plastic surfaces and do not use reactive chemicals.
7. There are five basic types of containment doors available.
 - a. Dual Sliding doors with double 24"W doors for cabinet to cabinet layouts.
 - b. Single left or right 36"W Sliding Doors for cabinet to cabinet layouts.
 - c. Single left or right 36"W Sliding Doors for cabinet to wall layouts.