

TS SERIES MANUAL SHADES

SF-TXX / SF-RDXX

Factory configured shade cassette system allows for quick and easy shade installation, reduces installation cost, and common mistakes

Ships as a fully assembled cassette system to guarantee perfect operation based on project design requirements

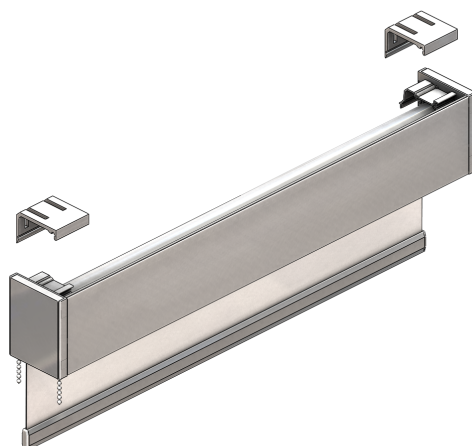

Heavy-duty bracket system provides up to 66% installation efficiencies compared to non-cassette roller shades

Many options, including single and dual shade with standard and reverse roll, pockets, room darkening, and multiple manual control options. Additionally, the Cord Keeper option complies with Canadian cord safety regulations.

DESCRIPTION

Legrand Shading Systems Teleshade (TS) series is a factory configured shade cassette that provides easy to install shades with enhanced features. The shades and large selection of fabric options provide glare control and allow occupants to access daylight and views. The Cord Keeper Device allows Teleshades to comply with Canadian regulations regarding cord safety for shades. The TS system is also offered as a motorized solution and allows for a complete product solution for any shading project.

OPERATION

The TS series has a broad range of configurations including single and dual shades with a variety of roll, chain, and rail options. The high quality clutch system can be driven from the left side, right side or both, with the additional ability to manually pull the shades into position. The four inch shade cassettes also offer bottom up configurations for privacy and unusually shaped windows. In addition, Legrand excels at

custom configurations, whether they are manual or motorized shades, for unusually shaped windows, corner applications, or various pocket designs.

Shades equipped with the Cord Keeper are operated by repeatedly raising and lowering the Switch Mechanism. The direction the rocker is pressed dictates if the shade is to be raised or lowered.

APPLICATIONS

The complete Teleshade (TS) shade series has manual and motorized shade products for a wide range of applications from Education, Healthcare, to Commercial Office spaces. The cassette system speeds installation by up to 66% with various pre-configured options.

The TS shade series offers product options not found on many shade systems including factory configured pockets and even venting pockets to remove window heat build-up from conditioned spaces.

FEATURES

- Consistent aesthetics and function to match TS series motorized shades
- Unique counter balance clutch provides smooth operation, a lighter lift, and manual tug control
- Chain options include left or right operation or both and a chain diverter option
- Crank operation option available
- Aluminum tubes: no rust stains on the fabric from high humidity locations
- Light gap – 3/4 in (19 mm) symmetrical light gaps
- Individual Shades covers windows up to 129 in (3.28m) wide by 200 in (5.08 m) tall with the 5 in (127 mm) Teleshade Cassette
- Side Channels and Sill Rails available.
- Fascia options: for single, dual shades and includes back fascia. Fascia has nine different color options
- Multiple hembar options
- Factory tested and shimmed
- For additional mounting flexibility five additional bracket options are available for various side and top mount applications.
- Shades equipped with the Cord Keeper are compliant with Canadian regulations regarding cord safety.
- Legrand Shading Systems standard 25 year limited hardware warranty.

PROJECT

LOCATION/
TYPE

SPECIFICATIONS

- Operating Temperature: 32F to 122F (0C to 50C)
(Interior use only)
- Manually controlled modular roller shade cassette systems with counterbalanced spring assemblies

OPTIONS

Legrand offers a wide range of performance fabrics in different colors, weaves, and price points to make it easy to choose the right shade for your application. Our fabrics are made by leading manufacturers like Phifer and Mermet. We offer numerous environmentally friendly fabrics that are GREENGUARD certified, PVC free, or Cradle-to-Cradle certified. We have fabrics infused with Microban to inhibit the growth of bacteria, mold and mildew that can cause stains, odors and degradation of the fabric. All commercial fabrics are fire rated and carry industry certifications as required by the most stringent of specifications.

Solar Screens - Legrand offers a collection of fabric screens that allow a wide range of view-through and light management options. We offer fabrics with fiberglass and polyester cores, and others coated with PVC or other materials to offer precise light management.

Sustainable Solar Screens - For projects where environmentally conscious requirements are specified. Sustainable options include Cradle to Cradle Certified, PVC-free and 100% recyclable materials incorporated in high quality durable fabrics that still perform as required

Room Darkening Fabrics - A selection of opaque fabrics to block daylight. These materials may be combined with side channels and sill rails to further control light in the space.

Commercial Decorative Fabrics - This collection of commercially compliant fabrics provides aesthetic options for projects where design is an important element.

Fascia & Hembar Finishes*

Gloss White



Beige

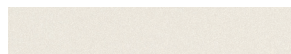

Dark Gray

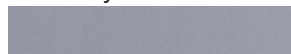

Black



Clear Anodized



Light Bronze



Ceiling White

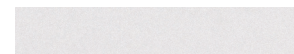

Charcoal

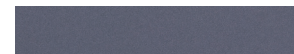

Dark Bronze

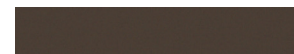

*Side and bottom channel models available, in the color finishes noted for Fascia and Hembar.

Fascia Options

4 in and 5 in Aluminum Fascia, Back Fascia

Cord Keeper Options

Color options include White, Black, Dark Bronze, and Space Silver.

The chain cover comes in lengths of up to 8 feet, however the cover is sized to custom fit each shade per cord safety regulations.

The Cord Keeper is partially installed at the factory.

SHADE OPTIONS

Hembar

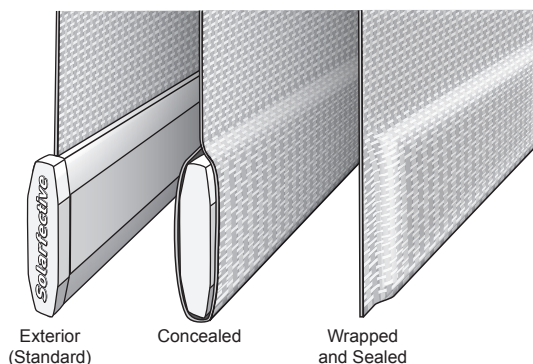

NOTE: Concealed and Wrapped & Sealed options available for AC Drive models only

Fabric Drop

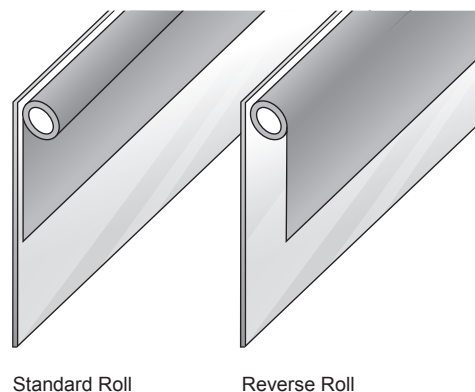

Drive Side

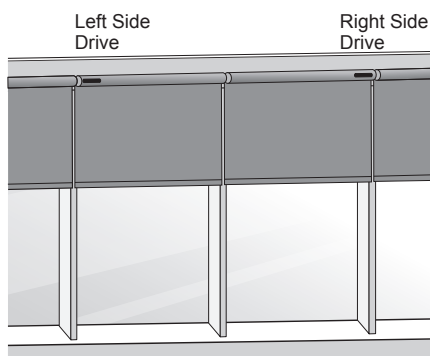

Mounting

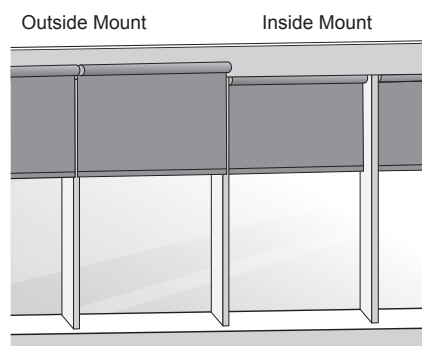

MOUNTING INFORMATION AND DIMENSIONS

NOTE: Recommended: #8 x 1 1/2" - 4" flat head for wood screws and #8 x 1"- 2 1/2" pan or flat head self tap screws for metal (not included with shade)

Teleshade System Dimensions

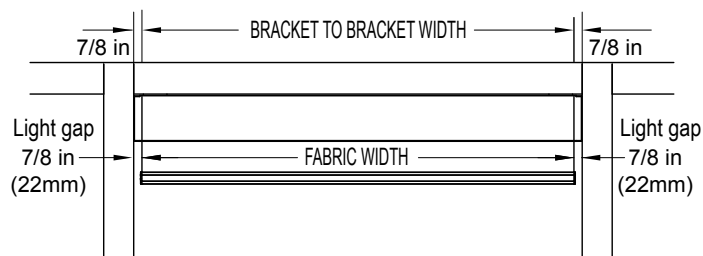

Typical end cap detail

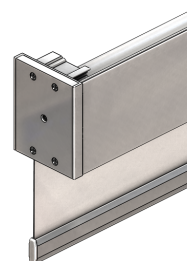

SF-T1 and SF-T10 - 4 in and 5 in Manual Teleshade

NOTE: Teleshade (TS) can be mounted with blocking on the ceiling or the wall (drawings show both options)

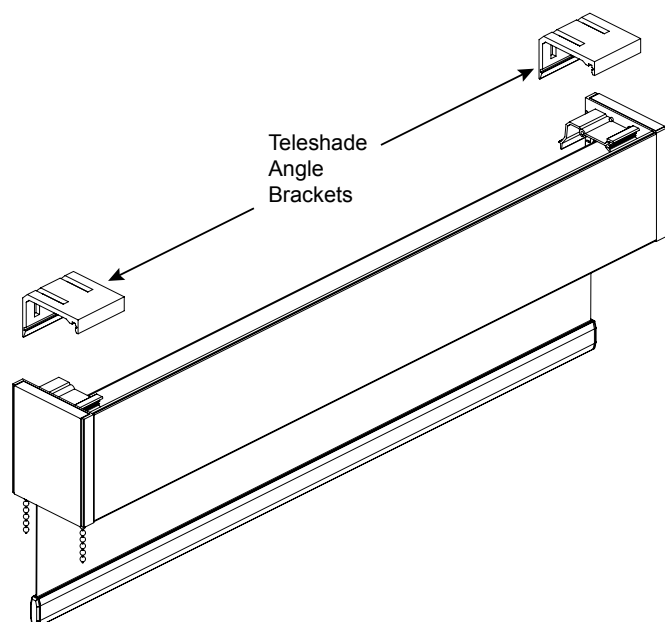

4 in Teleshade size limitation 129 in (3.28 m) wide by 110 in (2.79 m) high

5 in Teleshade size limitation 129 in (3.28 m) wide by 200 in (5.08 m) high

SF-T1

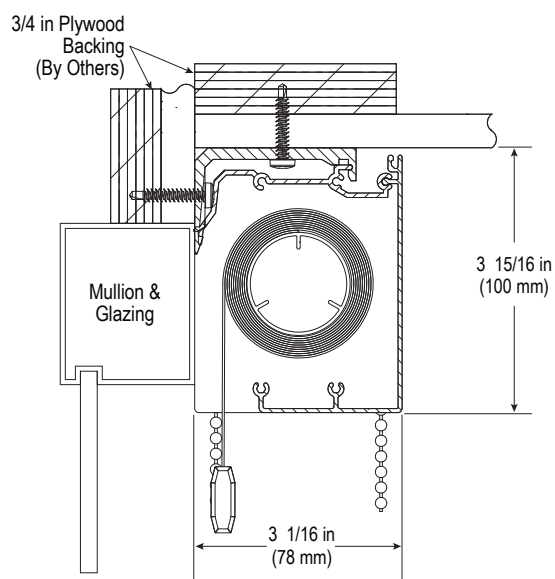

SF-T10

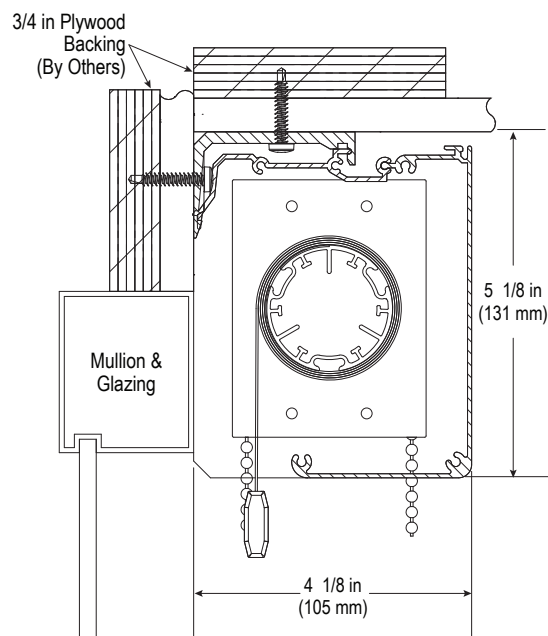

SF-T2 - 4 in Teleshade with Back Fascia

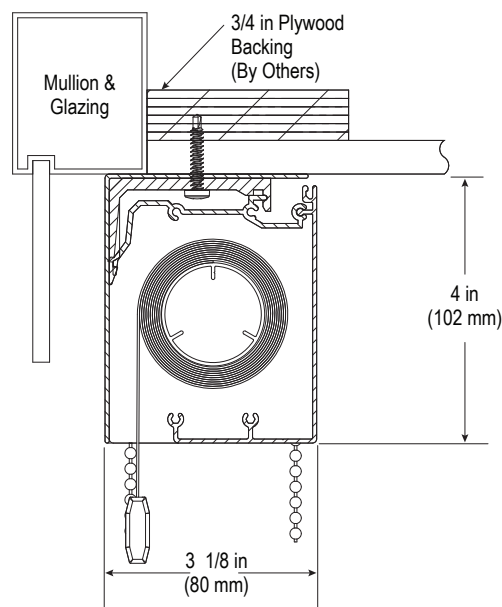
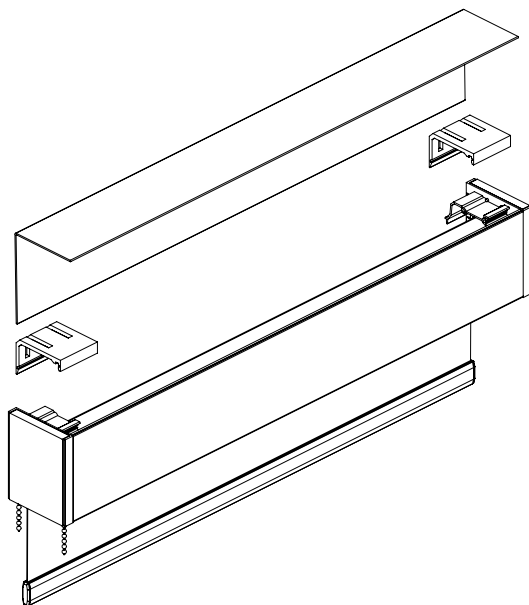

SF-T9 and SF-T9A - 6 in Dual Teleshade

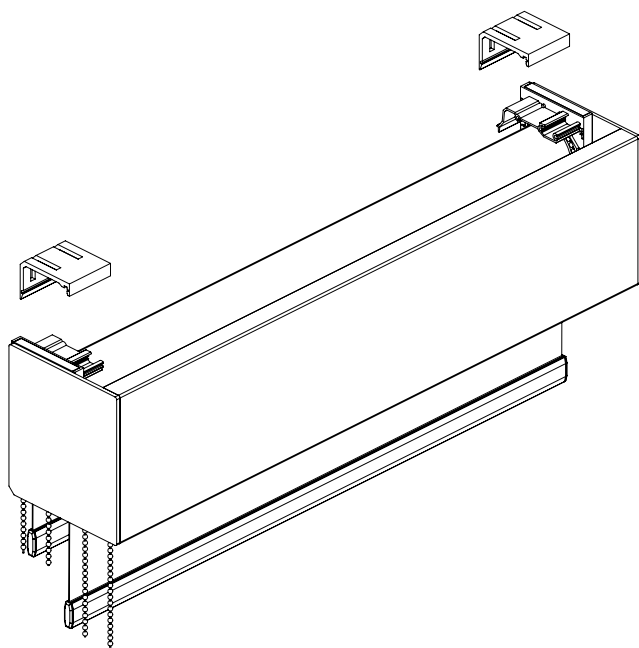

SF-T9

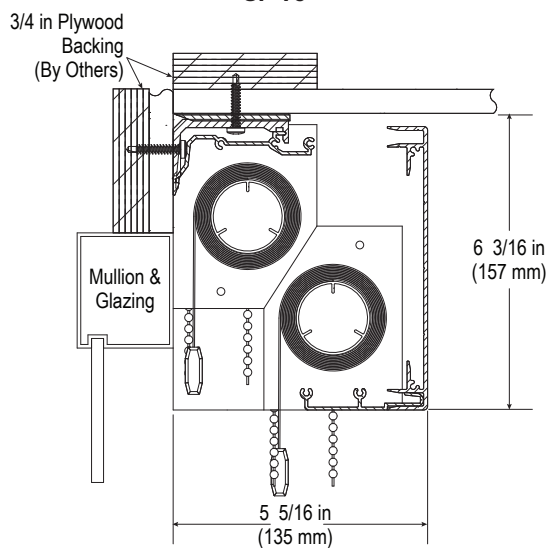

SF-T9A

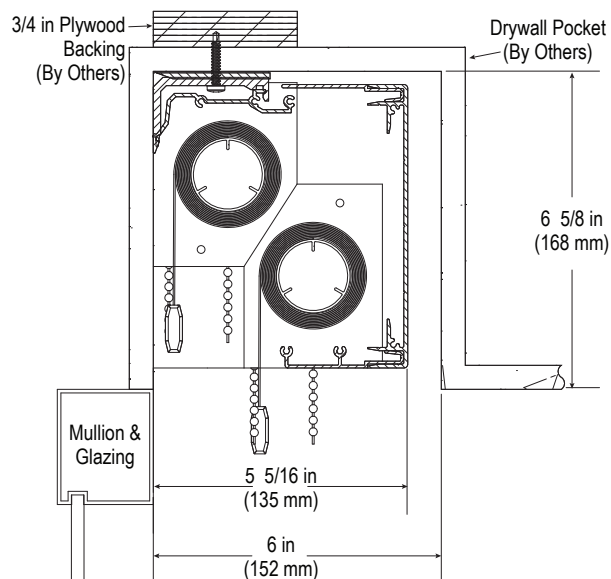

Can be installed as a standalone dual shade or in a pocket as shown to the right

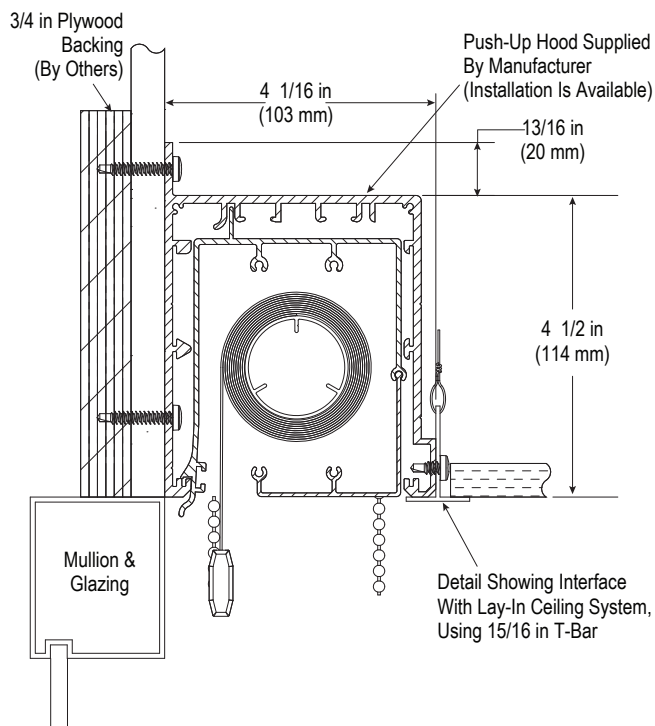
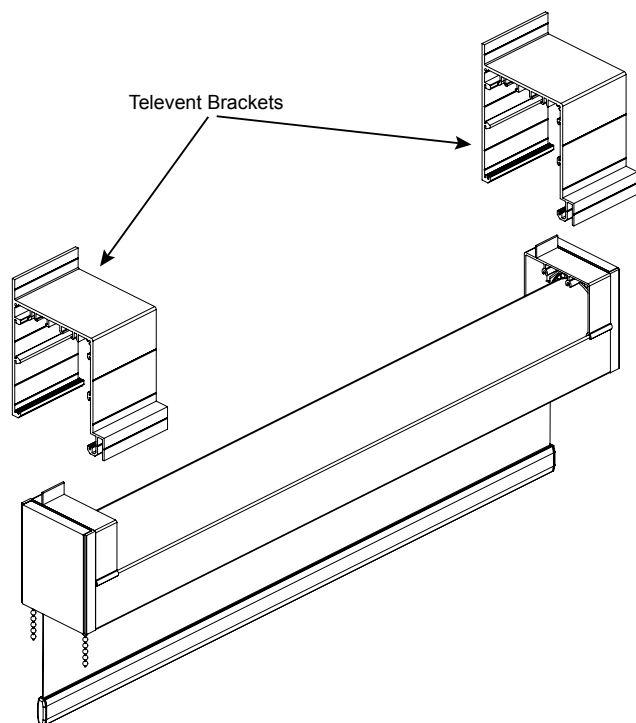
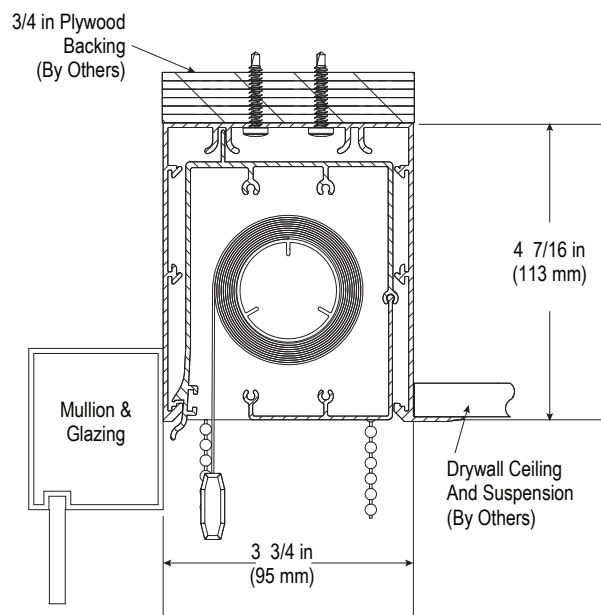
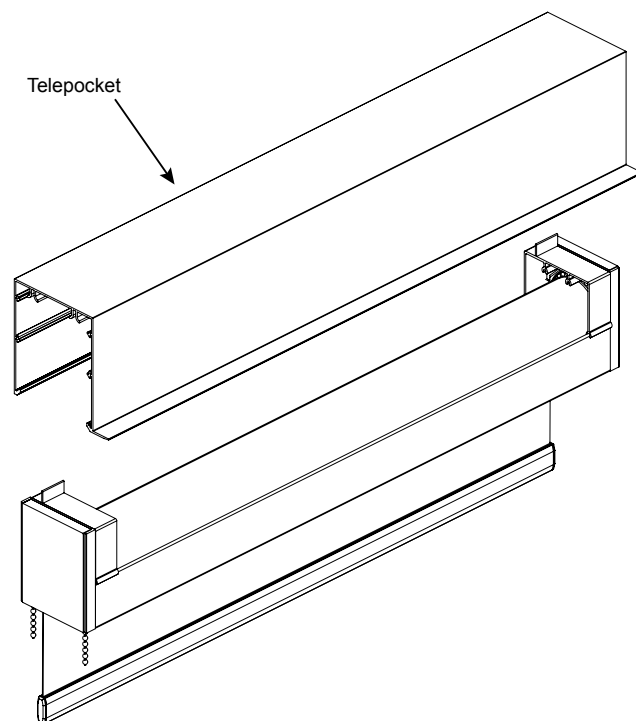
SF-T4 - 4 in Teleshade with Televent Pocket for venting window heat to plenum. Integrated lip for ceiling tile

SF-T17 - 4 in Teleshade with Telepocket. Factory configured pocket extrusion that seamlessly integrates the shade

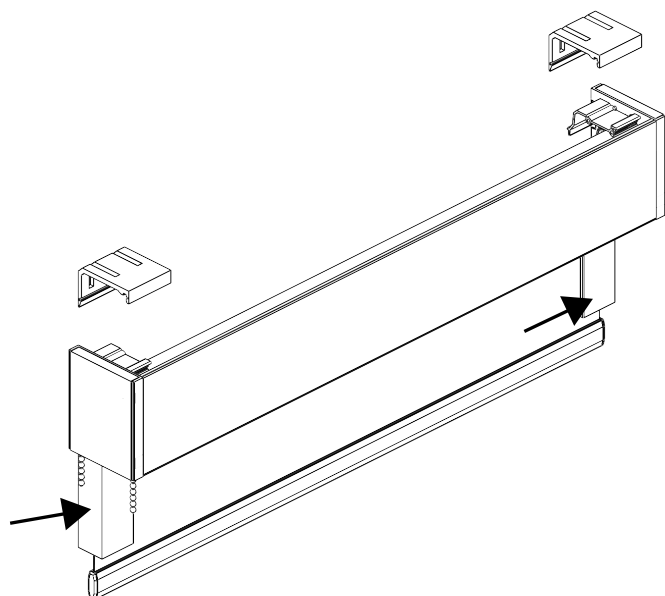
SF-RDxx Models - Similar in configuration to regular Teleshade models, these models add Room Darkening elements (side channels and sill angles)

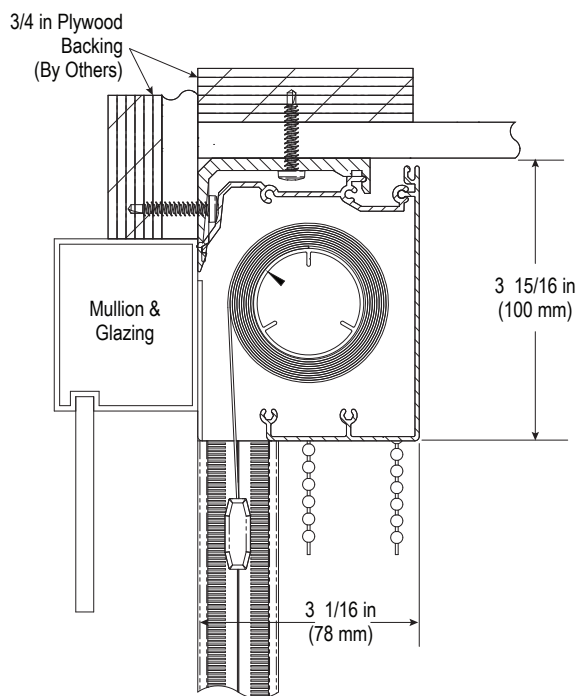
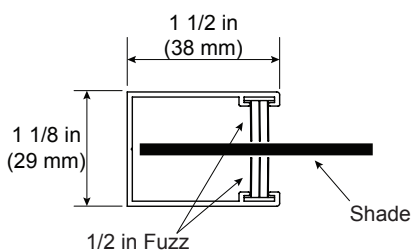

Side Channel



Sill Rail

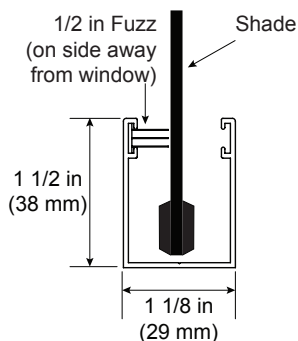

Note: Works with any hembar option

Teleshade with Cord Keeper Option

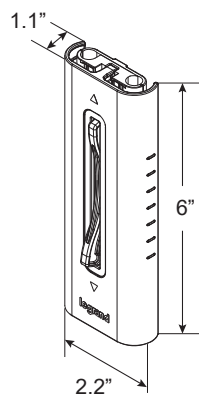
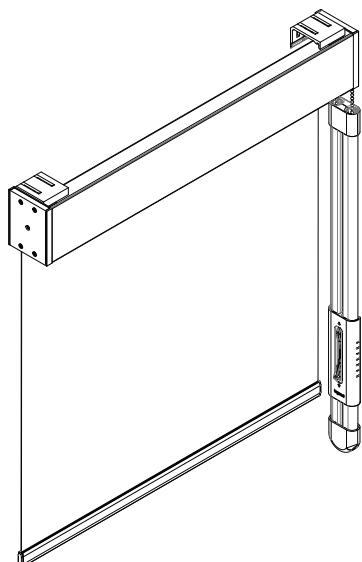

TELESHADE BASIC CONFIGURATION INFORMATION

Catalog #		Description
<input type="checkbox"/>	SF-T1	4 in Manual Teleshade cassette with front fascia – shade size up to 129 in (3.28 m) x 110 in (2.79 m)
<input type="checkbox"/>	SF-T10	5 in Manual Teleshade cassette with front fascia – shade size up to 129 in (3.28 m) x 200 in (5.08 m)
<input type="checkbox"/>	SF-T2	4 in Manual Teleshade cassette with front and rear fascia
<input type="checkbox"/>	SF-T9 and SF-T9A	6 in Manual Dual Teleshade cassette with 6 in front fascia. T9A is a pocket version. Dual shades up to 129 in x 110 in for each shade
<input type="checkbox"/>	SF-T4	4 in Manual Teleshade cassette with a Televent bracket. No fascia
<input type="checkbox"/>	SF-T17	4 in Manual Teleshade in a Telepocket – shade size up to 129 in x 110 in
<input type="checkbox"/>	SF-RDxx	Using an RD designation adds room darkening elements to the Teleshade configuration