

# ROOM CONTROL BUNDLES

## LMKT-100 SERIES

Plenum-rated room controller,  
dual tech occupancy sensor  
and wall switch control one or  
two loads

Components plug together  
with LMRJ cables (included)  
eliminating wiring errors

Plug n' Go automatic  
configuration for maximum  
energy efficiency out of the box



Easy-to-use digital controls;  
IR transceivers for optional  
wireless configuration

Occupancy sensor combines  
PIR and ultrasonic for most  
comprehensive coverage

Facilitate code-mandated  
manual-on and bi-level  
lighting control strategies



### DESCRIPTION

The LMKT-101 and LMKT-102 include an LMRC-100 Series Room Controller with one or two relays, an LMDC-100 Dual Technology Ceiling Mount Occupancy Sensor, an LMSW-100 Series Wall Switch with one or two buttons and two LMRJ-25 pre-terminated cables. The bundles provide energy efficient control of one or two lighting loads that meets or exceeds energy code requirements.

### OPERATION

The Room Controller operates on one 120 or 277 volt, 20 amp, feed and provides Class 2 power to the occupancy sensor and switch via the LMRJ cables. Once powered up, Plug n' Go automatically configures the system for the most energy-efficient operation. The LMKT-101 bundle controls one load and self-configures for manual-on/automatic-off operation. The LMKT-102 bundle controls two loads. Plug n' Go configures load one for automatic on and load two for manual-on; both loads turn off automatically. Either system may be reconfigured without the need for tools or a PC.

### DIGITAL SETTINGS & IR COMMUNICATIONS

The occupancy sensor includes a unique, easy-to-access, LCD screen that displays sensor parameters and simplifies changing those parameters. Time delay and sensitivity can be precisely adjusted. Additionally, walk through mode can be activated and detection and retrigger technologies may be changed. Changes are made at the sensor with easy-to-use pushbuttons or via a wireless configuration tool that communicates using a bi-directional infrared (IR) signal and stores up to nine sensor profiles. System parameters, including the operating mode (manual- or auto-on) may be reconfigured using the wireless tool, or via hidden configuration buttons.

### APPLICATIONS

LMKT-101 and LMKT-102 bundles are ideal for single or multiple zone on/off lighting control applications in private offices, open offices, conference rooms, lunch rooms and break rooms in any commercial building or retrofit project. They help contractors comply with the requirements of ASHRAE 90.1, IECC, EAct, California Title 24 or LEED projects, including requirements for bi-level control and manual-on.

### FEATURES

- Plug n' Go™ automatic configuration for quick installation and maximum energy savings
- Room controller features On/Off local override button for each load
- LEDs on switch and room controller indicate status of loads
- Zero-crossing circuitry for reliability and increased product life; each relay rated for 20A
- Occupancy sensor with LCD display and programming pushbuttons behind snap-off cover; 1000' coverage when mounted at 10'
- Switch buttons may be replaced in the field facilitating custom engraving or color change
- Room controller UL2043 plenum rated
- The product meets the materials restrictions of RoHS

PROJECT

LOCATION/  
TYPE

## SPECIFICATIONS

## LMRC-101 and LMRC-102:

- Input/output voltage: 120/277VAC, 50/60Hz
- Maximum 20A combined load per Room Controller; each relay rated for 20A ballast or incandescent or 1HP motor load
- Operating temperature: 32-104°F (0-40°C)

## LMDC-100:

- LCD display and pushbuttons for setting sensor and system parameters
- Infrared (IR) transceiver
- Ultrasonic frequency: 40 kHz
- Operating temperature: 32-104°F (0-40°C)

## LMSW-101 and LMSW-102:

- 1 or 2 buttons, each with LED status indicator
- Hidden configuration button
- Infrared (IR) transceiver
- Operating temperature: 32-131°F (0-55°C)

## All Products:

- For indoor use only; 5-95% RH, non-condensing
- UL and cUL listed
- FCC part 15 compliant
- Five-year warranty

## CONTROLS &amp; DIMENSIONS

## LMRC-100 Room Controllers

Room controllers include a 1/2" (12.7mm) threaded nipple and locking ring. Mount inside or outside a j-box.

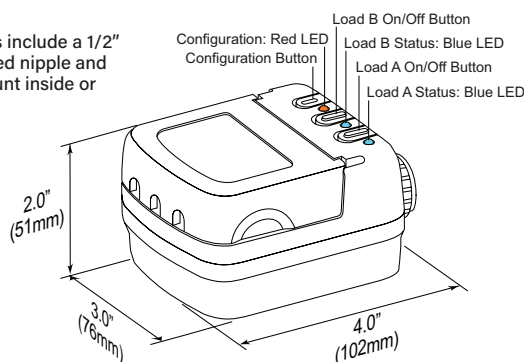

## LMDC-100 Occupancy Sensor

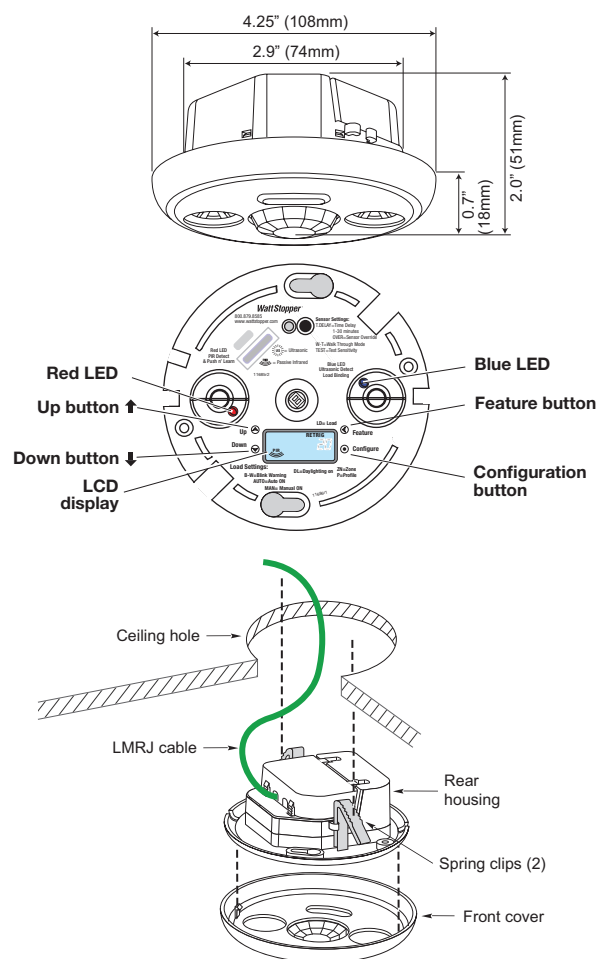

## LMSW-100 Series Wall Switches

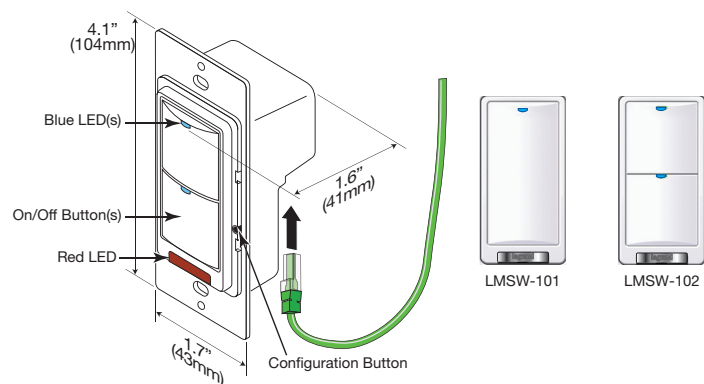

## Sample Connection Diagram for Bi-Level Control Using LMKT-102

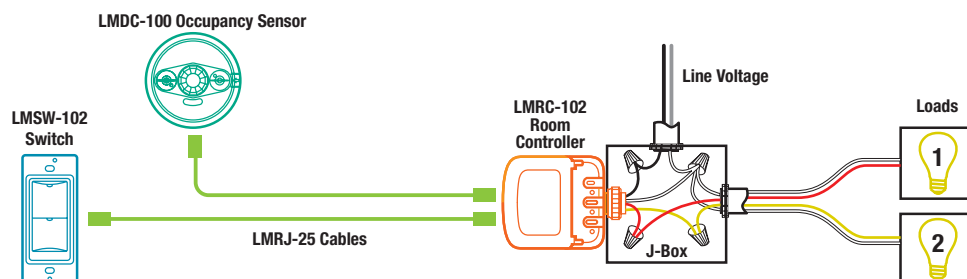

## ORDERING INFORMATION

Catalog #		Description
<input type="checkbox"/>	LMKT-101-W	LMRC-101 Single Relay Room Controller, LMDC-100 Dual Technology Ceiling Mount Occupancy Sensor, LMSW-101-W One-button Switch, (2) LMRJ-25 25' non-plenum rated cables
<input type="checkbox"/>	LMKT-P101-W	LMRC-101 Single Relay Room Controller, LMDC-100 Dual Technology Ceiling Mount Occupancy Sensor, LMSW-101-W One-button Switch, (2) LMRJ-25 25' plenum rated cables
<input type="checkbox"/>	LMKT-102-W	LMRC-102 Dual Relay Room Controller, LMDC-100 Dual Technology Ceiling Mount Occupancy Sensor, LMSW-102-W Two-button Switch, (2) LMRJ-25 25' non-plenum rated cables
<input type="checkbox"/>	LMKT-P102-W	LMRC-102 Dual Relay Room Controller, LMDC-100 Dual Technology Ceiling Mount Occupancy Sensor, LMSW-102-W Two-button Switch, (2) LMRJ-25 25' plenum rated cables

All switches and sensors are white.

Note: Switches do not include face plates. Order decorator style plate separately.