

# HIGH BAY PASSIVE INFRARED OCCUPANCY SENSOR WET LOCATION LENS MODULE

HBLXW



## PRODUCT OVERVIEW

The HBLxW Lens Modules work interchangeably with the HB3x0W series sensor modules for wet locations to provide automatic lighting control in high bay applications. Three different lens modules provide coverage for different applications, facilitating sensor use at various mounting heights and

locations. Each Fresnel lens fits any HB3x0W sensor module, and can be replaced with a different lens when desired. For more information about the sensor modules, refer to the High Bay Wet Location Occupancy Sensor datasheet.

## MODELS

HBL2W Wet Low Bay Lens Module  
HBL3W Wet Mid Bay Lens Module  
HBL7W Wet High Bay Lens Module

## SPECIFICATIONS & FEATURES

Multi-cell, multi-tier Fresnel lenses

Interchangeable lenses

360° coverage

Lens choices for mounting between 8 and 40 feet

Indoor and outdoor use

IP65 rated

Weight: 0.8 oz (22.7 g)

Five year warranty

## MATERIALS

Polycarbonate, flame retardant  
UV resistant  
Impact resistant  
Recyclable  
Meets materials restrictions of RoHS

## DIMENSIONS

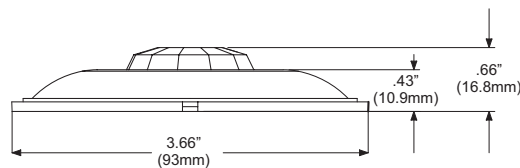
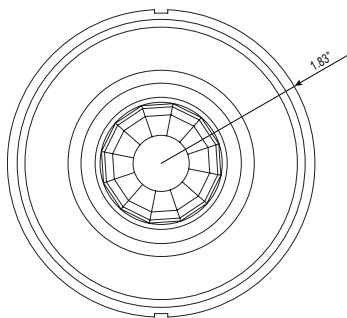

HBL2W and HBL3W dimensions

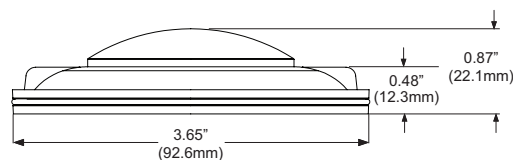
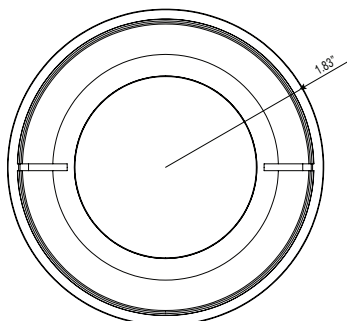

HBL7 dimensions

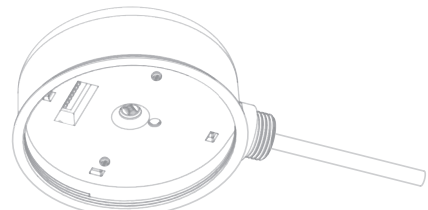

HBLxW (lens module)

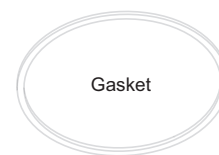
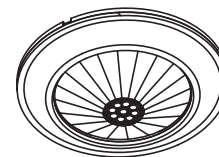

Gasket

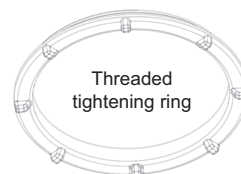

Threaded  
tightening ring

## COVERAGE

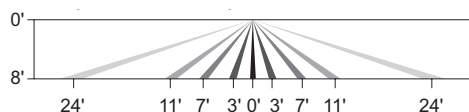

HBL2W side coverage pattern

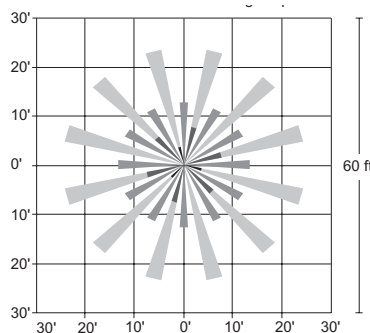

HBL2W top coverage pattern

**Low Bay:** The HBL2W has a high density lens that covers a 48' diameter area from a height of 8'.

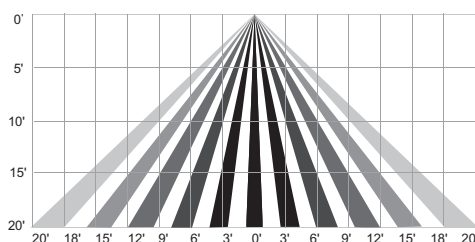
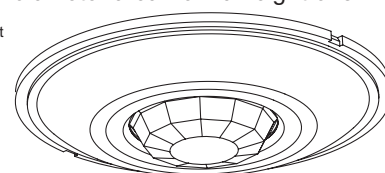

HBL3W side coverage pattern

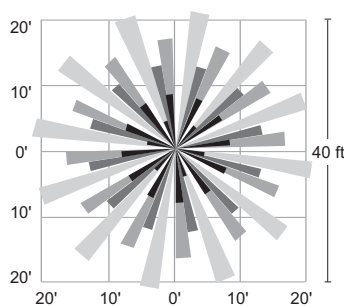

HBL3W top coverage pattern

**Mid Bay:** The HBL3W has a high density lens that covers a 40' diameter area from a height of 20'.

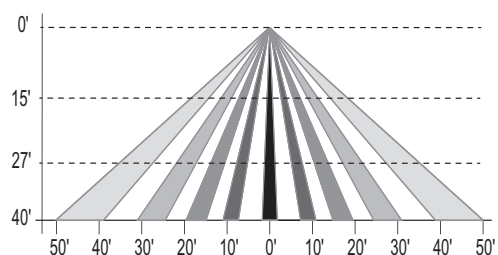
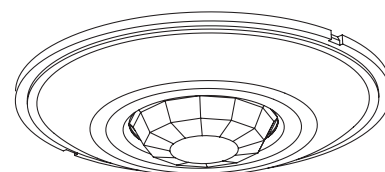

HBL7W side coverage pattern

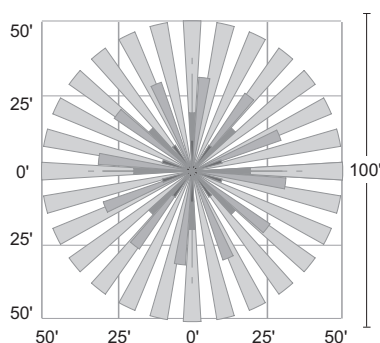

HBL7W top coverage pattern

**High Bay:** The HBL7W is designed for mounting at heights of 40'. Its coverage area can be up to 100' in diameter.

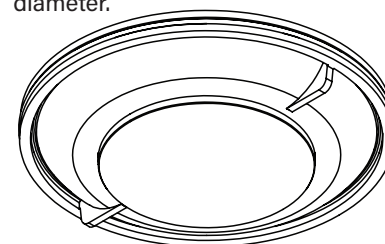

## ORDERING INFORMATION

Catalog #	Master Pack Details			
	Master Pack Quantity	Case dimensions (inches)		
		Length	Width	Height
HBL2W	100	21.2	17.5	15.7
HBL3W	100	21.2	17.5	15.7
HBL7W	100	21.2	17.5	15.7

Inner Pack Details				
Inner Pack Quantity	Case dimensions (inches)			Weight (pounds)
	Length	Width	Height	
50	20.7	8.35	15	5.2
50	20.7	8.35	15	5.2
50	20.7	8.35	15	6.15

Catalog #	Description
<input type="checkbox"/> HBL2W	IP65 Low Bay Lens Module: 48' diameter coverage from 8' height
<input type="checkbox"/> HBL3W	IP65 Low Bay Lens Module: 40' diameter coverage from 20' height
<input type="checkbox"/> HBL7W	IP65 Low Bay Lens Module: 100' diameter coverage from 40' height

Information supplied above is subject to change.  
Harmonization code: 8538908080. Country of origin: China.

25981r1 Rev 09/2021