

Catalog Number • Numéro de Catalogue • Número de Catálogo: LMIR-100

Country of Origin: Made in China • Pays d'origine: Fabriqué en Chine • País de origen: Hecho en China

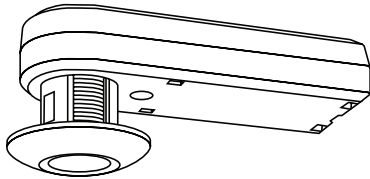

This unit is pre-set for Plug n' Go™ operation, adjustment is optional.

For full operational details, adjustment and more features of the product, see the DLM System Installation Guide provided with Wattstopper room controllers, and also available at www.legrand.us/wattstopper.

Installation shall be in accordance with all applicable regulations, local and NEC codes. Wire connections shall be rated suitable for the wire size (lead and building wiring) employed.

For Class 2 DLM devices and device wiring: To be connected to a Class 2 power source only. Do not reclassify and install as Class 1, or Power and Lighting Wiring.

PLACEMENT GUIDELINES

The LMIR-100 provides an IR remote interface for DLM devices that are not within line of sight of the user. It accepts commands from DLM IR devices such as hand-held remote controls, and forwards them to the DLM Local Network. Choose a place for the LMIR-100 that it is in direct view of the user. Avoid obstruction by objects such as furniture or partitions. It has a 360° 30-35 foot (10m) line of sight receiving range.

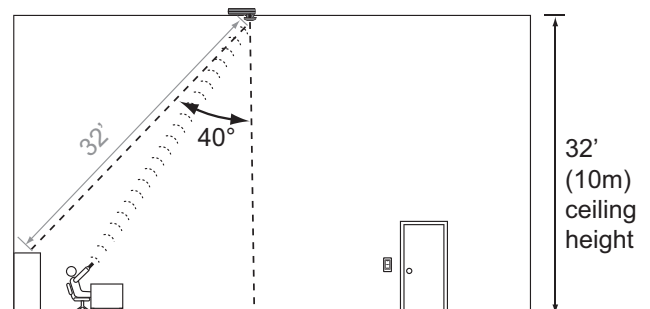

WARNING: DO NOT USE THE DLM SYSTEM TO CONTROL LOADS OTHER THAN LIGHTING IF THE LOAD IS NOT IN VIEW OF A PERSON AT ALL CONTROL LOCATIONS. DO NOT USE DLM TO CONTROL ANY LOAD THAT MIGHT BE DANGEROUS OR CAUSE A HAZARDOUS SITUATION IF ACCIDENTALLY ACTIVATED.

MOUNTING THE RECEIVER

The device has an adjustable head to accommodate multiple mounting methods and building materials or fixture walls up to 5/8" thickness.

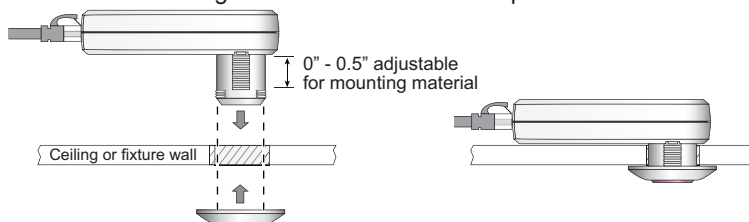
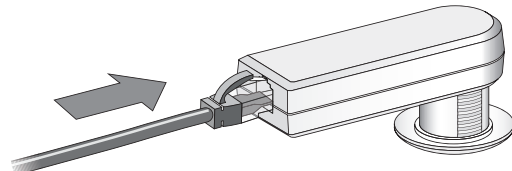
ATTACHING THE LMRJ CABLE

SPECIFICATIONS

Input Voltage 24VDC
Current Consumption 5mA
Power Supply Wattstopper Room Controller
Connection to the DLM Local Network..... 1 RJ-45 port
DLM Local Network characteristics when using LMRC-11x/2xx room controllers:

Low voltage power provided over Cat 5e cable (LMRJ);
max current 800mA. Supports up to 64 load addresses,
48 communicating devices including up to 4 LMRC-10x
series and/or LMPL-101 controllers.

Free topology up to 1,000' max.

Environment For Indoor Use Only

Operating Temperature 32° to 131°F (0° to 55°C)

Storage Temperature 23° to 140°F (-5° to 60°C)

Relative Humidity 5 to 95% (non condensing)

Other:

RoHS compliant

Patent Pending

CONNECTIVITY

The LMIR-100 communicates to all other DLM devices connected to the DLM Local Network. Connection drawings are for example only. The low voltage LMRJ cables can connect to any DLM device with an open RJ45 receptacle.

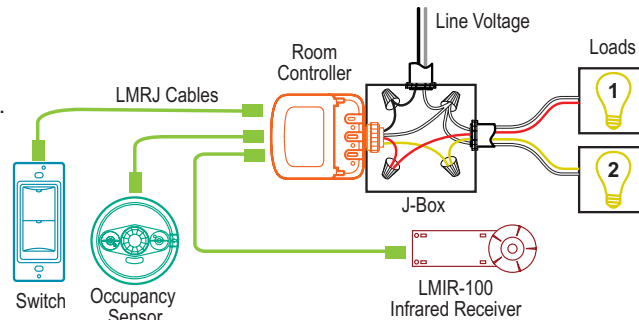

CAUTION: TO CONNECT A COMPUTER TO THE DLM LOCAL NETWORK USE THE LMCI-100. **NEVER CONNECT THE DLM LOCAL NETWORK TO AN ETHERNET PORT – IT MAY DAMAGE COMPUTERS AND OTHER CONNECTED EQUIPMENT.**

OPERATION

The LMIR-100 communicates to all other Lighting Management devices connected to the DLM Local Network. Mount the device and connect it to the DLM Local Network. For use with DLM IR handheld remotes. When the LMIR-100 receives a signal from an IR handheld remote and transmits it on the DLM Local Network, its red LED blinks.

Unit Adjustment

There are no adjustments on the LMIR-100.

Power Up Functionality:

Upon power up the device is ready to receive signals from any of the DLM IR handheld remotes.

TROUBLESHOOTING

Lights do not respond to IR handheld remote as expected.

Red LED on LMIR-100 blinks but load doesn't switch	<ol style="list-style-type: none">1. Make sure nothing is blocking the line of sight between the handheld remote and LMIR-100.2. Check to see that the device is connected to the DLM Local Network.3. Check to see that the IR handheld remote has batteries and that they are good.4. Make sure the system is not in PnL.5. Check load connections to room controllers and/or plug load controllers.
Red LED on LMIR-100 does NOT blink	<ol style="list-style-type: none">1. Check to see that the device is connected to the DLM Local Network.2. Check for 24VDC input to the device: Plug in a different DLM device at the device location. If the device does not power up, 24VDC is not present.<ul style="list-style-type: none">• Check the high voltage connections to the room controller and/or plug load controller.• If high voltage connections are good and high voltage is present, recheck DLM Local Network connections between the device and the room controller and/or plug load controller.
The wrong lights and/or plug loads are controlled	<ol style="list-style-type: none">1. Configure the IR handheld remote to control the desired loads using the Push n' Learn adjustment procedure.

ORDERING INFORMATION

Catalog Number	Description
LMIR-100	Digital IR ceiling mount receiver
LMRH-102	Digital IR handheld 2-button remote control

WARRANTY INFORMATION

Wattstopper warrants its products to be free of defects in materials and workmanship for a period of five (5) years. There are no obligations or liabilities on the part of Wattstopper for consequential damages arising out of, or in connection with, the use or performance of this product or other indirect damages with respect to loss of property, revenue or profit, or cost of removal, installation or reinstallation.

INFORMATIONS RELATIVES À LA GARANTIE

Wattstopper garantit que ses produits sont exempts de défauts de matériaux et de fabrication pour une période de cinq (5) ans. Wattstopper ne peut être tenu responsable de tout dommage consécutif causé par ou lié à l'utilisation ou à la performance de ce produit ou tout autre dommage indirect lié à la perte de propriété, de revenus, ou de profits, ou aux coûts d'enlèvement, d'installation ou de réinstallation.

INFORMACIÓN DE LA GARANTÍA

Wattstopper garantiza que sus productos están libres de defectos en materiales y mano de obra por un período de cinco (5) años. No existen obligaciones ni responsabilidades por parte de Wattstopper por daños consecuentes que se deriven o estén relacionados con el uso o el rendimiento de este producto u otros daños indirectos con respecto a la pérdida de propiedad, renta o ganancias, o al costo de extracción, instalación o reinstalación.