



Convention Center Series Floor Boxes are available in a variety of sizes and configurations to meet the requirements of large volume event facilities.

Large Capacity, Multi-Utility Floor Boxes

Convention Center Series Floor Boxes are an industry leading solution for providing multiple utilities and services directly to the show room. CCFB Series Convention Center Floor Boxes are designed to accommodate power, communications, A/V devices, as well as plumbing for water and compressed air; all in one product.

Convention Center Series Floor Box applications include: exhibition halls, hotels, casinos, ballrooms, arenas, stadiums and performing arts facilities. These products are also recommended for use at universities, military facilities and auto dealerships.

Features & Benefits

- **Designed to the customer's specifications.** Interior layouts and compartments are specifically designed to meet the application needs of the user.
- **Cover designed to meet heavy load requirements.** Cast aluminum cover provides strength and ease of use. Designed to meet 32,000 lb. load on 1" x 16" footprint with a safety factor of two (64,000 lbs).
- **Power and low voltage devices supplied.** 140 amp, 100 amp, 60 amp, 30 amp, and 20 amp devices available. Connectivity products can also be factory installed.
- **Factory prewired.** Can be factory wired with power distribution blocks, circuit breakers, and power devices so that power is split from a single supply circuit.
- **Simplified installation.** Box is supplied with punched conduit entry locations (holes or knockouts) and brackets as needed for mounting the box slab on grade. If ordered prewired, the only required electrical connections are at the distribution blocks.
- **Utilities.** Drains are supplied in required sizes up to 4" [102mm] in diameter. Water, compressed air assemblies and drains are standard.
- **Corrosion resistant.** Box bases are constructed of 14 gauge G90 galvanized steel, painted with fusion bonded "rebar" Epoxy Powder Coat. Stainless steel boxes also available.
- **Safety.** Covers rotate 180 degrees to rest on adjacent floor, eliminating accidental closure. Covers are equipped with a built-in handle to facilitate opening and closing operations.
- **NAFTA compliant.** Meets North America Free Trade Act requirements.
- **TopGuard™ Protection.** Integral design component that prevents water, dirt, and debris from entering power and communication compartments. Meets and exceeds all UL scrub water exclusion requirements for tile and carpet floors.
- **UL Listed to U.S. and Canadian Safety Standards.** File E317375, Guide AUUZ, Commercial Appliance Outlet Center.



Protection from
water, dirt, and
debris.

CCFB Series Convention Center Floor Box Covers are available in a flush non-skid finish and carpet recessed versions.



Convention Center Floor Box isometric view.



Convention Center Floor Box water and compressed air compartment.



Convention Center Floor Box Large/Small Cover Assembly top view.

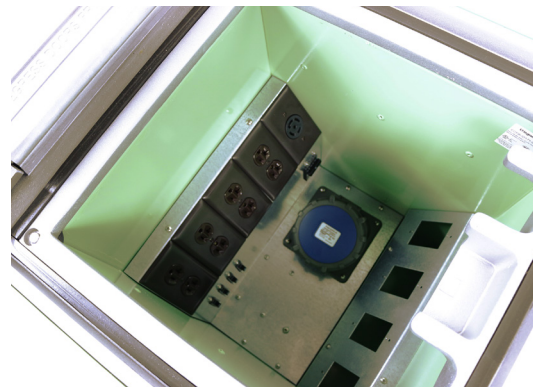

Convention Center Floor Box wiring compartment.



Convention Center Floor Box side view with covers open.

Ordering Information

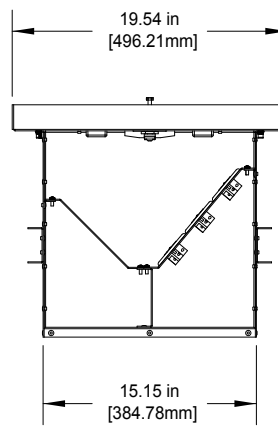
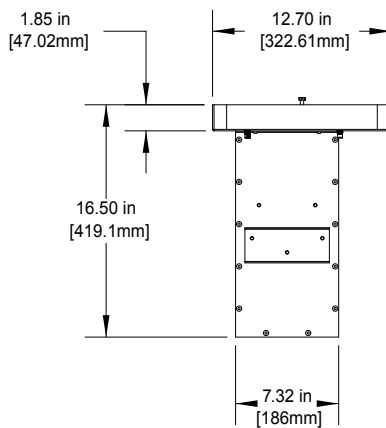
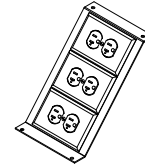
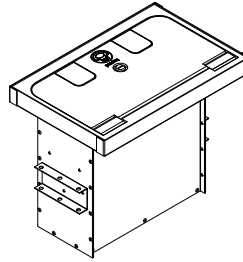
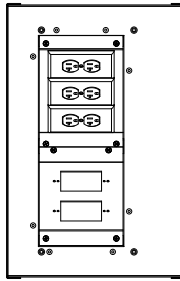

Type S Box – Uses one C1 cover available in both non-skid and carpet recess.

CCFBC-NS-H-C1 (QTY: 1) Non-skid

or

CCFBC-CR-H-C1 (QTY: 1) Carpet recess

Cover Assembly – Cast aluminum cover assembly
Available in non-skid tread finish or with carpet cutout area.
Designed to meet loads up to 64,000 lbs.

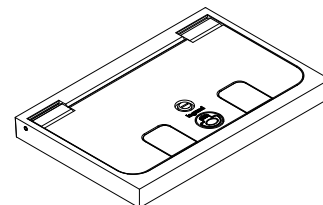
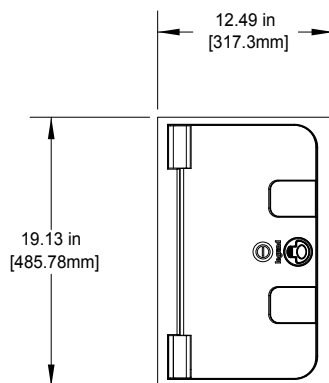

Ordering Information

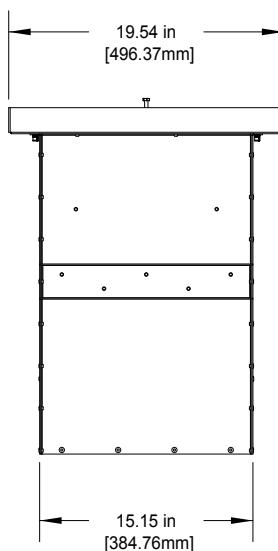
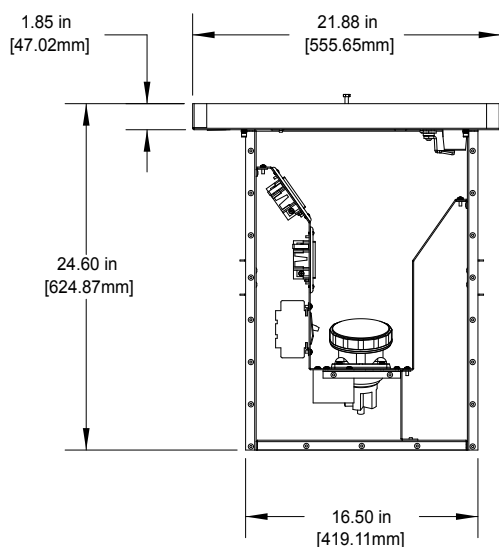
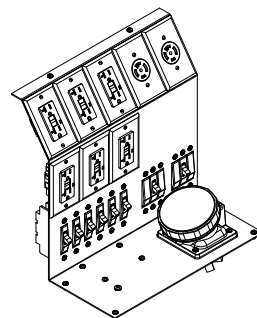
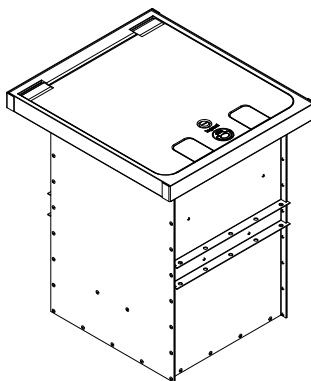
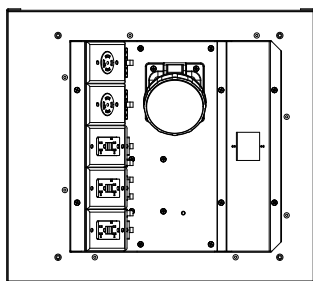

Type L Box - Uses one C2 cover available in both non-skid and carpet recess.

CCFBC-NS-H-C2 (QTY: 1) Non-skid

or

CCFBC-CR-H-C2 (QTY: 1) Carpet recess

Cover Assembly - Cast aluminum cover assembly. Available in non-skid tread finish or with carpet cutout area. Designed to meet loads up to 64,000 lbs.

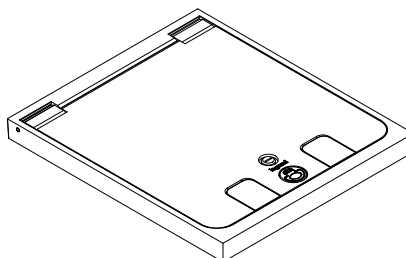
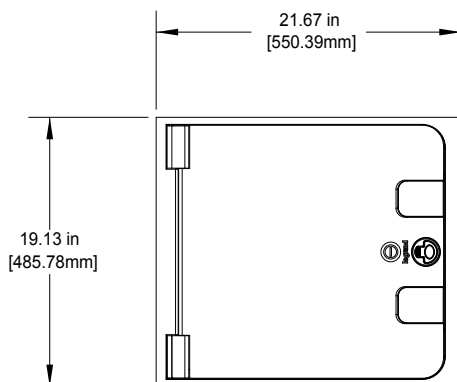

Ordering Information

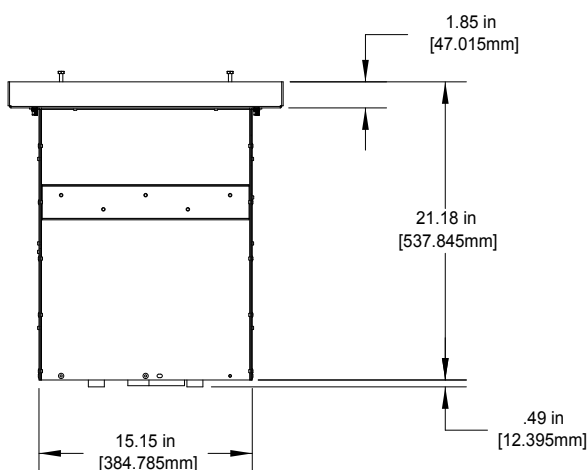
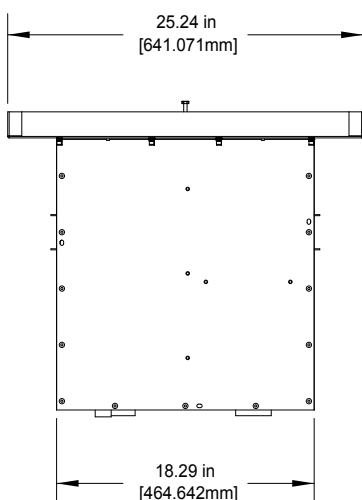
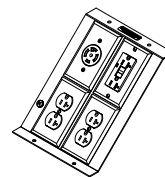
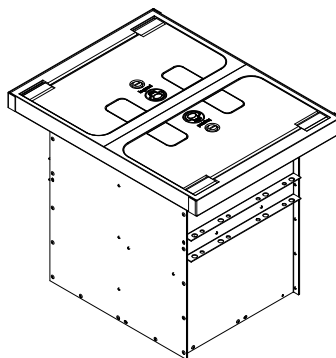
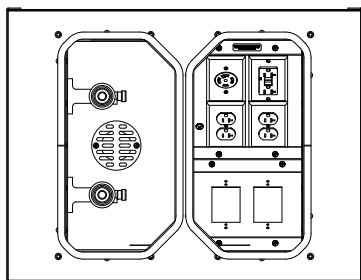

Type SS Box – Uses two C1 covers available in both non-skid and carpet recess.

CCFBC-NS-H-C1 (QTY: 2) Non-skid

or

CCFBC-CR-H-C1 (QTY: 2) Carpet recess

Cover Assembly – Cast aluminum cover assembly. Available in non-skid tread finish or with carpet cutout area. Designed to meet loads up to 64,000 lbs.

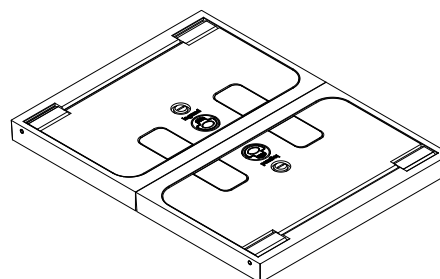
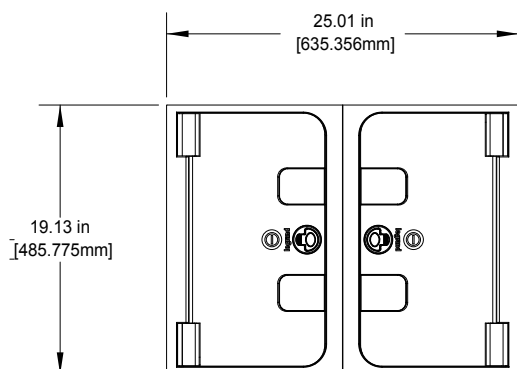

Ordering Information

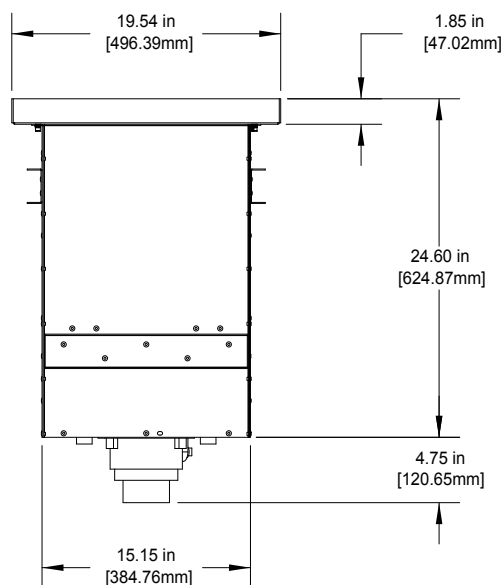
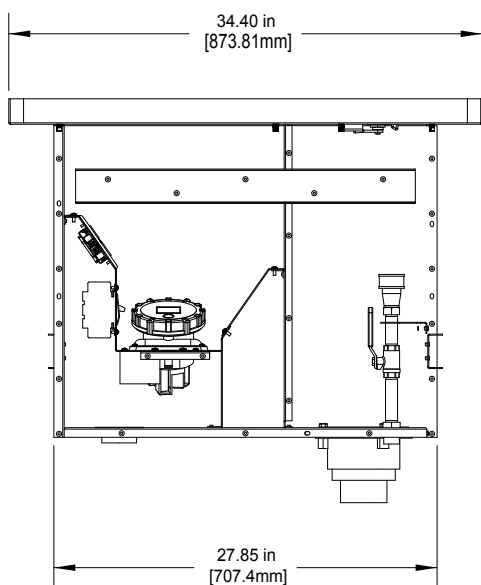
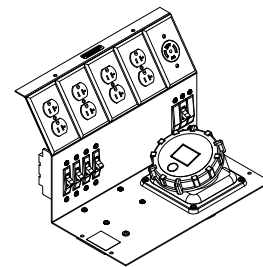
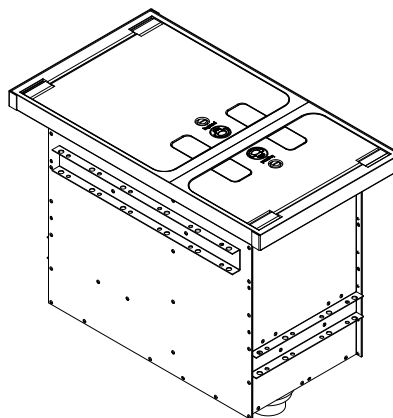
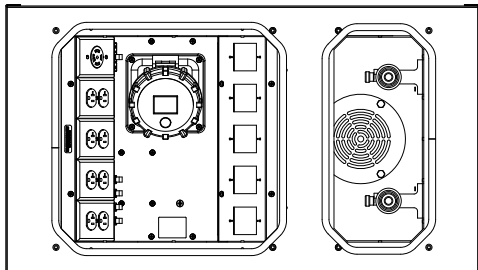

Type LS Box – Uses one C1 and one C2 cover available in both non-skid and carpet recess.

CCFBC-NS-H-C1 (QTY: 1) Non-skid

CCFBC-NS-H-C2 (QTY: 1) Non-skid

or

CCFBC-CR-H-C1 (QTY: 1) Carpet recess

CCFBC-CR-H-C2 (QTY: 1) Carpet recess

Cover Assembly – Cast aluminum cover assembly.

Available in non-skid tread finish or with carpet cutout area. Designed to meet loads up to 64,000 lbs.

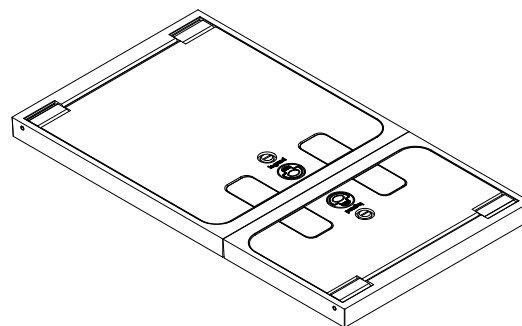
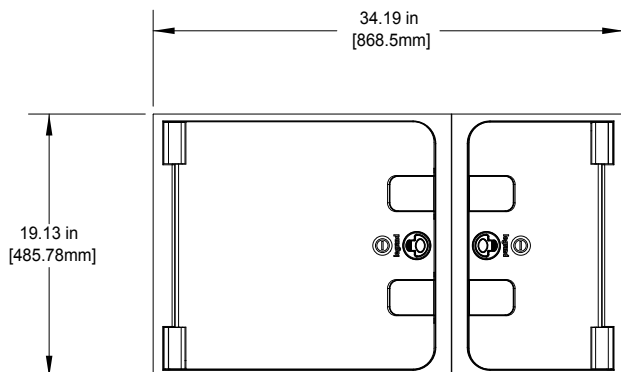

Ordering Information

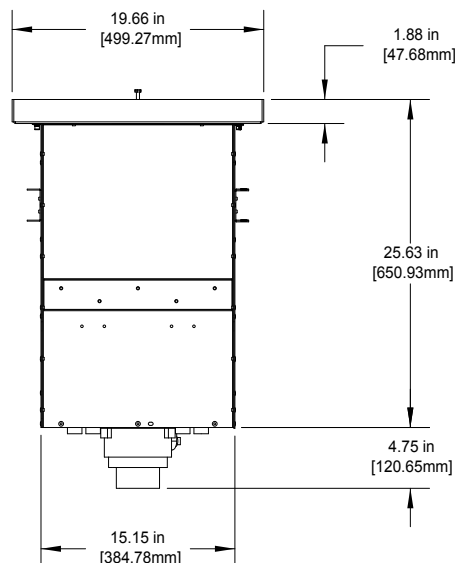
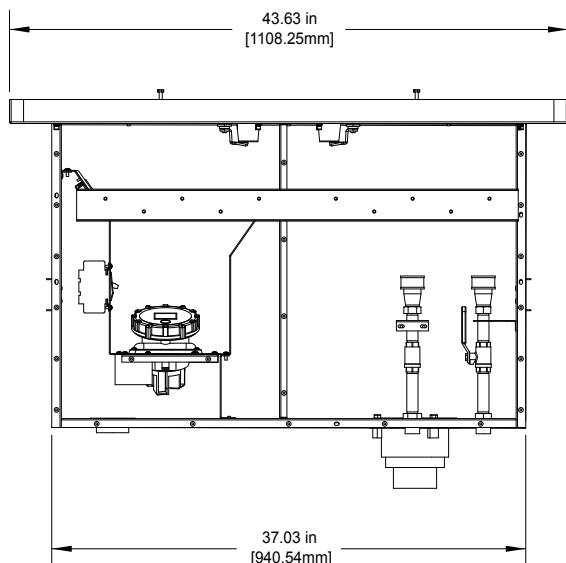
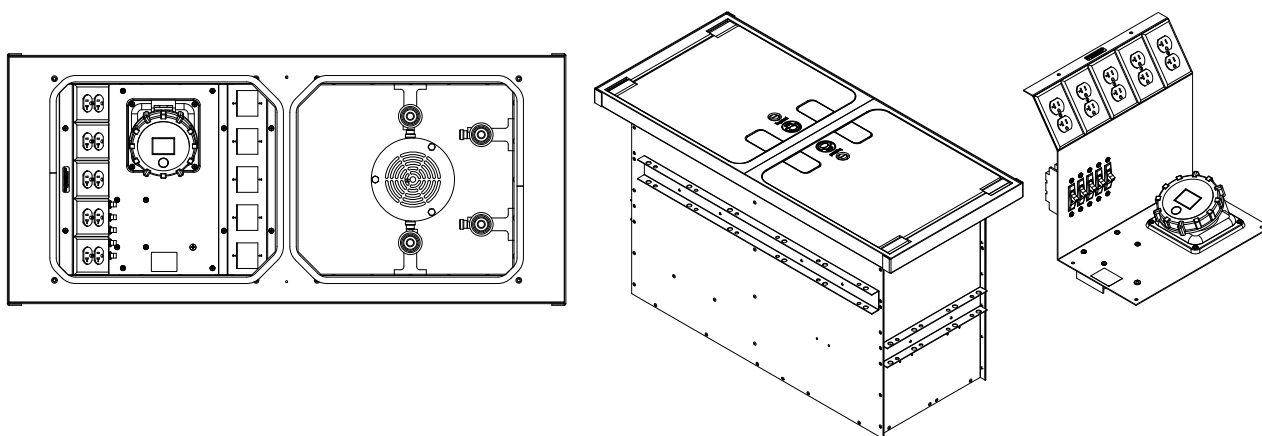

Type LL Box - Uses two C2 covers available in both non-skid and carpet recess.

CCFBC-NS-H-C2 (QTY: 2) Non-skid

or

CCFBC-CR-H-C2 (QTY: 2) Carpet recess

Cover Assembly - Cast aluminum cover assembly. Available in non-skid tread finish or with carpet cutout area. Designed in non-skid tread finish or with carpet cutout area. Designed to meet loads up to 64,000 lbs.

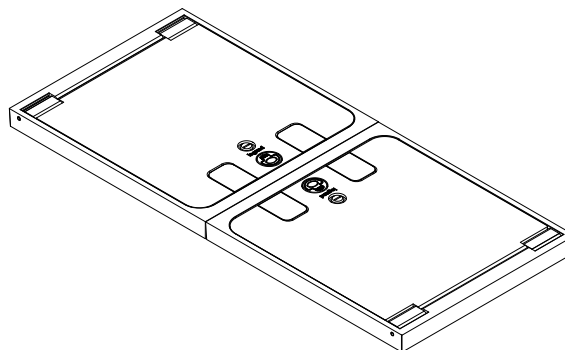
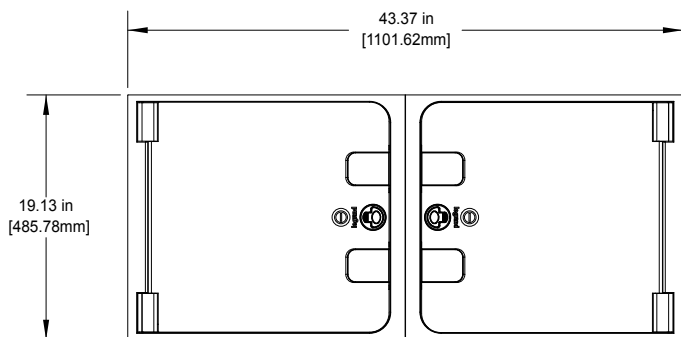

Ordering Information

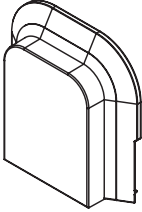
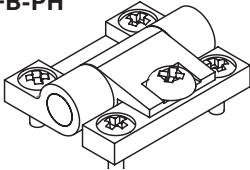
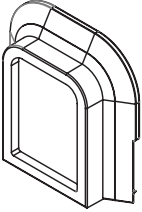
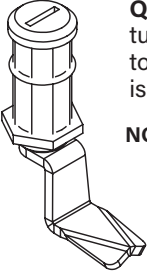
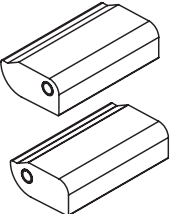
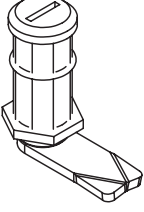
Catalog No./Item	Description/Specifications	Catalog No./Item	Description/Specifications
CCFB-EBCH	Checked Egress Block - Replacement egress blocks with a diamond plate checkered pattern. Includes two egress blocks and hinges. 	CCFB-PH	Egress Hinge - Replacement egress hinges. Includes two (2) hinges. 
CCFB-EBCI	Carpet Insert Egress Block - Replacement egress blocks with carpet. Includes two egress blocks and hinges. 	CCFB-QT001	Quarter Turn Latch - Quarter turn latch assembly allows cover to be secured down when cover is in closed position.  NOTE: Use with L (C2), LL (C5) and LS (C4) floor boxes.
CCFB-HB	Hinge Block Assembly - Replacement cover hinges. Includes a left and right hinge. 	CCFB-QT002	Quarter Turn Latch - Quarter turn latch assembly allows cover to be secured down when cover is in closed position.  NOTE: Use with S (C1) and SS (C3) floor boxes.

PPDU Series Portable Power Distribution Units Ordering Information

Catalog No./Item	Description/Specifications
PPDU-620	<p>Power Distribution Unit - Designed to supply power to an exhibition hall. Available in a painted steel enclosure with six (6) GFCI (20A/120V) duplex receptacles, and six (6) single pole 20A, circuit breakers.</p>  <div> ELECTRICAL RATING <ul style="list-style-type: none"> Type 1 Input: 30A, Three Phase 120/208V Output: 20A per Receptacle, Single Phase 120VAC </div>

NOTE: All brand and product names referenced in this document are registered trademarks or trademarks of their respective holders.



Legrand, North America
60 Woodlawn Street
West Hartford, CT 06110
1.844.977.3783
www.legrand.us

Canada
1.844.977.3783
www.legrand.ca

