



Wiremold

PK Preset Activation Kit

INSTALLATION INSTRUCTIONS

Installation Instruction No.: 1 002 300R1 – Updated March 2010

Wiremold electrical systems conform to and should be properly grounded in compliance with requirements of the current National Electrical Code or codes administered by local authorities.

All electrical products may present a possible shock or fire hazard if improperly installed or used. Wiremold electrical products may bear the mark as UL Listed and/or Classified and should be installed in conformance with current local and/or the National Electrical Code.

IMPORTANT: Please read all instructions before beginning.

Products Covered: WPACR, PKGRBR, and DTB Communication Brackets

Preset Location:

1. Determine location of preset cover by measuring (when layout is known) or by using an electronic preset finder.
2. Cut or remove floor covering over preset location.
3. Using a hammer, remove the concrete from mudcap cover.
4. Remove the mudcap by hitting the center of the cap until the sides are deformed.
5. Insert a screwdriver along the edge of the cap and pry up.
6. Remove any debris that may have fallen into the preset opening.

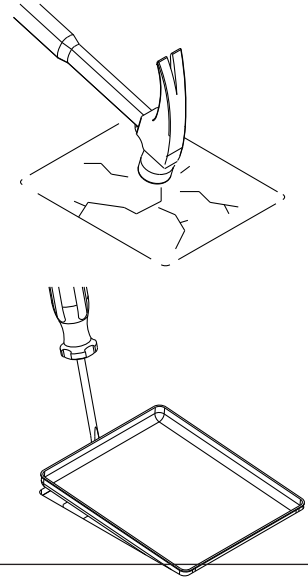

Power Installation:

1. Remove knockout from power compartment. Grommets must be installed prior to pulling cables and before internal components are installed to prevent damage to cables.
2. Place one side of the two-piece grommet over the power opening and squeeze until it snaps into place. Repeat for the other piece of the grommet.
3. Install the second set of grommets if activating both sides of the preset with power.
4. Pull the electrical wires through the grommeted openings in the center cell.
5. Attach electrical conductors to the UL Listed duplex receptacle(s). Make sure that any ground leads are connected to ground screws.
6. Attach the receptacle insulator and receptacle to the receptacle mounting bracket using #6 screw provided. Attach the receptacle to the receptacle mounting bracket with two additional screws and nuts (not provided). Attach the outlet box cover to the preset using two #10 mounting screws provided.

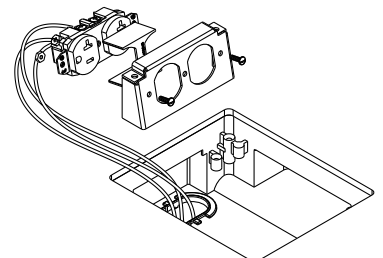
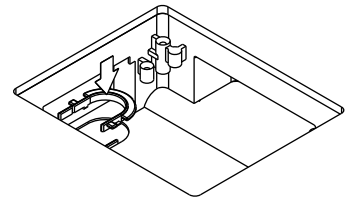

Communication Installation:

1. Align communication grommet so the letters "FRONT" are facing toward you.

NOTE: Do not install grommets if using communication brackets Cat. Nos. DTB-2-2AB or DTB-2-2RT.

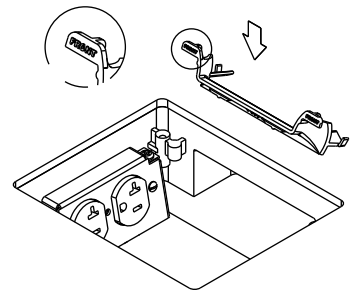

2. Squeeze the legs of the grommet together and place into the preset opening.
3. Insert the grommet and press downward until the legs snap into position.
4. Push forward until the bottom of the grommet snaps onto the edge of the metal raceway.

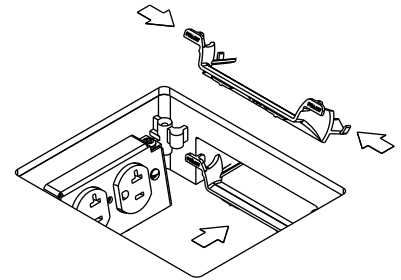

5. Remove two mounting screws from the receptacle brackets inside the preset.
6. Pull communication cables and insert through bracket opening.
7. Wire communication devices and snap into bracket opening.

NOTE: Wire clips on the back of Cat. No. DTB-2-2A can be used for excess cable storage. Be sure to maintain a generous radius when wrapping cable, approximately 1" to 1 1/4" [25mm to 32mm].

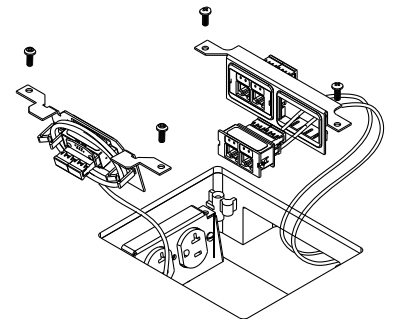

8. Install communication bracket using two mounting screws from the receptacle brackets.
9. For partition feed communications (Cat. No. DTB-FP), install the bracket in place of the receptacle bracket.

NOTE: Do not remove the power compartment knockout for partition feed bracket.

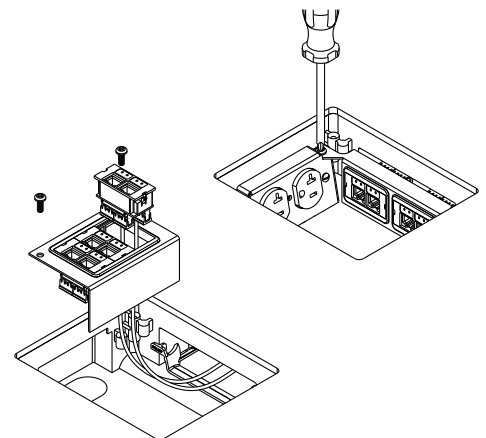

Wiremold

Wiremold

U.S. and International:

60 Woodlawn Street • West Hartford, CT 06110
1-800-621-0049 • FAX 860-232-2062 • Outside U.S.: 860-233-6251

Canada:

570 Applewood Crescent • Vaughan, Ontario L4K 4B4
1-800-723-5175 • FAX 905-738-9721

