

## BACK FEEDING FROM FLEXIBLE OR RIGID METAL CONDUIT

Cut hot, neutral, and ground wires of V2400 Raceway Harness at location of raceway base entrance knockout that will be removed.

Remove 1/2" entrance knockout from base and attach 1/2" feed connector (not supplied).

Mount raceway base with harness using # 10 Panhead screws.

Connect harness to feed wires using one of the approved wiring methods shown above in Step 2A or 2B.

### W30 WIRE CONNECTORS – HOW TO USE

W30 pressure type connectors (available separately) are for common connection of 2, 3, or 4 No. 12 or No. 14 solid conductors.

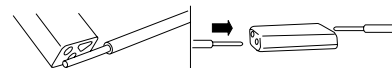

**NOT TO BE USED TO CONNECT GROUNDING CONDUCTORS.**

## COUPLING TWO PLUGMOLD V2400 WIRED SECTIONS TOGETHER TO EXTEND RUN (USING 2401 COUPLING)

Insert 2401 Coupling halfway into the end of raceway base. Mount raceway using No. 10 Panhead screws.

Insert second raceway base section onto the opposite end of the 2401 Coupling. Mount second raceway section with #10 Panhead or Flathead wood screws.

Connect black and white harness wires to black and white feed wires with W30 Wire Connectors\* inserting only conductors of same color in a connector. See "W30 Wire Connectors...How To Use". Connect green grounding wire in harness to insulated ground conductor in-feed which is connected directly to service grounding terminal, using insulated method approved for equipment grounding connections.

**Do not use W30 Wire Connector for this purpose.**

Close up unused wire leads at ends of harness as shown. **Do not connect leads together.**

Close up lead ends using approved method.

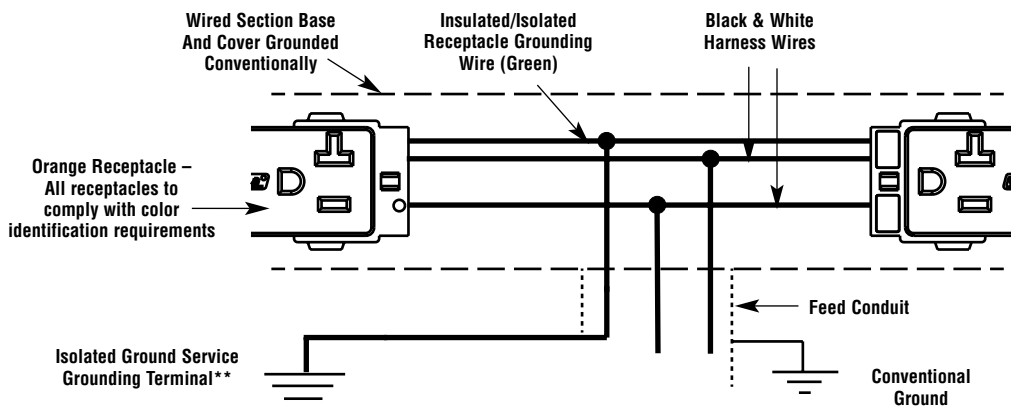
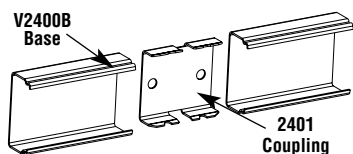
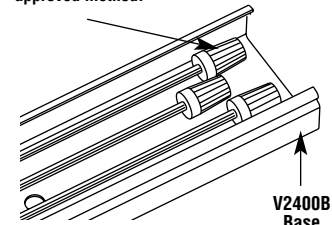

TYPICAL FEED CONNECTION DIAGRAM

\*\*See 2002 NEC, Section 250.96(B)

**CAUTION:** Green insulated/isolated grounding conductor in receptacle harness must be connected directly to service grounding terminal through insulated grounding conductor in-feed. Grounding circuit will not be isolated if green harness conductor is connected to Wired Section raceway. Since unit is not grounded through mounting, a separate grounding conductor connection is required.

To preserve insulated/isolated grounding, insulated ground wire in-feed must be connected to service grounding terminal, NOT to panel.

## FEEDING WIRED SECTIONS FROM NONMETALLIC-SHEATHED CABLE

Connect feed (black & white wires, and insulated ground wire which is connected directly to service grounding terminal) to Wired Section harness. Connect bare (conventional) ground wire to 2409 Ground Clamp (available separately).

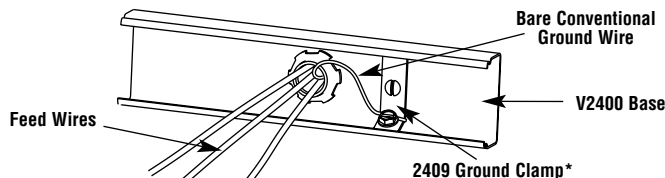

\*Available separately

### 2400 RACEWAY WIRE FILL CAPACITY FOR POWER

WIRE SIZE THHN/THWN	O. D.		NUMBER OF CONDUCTORS (40% FILL)	
	Inches	[mm]	WITHOUT Devices	WITH Plugmold Receptacles
14 AWG	0.111	[2.6]	57	–
12 AWG	0.130	[3.3]	41	10
10 AWG	0.164	[4.2]	26	6



The Wiremold Company

U.S. and International:

60 Woodlawn Street • West Hartford, CT 06110

1-800-621-0049 • FAX 860-232-2062 • Outside U.S. 860-233-6251

Canada:

850 Gartshore Street • Fergus, Ontario N1M 2W8

1-800-741-7957 • FAX 519-843-5980



Wiremold Electrical Systems conform to and should be installed and properly grounded in compliance with requirements of the current National Electrical Code, Canadian Electrical Code or codes administered by local authorities.

All electrical products may represent possible shock or fire hazard if improperly installed or used. Wiremold electrical products are UL Listed, made for interior use only, and should be installed in conformance with current local and/or the National Electrical Code.

Los Sistemas Eléctricos Wiremold cumplen con los requisitos del Código Nacional Eléctrico, el Código Canadiense Eléctrico o los códigos vigentes administrados por autoridades locales, así mismo deben instalarse y conectarse a tierra en la forma debida siguiendo los requisitos de los códigos antes mencionados.

Todos los productos eléctricos pueden provocar posibles choques o peligros de incendio si se instalan o usan de manera indebida. Los productos eléctricos Wiremold están registrados bajo el cUL, se fabrican sólo para uso en interiores y deben instalarse de acuerdo con el Código Nacional Eléctrico y cualquier otro código vigente.

Les Systèmes électriques Wiremold se conforment aux versions actuelles du Code national de l'électricité, du Code canadien de l'électricité ou des règlements par les autorités locales, et doivent être installés et correctement mis à la terre les exigences du code approprié.

Tout produit électrique peut présenter un danger de choc électrique ou d'incendie s'il n'est pas installé ou utilisé correctement. Les produits électriques de Wiremold sont répertoriés par les Laboratoires des Assureurs du Canada (LAC), ne sont destinés qu'à l'usage intérieur et doivent être installés conformément aux versions actuelles des règlements locaux et/ou du Code national de l'électricité.

# 24S PLUGMOLD®

## RACEWAY & MULTIOUTLET SYSTEM WITH INSULATED/ISOLATED GROUNDING RECEPTACLES

### INSTALLATION INSTRUCTIONS

#### PARTS INCLUDED:

**V2400B Base Section** (1 ea.) with insulated/isolated grounding type receptacles rated 20A, 125V, prewired with No. 12 type THHN conductors and snapped into base

**V2400C Cover Section** (1 ea.)

**2401 Coupling** (1 ea.)

**V2410B Blank End Fitting** (2 ea.) (not shown)

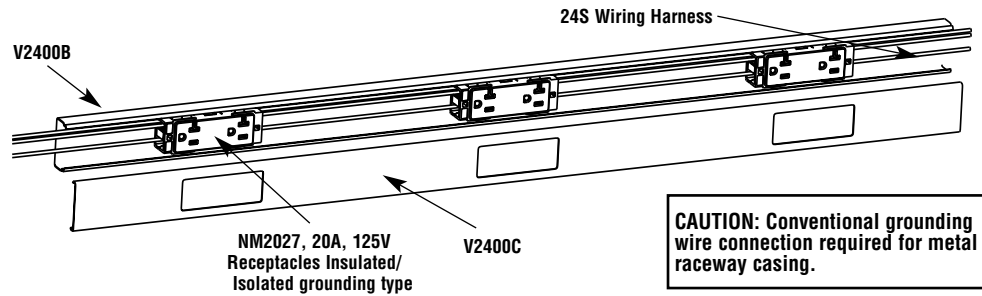

**CAUTION: Conventional grounding wire connection required for metal raceway casing.**

#### RECOMMENDED INSTALLATION STEPS

1. Layout raceway path on mounting surface.
2. Locate power feed point, then install raceway base & harness (see installation instructions that follow).
3. Wire according to instructions.
4. Install raceway covers. If any cuts are necessary, hold raceway cover up against mounted raceway base/harness so that receptacle holecuts match with receptacles. Mark cover and cut.

5. Install fitting covers last over raceway covers (excluding 2410A Entrance End Cover).

**NOTE: FOR EASE OF INSTALLATION AT CORNERS** – Cut out any receptacle within 4" [102mm] of wall corner. This will allow sufficient space within raceway for wire connections where two runs meet. Cut a blank raceway cover piece to fit over any exposed area, if necessary.

#### FEED METHODS

Units may be end-fed as in Step 1A, through V2410A Entrance End Fitting or back-fed as in Step 2A or 2B through the 1/2" entrance knockouts in base.

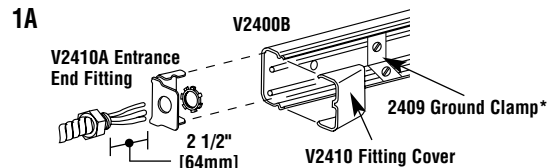

#### END FEEDING FROM FLEXIBLE OR RIGID METAL CONDUIT (Using V2410A Entrance End Fitting)

Mount V2400 Base and Harness on surface with #10 Panhead screws. Insert V2410A Entrance End Fitting Base (available separately) into end of V2400B Raceway Base. Assemble 1/2" connector (not supplied) in V2410A and bring in-feed cable with wires extending at least 2 1/2" [64mm] beyond connector.

Connect green grounding wire in harness to insulated ground wire in-feed which is connected directly to service grounding terminal. Connect black and white harness wires to black and white feed wires with W30 Wire Connectors (available separately) inserting only conductors of same color in a connector. See "W30 Wire Connectors... How to Use." **Do not use W30 Wire Connectors with ground wires.** Any unused wire leads must be individually closed up with a wire nut.

**Do not connect unused leads together.**

Snap V2410A Fitting Cover onto raceway base. Cut raceway cover to fit and snap onto raceway base.

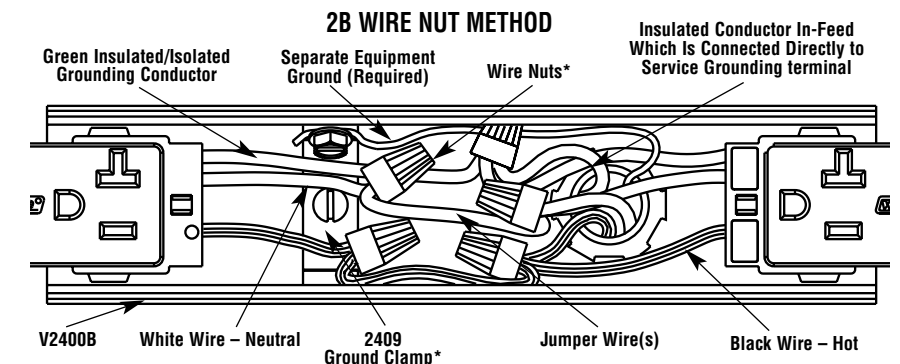
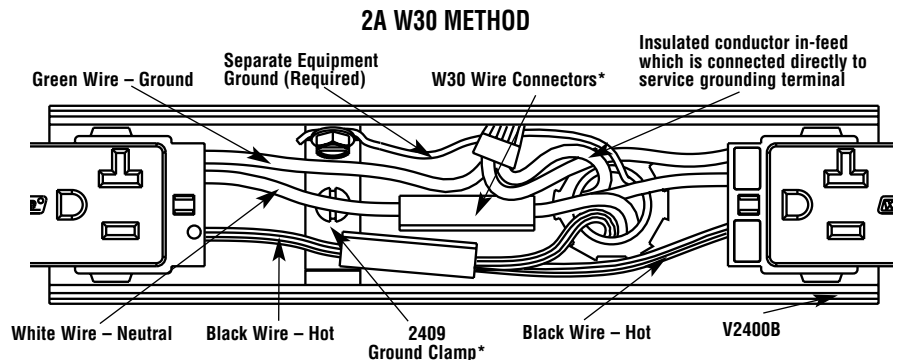

\*Available separately