

Kitchen Planner

adorne™ Under-Cabinet Lighting System

The adorne Under-Cabinet Lighting System is a fully customizable and modular solution for providing power, lighting and music. It is compatible with any kitchen layout, as well as with any home wiring. In order to ensure you select the correct products for your system, we recommend you follow the simple steps in this planning guide before you use the configurator to build your system.

STEP 1: Sketch your kitchen

Use the grid sheet provided on Page 2 to sketch your kitchen. Begin by sketching the outline of your kitchen, indicating the walls, then indicate the windows, doors, cabinets, major appliances, sinks and other fixed features. It is not necessary to sketch each individual cabinet, only cabinet sections. Label your cabinet sections. See example at right.

STEP 2: Decide where you want to install the system

Regardless of the configuration of your kitchen, the layout likely includes individual cabinet sections that are either L-shaped or I-shaped. Consider each continuous run of cabinets as an individual section. Review your kitchen layout and determine under which cabinet sections you wish to install the system. Indicate this on your drawing.

STEP 3: Measure your cabinet sections

When measuring, we recommend you start at one corner of your kitchen and work clockwise. Measure the underside of each cabinet length at the back of the cabinet until you reach a break such as a window, appliance, or archway/door. Measure in inches. For L-shaped cabinet sections you should have two measurements, for I-shaped one measurement. Record measurements for each section on your kitchen drawing.

STEP 4: Record your cabinet information

Use Page 3 of this guide to record the names of the cabinet sections under which you wish to install the system, the cabinet section shape, and the measurements.

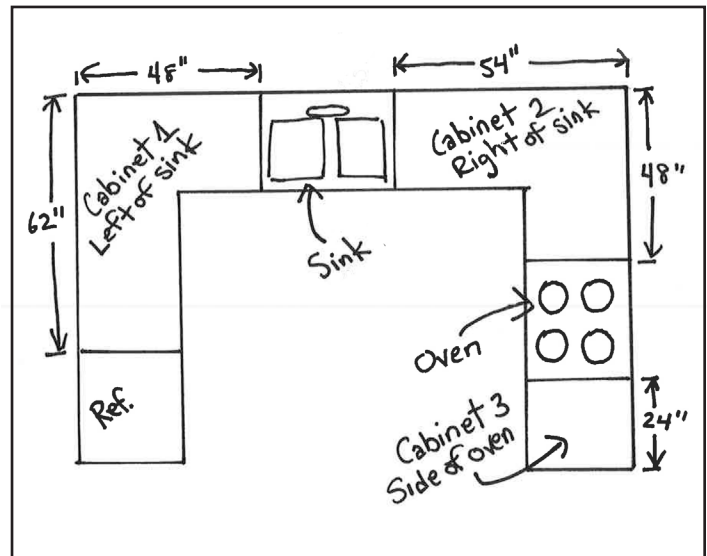

Example: Sketch of typical 'U-shaped' kitchen, indicating cabinet sections and measurements, as well as location of appliances and sink.

STEP 5: Configure your system

Now that you have a layout of your kitchen, and measurements of the cabinet sections where you want to install the system, you are ready to select and configure your system using the adorne Under-Cabinet Lighting System Configurator.

Go to <http://www.legrand.us/adorne/select/under-cabinet-configurator.aspx> to get started.

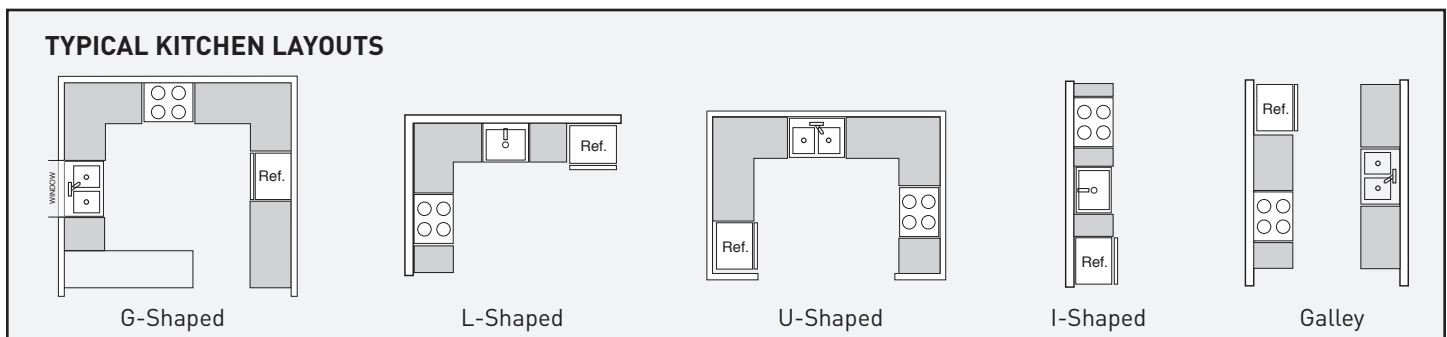

Kitchen Layout Grid

Use this grid to sketch your kitchen layout. Scale 1/2 in. (2 squares) = 1 ft.

