

VERTICAL ELBOW DIVIDERS

DIV | [Cablofil](#)

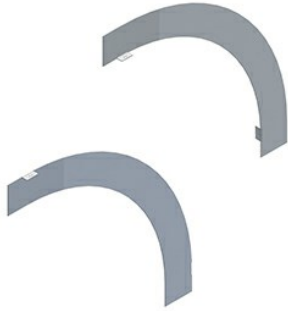

FEATURES & BENEFITS

The aluminum I-beam design of ITray is perfect for industrial installations with large diameter cables in long span situations, minimizing total tray width and creating a smooth transition between straight sections and fittings. A structural offset in the sidewall creates strong, mid-span splices that need fewer supports. Each splice snaps in place and stays without holding. Additionally, only four bolts are needed for each splice reducing hardware needs by 50%. These features allow Itray to be installed up to 30% faster than standard tray.

- Material: Aluminum
- Each divider includes two self-drilling screws

SPECIFICATIONS

GENERAL INFO

Product Series: Itray
Type: Accessories

CONSTRUCTION INFORMATION

Material 1: Aluminum