

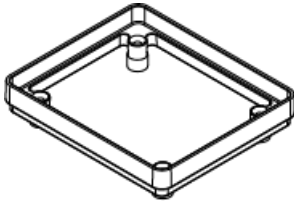

Wiremold
PSRC9 Series Extension
Part No. 425



1/2" (12mm) high extension. Used to increase height of preset or afterset. Die cast construction. Attach to preset or afterset with push on metal sleeves (included). Cannot be stacked.

Features & Benefits

1/2" (12mm) high extension. Used to increase height of preset or afterset. Die cast construction. Attach to preset or afterset with push on metal sleeves (included). Cannot be stacked.

Specifications

General Info

Product Line	Wiremold	UPC Number	786564543930
Country Of Origin	United States	Construction	Not Assembled
Application Sector	Commercial	Standard	cULus Listed Underfloor Raceway Fittings: File E11912 Guide RQKX Meets Articles 390 of NEC

Dimensions

Product Weight US	0.176 lb	Product Depth US	0.5 in
-------------------	----------	------------------	--------

Listing Agencies / 3rd Party Agencies

cULus ListingNumber	E11912	cULus Listed	Yes
---------------------	--------	--------------	-----

Trade Programs

USMCA	Yes
-------	-----

Additional Information

RoHS Compliant	Yes
----------------	-----