

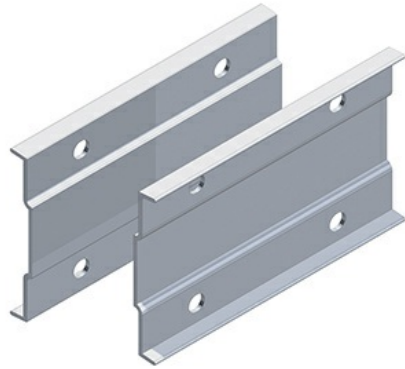

Cablofil

4A-FSP-GE 4H FITTING SPLICE KIT (TRA)

Part No. P300000



The aluminum I-beam design of ITray is perfect for industrial installations with large diameter cables in long span situations, minimizing total tray width and creating a smooth transition between straight sections and fittings. A structural offset in the sidewall creates strong, mid-span splices that need fewer supports. Each splice snaps in place and stays without holding. Additionally, only four bolts are needed for each splice reducing hardware needs by 50%. These features allow Itray to be installed up to 30% faster than standard tray.

Features & Benefits

Material: Aluminum Alloy 6063 - t6

Finish: Plain

Height (H): Tray height: 4", 5", 6", 7"

Torque: 19 - 25 ft-lbs

Specifications

General Info

UPC Number	800388200111	Country Of Origin	Mexico
Product Line	Cablofil	Finish	Aluminum
Application Sector	Commercial/Industrial	Type	Cable Tray
Standard	UL Classified		

Dimensions

Product Volume US	0.028 cu ft	Product Width US	2.02 in
Product Height US	6.0 in	Product Weight US	0.829 lb
Product Depth US	4.023 in		

Buy American Act Compliance

BAA	Yes
-----	-----