

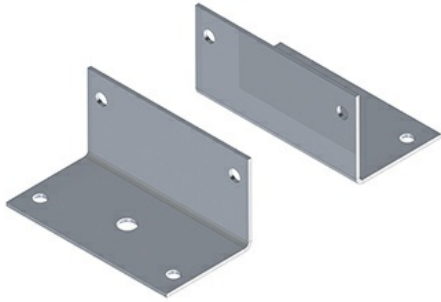

**Cablofil**  
**Floor Flange Splice Kit**  
Part No. P314177



The aluminum I-beam design of ITray is perfect for industrial installations with large diameter cables in long span situations, minimizing total tray width and creating a smooth transition between straight sections and fittings. A structural offset in the sidewall creates strong, mid-span splices that need fewer supports. Each splice snaps in place and stays without holding. Additionally, only four bolts are needed for each splice reducing hardware needs by 50%. These features allow Itray to be installed up to 30% faster than standard tray.

## Features & Benefits

Material: Aluminum Alloy 5052 - H32

Finish: Plain

Height (H): Tray height: 4", 5", 6", 7"

Torque: 19 - 25 ft-lbs

## Specifications

### General Info

Product Line	Cablofil	Finish	Aluminum
UPC Number	800388200548	Country Of Origin	Mexico
Application Sector	Commercial, Industrial	Type	Splicing

### Dimensions

Product Width US	3.25 in	Product Weight US	0.984 lb
Product Volume US	0.039 cu ft	Product Depth US	3.0 in
Product Height US	6.875 in		

### Trade Programs

BAA	Yes
-----	-----