

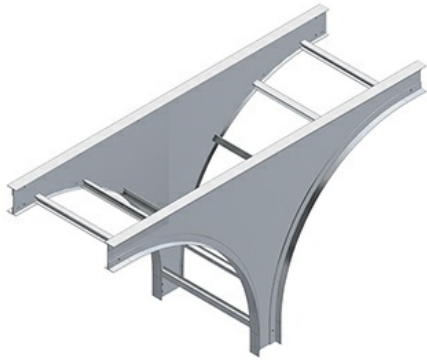

Cablofil  
SB-7A-TD24-24 AL 7H VERT TEE DWN 24R 24W  
Part No. P320137



Choose from an extensive selection of metallic ladder tray with a variety of rung and bottom styles to choose from. Finishes include steel, 304L and 316L stainless steel to meet the needs of any application. Rail heights range from 4" to 7" and width sizes are available up to 36".

## Features & Benefits

Includes 2 pairs of splices and hardware

## Specifications

### General Info

Product Line	Cablofil	Finish	AL
UPC Number	800388199668	Country Of Origin	Mexico

### Dimensions

Product Width US	25.5 in	Product Weight US	37.332 lb
Product Volume US	30.606 cu ft	Product Depth US	61.0 in
Product Height US	34.0 in		

### Buy American Act Compliance

BAA	Yes
-----	-----