

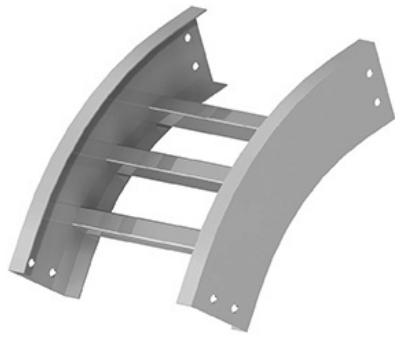

Cablofil  
LD-6L2I-4712-18 SS304 45° OVR 12"R 18"W  
Part No. P645336



Choose from an extensive selection of metallic ladder tray with a variety of rung and bottom styles to choose from. Finishes include steel, 304L and 316L stainless steel to meet the needs of any application. Rail heights range from 4" to 7" and width sizes are available up to 36".

## Features & Benefits

---

Includes splice plates

## Specifications

---

### General Info

---

Product Line	Cablofil	Finish	Aluminum
Country Of Origin	Mexico		

---

### Dimensions

---

Product Width US	6.0 in	Product Weight US	3.394 lb
Product Height US	4.0 in		

---