

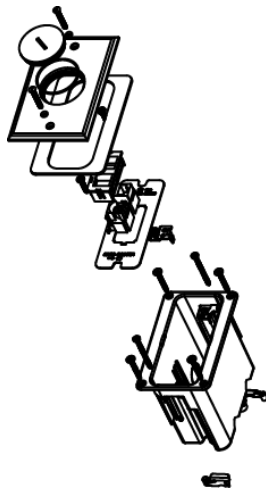

Wiremold  
WMFB1KS2B Series Single-Gang Floor Box Assembly  
Part No. WMFB1KS2B



Includes single-gang box, device plate with two openings for communication devices, and brass cover with one screw plug. For hole cut dimensions, see installation instructions sheet. Box Dimensions: 2 1/8" W x 3 3/4" L x 3 7/8" D (54mm W x 95mm L x 98mm D) Device Plate: 3 1/8" W x 4 15/16" L (79mm W x 125mm L).

## Features & Benefits

Includes single-gang box, device plate with two openings for communication devices, and brass cover with one screw plug. Box Dimensions: 2 1/8" W x 3 3/4" L x 3 7/8" D (54mm W x 95mm L x 98mm D) Device Plate: 3 1/8" W x 4 15/16" L (79mm W x 125mm L).

For hole cut dimensions, see installation instructions sheet.

## Specifications

### General Info

Product Line	Wiremold	UPC Number	786564053965
Country Of Origin	China	Construction	Not Assembled
Cover Style	Surface	Cover Material	Brass
Application Sector	Commercial, Residential	Standard	cULus Listed Nonmetallic Outlet Boxes: File E143222 Guide QCMZ. Meets Article 314.27(C) of NEC.
Warranty Type	1-Year from Installation or 2-Years from Day of Sale	Type	Floor Box

### Dimensions

Product Width US	2.125 in	Product Weight US	0.94 lb
Product Depth US	3.875 in	Knockout Size	1/2 in, 3/4 in

---

## Listing Agencies / 3rd Party Agencies

---

cULus Listed                      Yes

---

## Additional Information

---

RoHS Compliant                      Yes

---

## Technical Information

---

Floor Type                      Wood                                      Service Capacity                      Single

---

Minimum Floor Depth                      5 in                                      Box Capacity                      1 Gang

---

Cable Entry                      Through Floor                                      Box Type                      Recessed

---

Depth Behind Device Plates                      3.87 in

---