

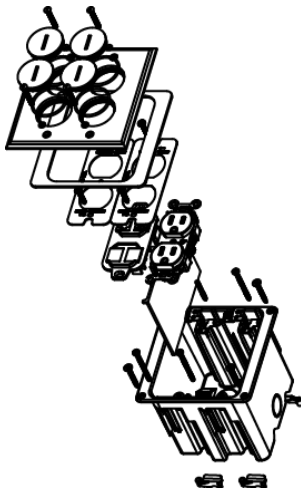

Wiremold  
WMFB2DRKS4B Series Dual-Gang Floor Box Assembly  
Part No. WMFB2DRKS4B



Includes dual-gang box, one 15A tamper-resistant duplex receptacle, 106 adapter with four openings for communication devices, and brass cover with four screw plugs. For hole cut dimensions, see installation instructions sheet. Box Dimensions: 3 1/4" W x 3 3/4" L x 3 7/8" D [83mm W x 95mm L x 98mm D] Device Plate: 4 7/8" W x 5 1/16" L [124mm W x 129mm L].

## Features & Benefits

Includes dual-gang box, one 15A tamper-resistant duplex receptacle, 106 adapter with four openings for communication devices, and brass cover with four screw plugs. For hole cut dimensions, see installation instructions sheet. Box Dimensions: 3 1/4" W x 3 3/4" L x 3 7/8" D [83mm W x 95mm L x 98mm D] Device Plate: 4 7/8" W x 5 1/16" L [124mm W x 129mm L].

## Specifications

### General Info

Product Line	Wiremold	UPC Number	786564054023
Country Of Origin	China	Construction	Not Assembled
Application Sector	Residential/Commercial	Standard	cULus Listed Nonmetallic Outlet Boxes: File E143222 Guide QCMZ. Meets Article 314.27(C) of NEC.
Type	Floor Box		

### Dimensions

Product Width US	3.25 in	Product Depth US	3.875 in
------------------	---------	------------------	----------

### Listing Agencies / 3rd Party Agencies

cULus ListingNumber	E143222	cULus Listed	Yes
---------------------	---------	--------------	-----

### Additional Information

---

RoHS Conformant                      Yes

---

**Technical Information**

---

Cable Entry                      Through Floor                      Number of Outlets    2

---