

1. Introduction

The On-Q/Legrand Custom Door (see **Figure 1**) is an attractive option to enhance the appearance of the On-Q Enclosure. Custom doors are available for On-Q 28" and 42" Enclosures. The Custom Door is available in variety of frame finishes and insert colors. The Custom Door can be mounted directly to an On-Q Enclosure or the On-Q Enclosure Extender. The door can be mounted on the left or right hand opening on the Enclosure Extender, however, it only mounts on left side of the On-Q Enclosures.

The 28-inch Custom Door is P/N 364593-xy, the 42 inch Custom Door is P/N 364594-xy.

Note: The part number suffix "-xy" varies based on ordering options, see description.

2. Description

The Custom Door is an aluminum frame with an insert. The frame is available in two finishes, brushed aluminum (P/N suffix "-1y") and white (P/N suffix "-2y"). Available inserts are, clear (P/N "-x1") and smoke (P/N suffix "-x4"). The doors all include an installed lock. The Custom door comes preassembled with a mounting kit. Doors ship with a protective cover over the inserts.

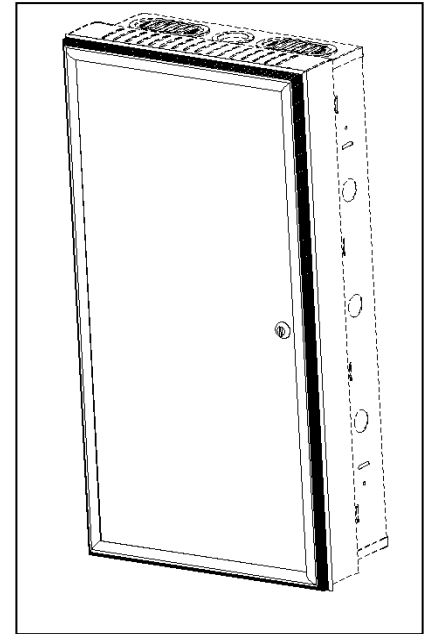

Figure 1

3. Installation

- A. Select right or left hand opening.
- B. Partially install a screw and lock washer into the top-mounting hole on the Enclosure or Extender.
- C. Align and hang the door on the hole by slipping the top hinge keyhole over the screw (see **Figure 2**).
- D. Align the door and install remaining screws. Tighten all screws.
- E. Remove insert protective cover by peeling back paper film on both sides of insert.

Note: It is advisable to leave the protective cover on until construction is complete.

Note: Acrylic inserts are soft plastic. Use mild plastic cleaner and soft cloth. Many glass cleaners contain abrasives, which will scratch and dull the finish.

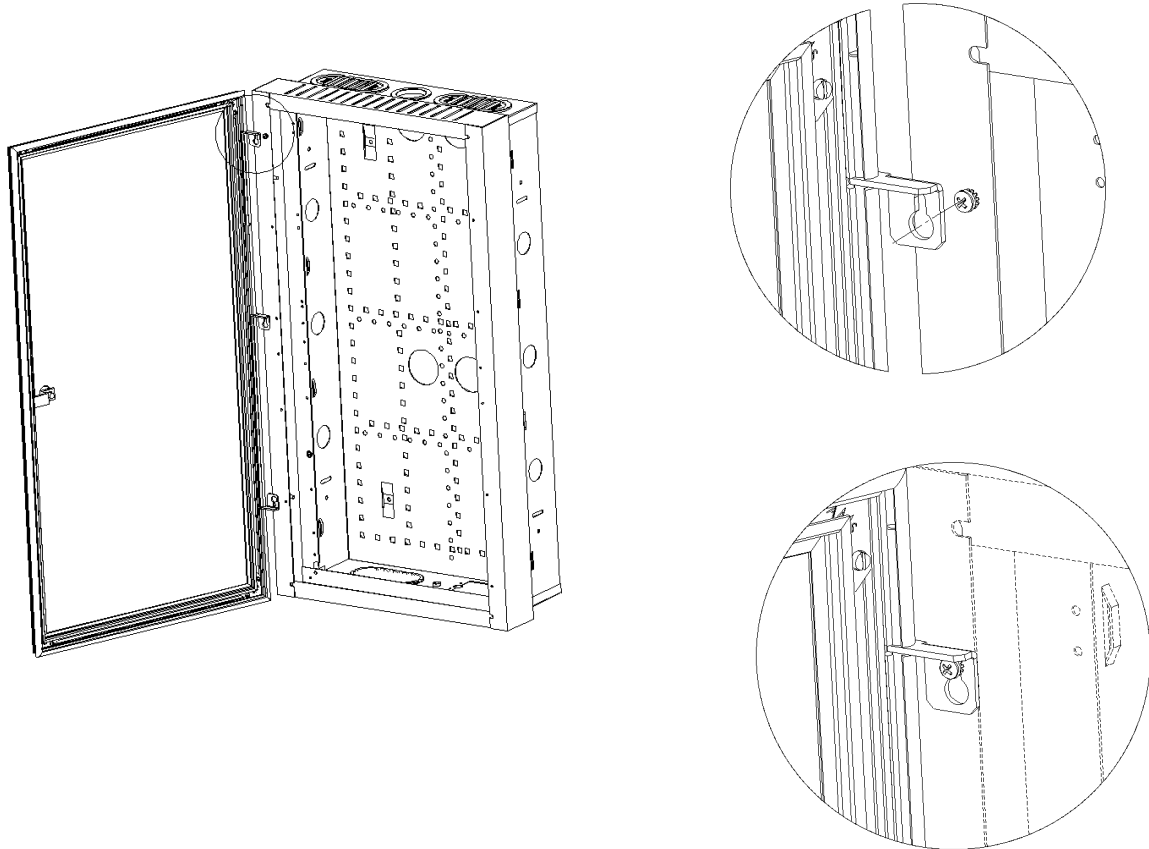

Figure 2