

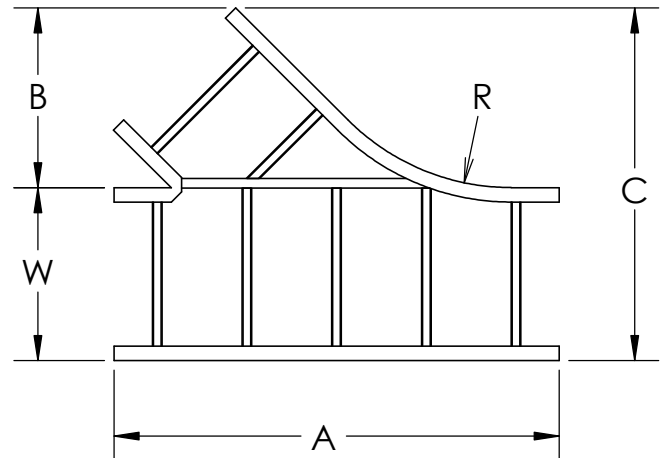

PW Steel Ladder Cable Tray Horizontal Fitting

WYE Horizontal Wye Right Hand

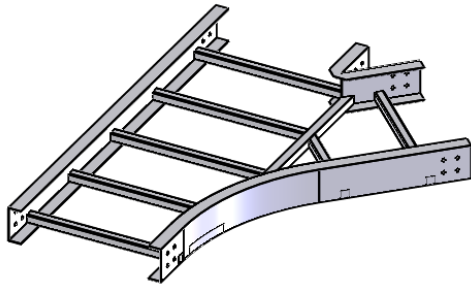

HORIZONTAL WYE BRANCH CATALOG NUMBERING EXAMPLE							
FITTING							
SYSTEM NO. PRODUCT NO.							
BOTTOM TYPE	LD - 4G2I - 4124 - 18						WIDTH
VENTED							06 - 6"
LD - Ladder							09 - 9"
VC! - Vented Corrugated							12 - 12"
NON-VENTED							18 - 18"
SC! - Solid Corrugated							24 - 24"
SF! - Solid Flat Bottom							30 - 30"
I Available for flange in only							36 - 36"
VC/SC Available in steel only							
SF Available in stainless steel only							
	SIDE RAIL	MATERIAL	FITTING	FLANGE	SERIES	DIRECTION	
		G		I - Flange In	1 - SERIES 1		
		L		O - Flange Out	2 - SERIES 2		
	HEIGHT						
	4 - 4"						
	5 - 5"						
	6 - 6"						
	7 - 7"						

MATERIAL: STEEL/STAINLESS STEEL

FINISH SUFFIX:

G: HOT DIP GALVANIZED STEEL PER ASTM A123

L: 304 STAINLESS STEEL PER ASTM A-240

T: 316 STAINLESS STEEL PER ASTM A-240

BOTTOM: LD - LADDER

VC - VENTED CORRUGATED

SC - SOLID CORRUGATED

SF - SOLID FLAT BOTTOM

Construction: Welded

Tray Design: Tray constructed and markings are per the latest addition of NEMA Standards Publication VE1, CSA C22.2 No. 126

Connectors: All fittings are supplied with necessary connectors and fasteners

Fitting Heights (H): 4", 5", 6", 7"

Tangents: Series 1 fittings have a 2" tangent
Series 2 fittings have a 5" tangent

W	PRODUCT NUMBER		SERIES 1			SERIES 2		
		RH RADIUS (IN.)	A	B	C	A	B	C
6		4124 24"	26 ³ / ₈	10 ¹ / ₄	16 ¹ / ₄	29 ³ / ₈	10 ¹ / ₄	16 ¹ / ₄
9			30 ³ / ₈	12 ³ / ₈	21 ³ / ₈	33 ³ / ₈	12 ³ / ₈	21 ³ / ₈
12			34 ³ / ₈	14 ¹ / ₂	26 ¹ / ₂	37 ³ / ₈	14 ¹ / ₂	26 ¹ / ₂
18			43 ³ / ₈	18 ³ / ₄	36 ³ / ₄	46 ³ / ₈	18 ³ / ₄	36 ³ / ₄
24			51 ⁷ / ₈	23	47	54 ⁷ / ₈	23	47
30			60 ³ / ₈	27 ¹ / ₄	57 ¹ / ₄	63 ³ / ₈	27 ¹ / ₄	57 ¹ / ₄
36			68 ⁷ / ₈	31 ¹ / ₂	67 ¹ / ₂	71 ⁷ / ₈	31 ¹ / ₂	67 ¹ / ₂

"Copyright LNA, Inc. Drawings are proprietary and may not be copied or otherwise duplicated or used without express written permission."

CABCS1521

Legrand
8319 State Rt. 4
Mascoutah, IL 62258 USA
800-658-4641
618-566-3250
Fax 618-566-4978
www.legrand.us/cablofil