

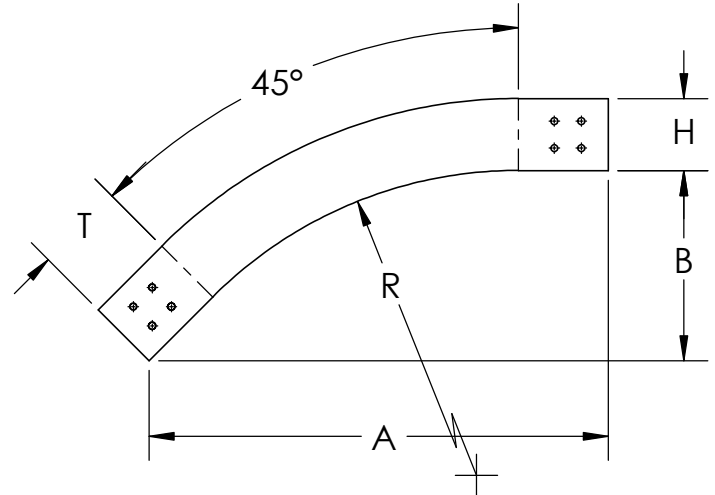

PW Steel Ladder Cable Tray Vertical Fitting

45VO Vertical Outside 45° Elbow

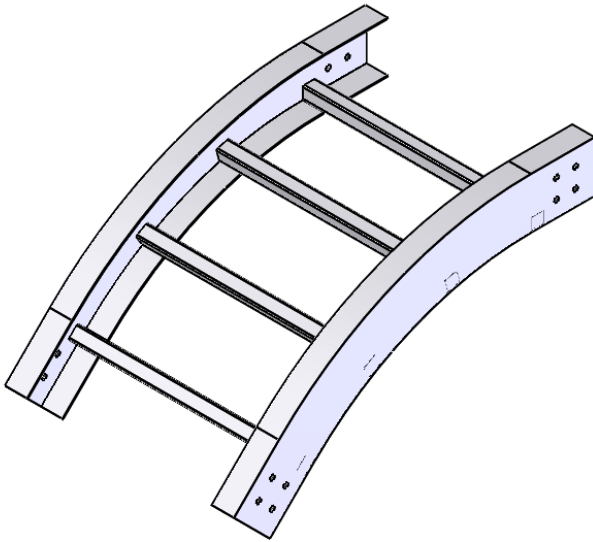

MATERIAL: STEEL/STAINLESS STEEL

FINISH SUFFIX:

G: HOT DIP GALVANIZED STEEL PER ASTM A123

L: 304 STAINLESS STEEL PER ASTM A-240

T: 316 STAINLESS STEEL PER ASTM A-240

BOTTOM: LD - LADDER

VC - VENTED CORRUGATED

SC - SOLID CORRUGATED

SF - SOLID FLAT BOTTOM

Construction: Welded

Tray Design: Tray constructed and markings are per the latest addition of NEMA Standards Publication VE1, CSA C22.2 No. 126

Connectors: All fittings are supplied with necessary connectors and fasteners

Fitting Heights (H): 4", 5", 6", 7"

Tangents: Series 1 fittings have a 2" tangent
Series 2 fittings have a 5" tangent

RAIL HEIGHT (IN.) >		4, 5, 6, 7				
PRODUCT NUMBER	RADIUS (IN.)	SERIES 1		SERIES 2		
		A	B	A	B	
4712	12"	ALL	12	5	17 ¹ / ₈	7 ¹ / ₈
4724	24"	ALL	20 ¹ / ₂	8 ¹ / ₂	25 ⁵ / ₈	10 ⁵ / ₈
4736	36"	ALL	28 ⁷ / ₈	12	34	14 ¹ / ₈

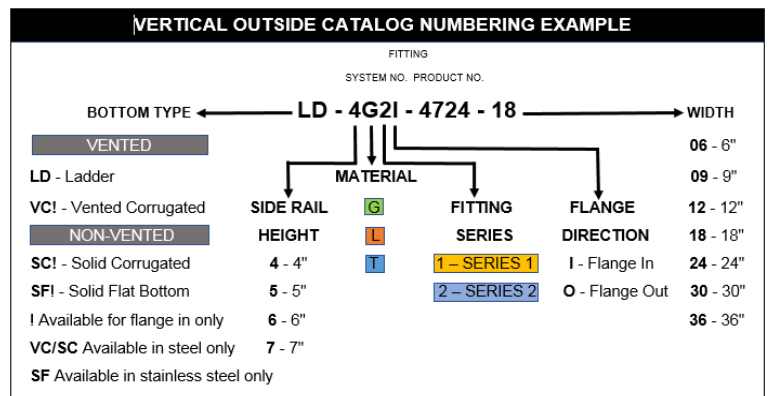

"Copyright LNA, Inc. Drawings are proprietary and may not be copied or otherwise duplicated or used without express written permission."

CABCS1509

Legrand
8319 State Rt. 4
Mascoutah, IL 62258 USA
800-658-4641
618-566-3250
Fax 618-566-4978
www.legrand.us/cablofil