

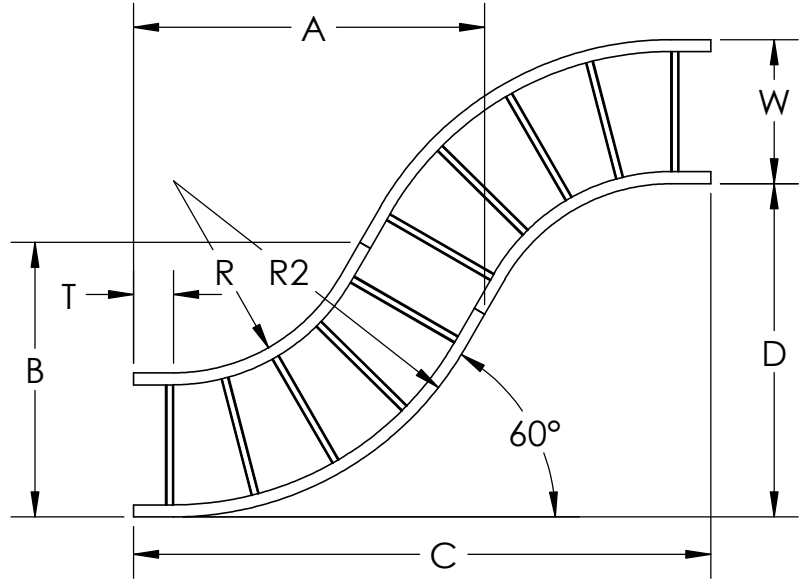

# PW Steel Ladder Cable Tray Horizontal Fitting

## 60HB Horizontal 60° Elbow

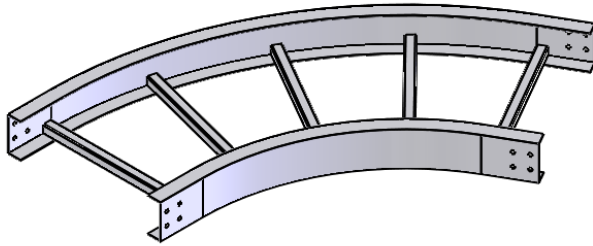

HORIZONTAL ELBOW CATALOG NUMBERING EXAMPLE				
FITTING				
SYSTEM NO. PRODUCT NO.				
BOTTOM TYPE	LD - 4G2I - 6024 - 18			WIDTH
VENTED				06 - 6"
LD - Ladder				09 - 9"
VC1 - Vented Corrugated	SIDE RAIL	G	FITTING	12 - 12"
NON-VENTED	HEIGHT	L	SERIES	18 - 18"
SC1 - Solid Corrugated	4 - 4"	T	1 - SERIES 1	I - Flange In 24 - 24"
SF1 - Solid Flat Bottom	5 - 5"		2 - SERIES 2	O - Flange Out 30 - 30"
! Available for flange in only	6 - 6"			36 - 36"
VC/SC Available in steel only	7 - 7"			
SF Available in stainless steel only				

**MATERIAL:** STEEL/STAINLESS STEEL

**FINISH SUFFIX:**

**G:** HOT DIP GALVANIZED STEEL PER ASTM A123

**L:** 304 STAINLESS STEEL PER ASTM A-240

**T:** 316 STAINLESS STEEL PER ASTM A-240

**BOTTOM:** LD - LADDER

VC - VENTED CORRUGATED

SC - SOLID CORRUGATED

SF - SOLID FLAT BOTTOM

**Construction:** Welded

**Tray Design:** Tray constructed and markings are per the latest addition of NEMA Standards Publication VE1, CSA C22.2 No. 126

**Connectors:** All fittings are supplied with necessary connectors and fasteners

**Fitting Heights (H):** 4", 5", 6", 7"

**Tangents:** Series 1 fittings have a 2" tangent  
Series 2 fittings have a 5" tangent

PRODUCT NUMBER RADIUS (IN.)	W	R2	SERIES1				SERIES2			
			A	B	C	D	A	B	C	D
6012 12"	6	18	18 <sup>3</sup> / <sub>8</sub>	13 <sup>1</sup> / <sub>8</sub>	32	18 <sup>1</sup> / <sub>2</sub>	23 <sup>1</sup> / <sub>8</sub>	16 <sup>1</sup> / <sub>8</sub>	41	23 <sup>3</sup> / <sub>8</sub>
	9	21	21 <sup>1</sup> / <sub>8</sub>	16 <sup>3</sup> / <sub>8</sub>	34 <sup>5</sup> / <sub>8</sub>	20	25 <sup>5</sup> / <sub>8</sub>	19 <sup>3</sup> / <sub>8</sub>	43 <sup>1</sup> / <sub>2</sub>	25 <sup>1</sup> / <sub>8</sub>
	12	24	23 <sup>3</sup> / <sub>8</sub>	19 <sup>3</sup> / <sub>8</sub>	37 <sup>1</sup> / <sub>8</sub>	21 <sup>1</sup> / <sub>2</sub>	28 <sup>3</sup> / <sub>8</sub>	22 <sup>3</sup> / <sub>8</sub>	46 <sup>1</sup> / <sub>8</sub>	26 <sup>3</sup> / <sub>8</sub>
	18	30	29	25 <sup>1</sup> / <sub>2</sub>	42 <sup>2</sup> / <sub>8</sub>	24 <sup>1</sup> / <sub>2</sub>	33 <sup>1</sup> / <sub>2</sub>	28 <sup>3</sup> / <sub>8</sub>	51 <sup>3</sup> / <sub>8</sub>	29 <sup>3</sup> / <sub>8</sub>
	24	36	34 <sup>1</sup> / <sub>8</sub>	31 <sup>1</sup> / <sub>8</sub>	47 <sup>1</sup> / <sub>2</sub>	27 <sup>1</sup> / <sub>2</sub>	38 <sup>3</sup> / <sub>8</sub>	34 <sup>3</sup> / <sub>8</sub>	56 <sup>1</sup> / <sub>2</sub>	32 <sup>3</sup> / <sub>8</sub>
	30	42	39 <sup>3</sup> / <sub>8</sub>	37 <sup>3</sup> / <sub>8</sub>	52 <sup>2</sup> / <sub>8</sub>	30 <sup>1</sup> / <sub>2</sub>	43 <sup>3</sup> / <sub>8</sub>	40 <sup>3</sup> / <sub>8</sub>	61 <sup>3</sup> / <sub>8</sub>	35 <sup>3</sup> / <sub>8</sub>
6024 24"	6	48	44 <sup>1</sup> / <sub>2</sub>	43 <sup>3</sup> / <sub>8</sub>	57 <sup>1</sup> / <sub>8</sub>	33 <sup>1</sup> / <sub>2</sub>	49	46 <sup>3</sup> / <sub>8</sub>	66 <sup>7</sup> / <sub>8</sub>	38 <sup>3</sup> / <sub>8</sub>
	9	30	29	19 <sup>3</sup> / <sub>8</sub>	52 <sup>2</sup> / <sub>8</sub>	30 <sup>1</sup> / <sub>2</sub>	33 <sup>1</sup> / <sub>2</sub>	22 <sup>3</sup> / <sub>8</sub>	61 <sup>3</sup> / <sub>8</sub>	35 <sup>3</sup> / <sub>8</sub>
	9	33	31 <sup>3</sup> / <sub>8</sub>	22 <sup>3</sup> / <sub>8</sub>	55 <sup>3</sup> / <sub>8</sub>	32	36 <sup>1</sup> / <sub>2</sub>	25 <sup>3</sup> / <sub>8</sub>	64 <sup>3</sup> / <sub>8</sub>	37 <sup>1</sup> / <sub>8</sub>
	12	36	34 <sup>1</sup> / <sub>8</sub>	25 <sup>3</sup> / <sub>8</sub>	57 <sup>3</sup> / <sub>8</sub>	33 <sup>1</sup> / <sub>2</sub>	38 <sup>3</sup> / <sub>8</sub>	28 <sup>3</sup> / <sub>8</sub>	67	38 <sup>3</sup> / <sub>8</sub>
	18	42	39 <sup>3</sup> / <sub>8</sub>	31 <sup>3</sup> / <sub>8</sub>	63 <sup>1</sup> / <sub>8</sub>	36 <sup>1</sup> / <sub>2</sub>	43 <sup>3</sup> / <sub>8</sub>	34 <sup>3</sup> / <sub>8</sub>	72 <sup>1</sup> / <sub>8</sub>	41 <sup>3</sup> / <sub>8</sub>
	24	48	44 <sup>1</sup> / <sub>2</sub>	37 <sup>3</sup> / <sub>8</sub>	68 <sup>1</sup> / <sub>8</sub>	39 <sup>1</sup> / <sub>2</sub>	49 <sup>3</sup> / <sub>8</sub>	40 <sup>3</sup> / <sub>8</sub>	77 <sup>3</sup> / <sub>8</sub>	44 <sup>3</sup> / <sub>8</sub>
6036 36"	30	54	49 <sup>3</sup> / <sub>8</sub>	43 <sup>3</sup> / <sub>8</sub>	73 <sup>1</sup> / <sub>2</sub>	42 <sup>1</sup> / <sub>2</sub>	54 <sup>1</sup> / <sub>2</sub>	46 <sup>3</sup> / <sub>8</sub>	82 <sup>3</sup> / <sub>8</sub>	47 <sup>3</sup> / <sub>8</sub>
	36	60	54 <sup>7</sup> / <sub>8</sub>	49 <sup>3</sup> / <sub>8</sub>	78 <sup>5</sup> / <sub>8</sub>	45 <sup>1</sup> / <sub>2</sub>	59 <sup>3</sup> / <sub>8</sub>	52 <sup>3</sup> / <sub>8</sub>	87 <sup>3</sup> / <sub>8</sub>	50 <sup>3</sup> / <sub>8</sub>
	6	42	39 <sup>3</sup> / <sub>8</sub>	25 <sup>3</sup> / <sub>8</sub>	73 <sup>1</sup> / <sub>2</sub>	42 <sup>1</sup> / <sub>2</sub>	43 <sup>3</sup> / <sub>8</sub>	28 <sup>3</sup> / <sub>8</sub>	82 <sup>1</sup> / <sub>2</sub>	47 <sup>3</sup> / <sub>8</sub>
	9	45	42	28 <sup>3</sup> / <sub>8</sub>	76 <sup>1</sup> / <sub>8</sub>	44	46 <sup>1</sup> / <sub>2</sub>	31 <sup>3</sup> / <sub>8</sub>	85 <sup>1</sup> / <sub>8</sub>	49 <sup>1</sup> / <sub>8</sub>
	12	48	44 <sup>1</sup> / <sub>2</sub>	31 <sup>3</sup> / <sub>8</sub>	78 <sup>5</sup> / <sub>8</sub>	45 <sup>1</sup> / <sub>2</sub>	49 <sup>1</sup> / <sub>2</sub>	34 <sup>3</sup> / <sub>8</sub>	87 <sup>3</sup> / <sub>8</sub>	50 <sup>3</sup> / <sub>8</sub>
	18	54	49 <sup>3</sup> / <sub>8</sub>	37 <sup>3</sup> / <sub>8</sub>	83 <sup>3</sup> / <sub>8</sub>	48 <sup>1</sup> / <sub>2</sub>	54 <sup>1</sup> / <sub>2</sub>	40 <sup>3</sup> / <sub>8</sub>	92 <sup>1</sup> / <sub>8</sub>	53 <sup>3</sup> / <sub>8</sub>
6036 36"	24	60	54 <sup>7</sup> / <sub>8</sub>	43 <sup>3</sup> / <sub>8</sub>	89	51 <sup>1</sup> / <sub>2</sub>	59 <sup>1</sup> / <sub>2</sub>	46 <sup>3</sup> / <sub>8</sub>	98 <sup>1</sup> / <sub>8</sub>	56 <sup>3</sup> / <sub>8</sub>
	30	66	60 <sup>1</sup> / <sub>8</sub>	49 <sup>3</sup> / <sub>8</sub>	94 <sup>1</sup> / <sub>8</sub>	54 <sup>1</sup> / <sub>2</sub>	64 <sup>3</sup> / <sub>8</sub>	52 <sup>3</sup> / <sub>8</sub>	103 <sup>3</sup> / <sub>8</sub>	59 <sup>3</sup> / <sub>8</sub>
	36	72	65 <sup>1</sup> / <sub>8</sub>	55 <sup>3</sup> / <sub>8</sub>	99 <sup>3</sup> / <sub>8</sub>	57 <sup>1</sup> / <sub>2</sub>	69 <sup>3</sup> / <sub>8</sub>	58 <sup>3</sup> / <sub>8</sub>	108 <sup>1</sup> / <sub>2</sub>	62 <sup>3</sup> / <sub>8</sub>

"Copyright LNA, Inc. Drawings are proprietary and may not be copied or otherwise duplicated or used without express written permission."

CABCS1502

Legrand  
8319 State Rt. 4  
Mascoutah, IL 62258 USA  
800-658-4641  
618-566-3250  
Fax 618-566-4978  
www.legrand.us/cablofil